

Compression Strut Kit

Chevy/GMC 1500 | 2019-2026

Part #: BDS121664 -BDS121665

Rev. 091025



491 W. Garfield Ave., Coldwater, MI 49036 • Phone: 517-279-2135

Web: www.bds-suspension.com • E-mail: tech-bds@ridefox.com

SAFETY WARNING

BDS Suspension Co. recommends this system be installed by a professional technician. In addition to these instructions, professional knowledge of disassembly/ reassembly procedures and post installation checks must be known.

INSTALLATION INSTRUCTIONS

1. Remove the sway bar from the vehicle. Mark orientation of the sway bar. Mark the position of the sway bar bushing relative to the sway bar for the chance that the bushing may fall off or move during the installation.
2. Remove both sway bar end links.
3. Feed the sway bar through the compression strut. Compression struts are side specific, see Figure 1 below.

FIGURE 1



4. Line up the holes in the sway bar drop bracket with the holes in the compression strut and the holes in the sway bar bracket. Make sure the bushing is located in the correct position as it was marked earlier.

FIGURE 2 - SHOWN WITH HARDWARE INSTALLED

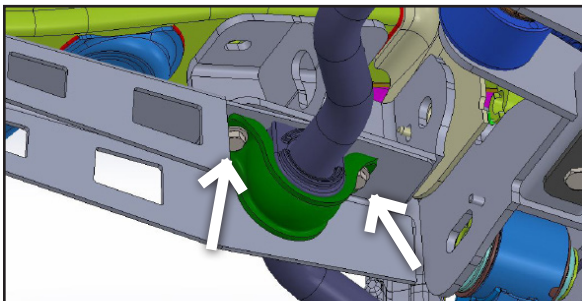

5. Install the compression strut / sway bar assembly together frame with the original hardware for the sway bar. Leave hardware loose.
6. Install the nut tab into the frame. The nut tabs are side specific with the shorter nut tab used on the driver side and the longer nut tab used on the passenger side.

FIGURE 3

Box Kit		
Part #	Qty	Description
03721	1	Compression Strut - DRV
03722	1	Compression Strut - PASS
03726	1	Nut Tab - DRV
03727	1	Nut Tab - PASS
407	1	Bolt Pack
	8	3/8" USS Washer Thru-Hardened
	4	7/16"-14 x 1-1/4" Bolt Grade 8
	4	7/16"-14 Prevailing Torque Nut*

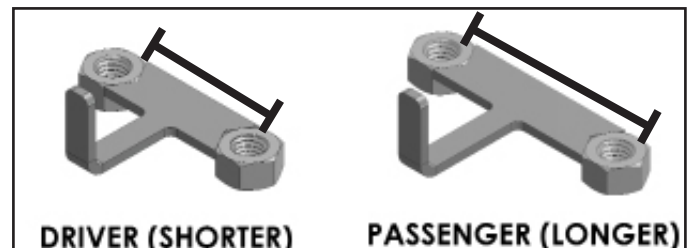

7. Loosely attach the compression strut to the nut tab with the provided 7/16" bolts and washers through the hole and slot in the frame.

FIGURE 4

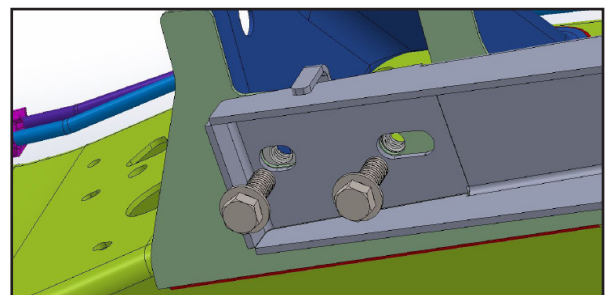

8. Tighten the 3/8" sway bar hardware to 30 ft-lbs.
9. Tighten the 7/16" compression strut hardware to 45 ft-lbs.

*There will be 4 washers and 4 nuts remaining after installation