

# FITTING INSTRUCTIONS

## BP5160033

### TO SUIT JEEP WRANGLER JL 3"+ FRONT

### WARNING

- ◆ This product must be installed exactly as per these instructions using only the hardware supplied.
- ◆ In the event of damage to any suspension component, contact your nearest authorised ARB stockist. Repairs or modifications to the suspension system components must not be attempted.
- ◆ Do not use this product for any vehicle make or model, other than those specified by ARB.
- ◆ Do not remove labels from suspension components.
- ◆ This product or its fixing must not be modified in any way.
- ◆ The installation of this product may require the use of specialized tools and/or techniques
- ◆ It is recommended that this product is only installed by trained personnel
- ◆ These instructions are correct as at the publication date. ARB Corporation Ltd. cannot be held responsible for the impact of any changes subsequently made by the vehicle manufacturer
- ◆ During installation, it is the duty of the installer to check correct operation/clearances of all components
- ◆ Work safely at all times

**Note:** These fitting instructions should be read in conjunction with the vehicle workshop manual.

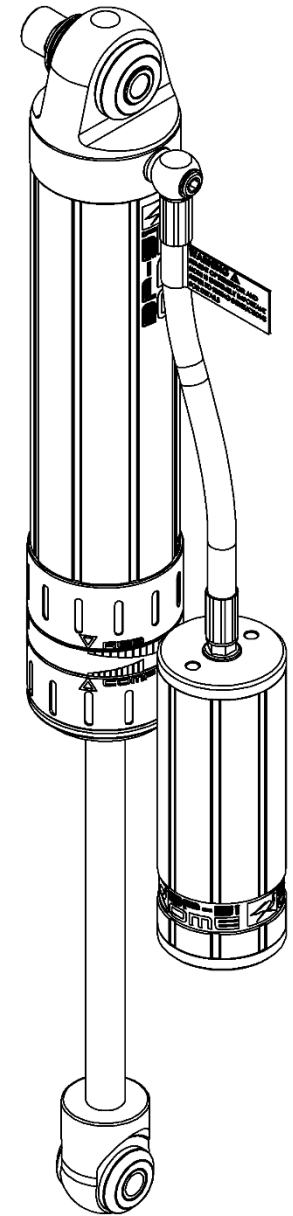

# WARNING

BP5160033 is designed to be used with OME 2.5" / 3.5" Lift Kit which addresses the following requirements with components described.

FEATURES	COMPONENT	OME PART NUMBERS		COMMENTS
		FRONT	REAR	
Lift	Springs	3133 / 3134 / 3135	3136 / 3137 / 3138 / 3139	2.5" / 3.5" lift coils are designed to stay located with longer dampers
Damping	Shocks Absorbers	BP5160033	BP5160034L / BP5160034R	Dampers with optimised lengths for maximum down travel
Bump Stops	Bump Stop Spacers Front and Rear	FK92		Bump stops spacers optimised for extended and compressed lengths to allow for maximum compression and rebound control. Also allows larger fitment of tyres 35-37" with OE Flare/Fender. Minimum FRONT bump spacer height 45mm (1.75").
Castor Correction	Adjustable Lower Control Arm	LCAJLFR		Heavy Duty Adjustable control arm to restore wheel alignment.
Roll Control / Articulation	Extended Sway Bar Links	FK93		New longer sway bar links to correct sway bar alignment and ensure droop travel is limited by the dampers.

**If not using the complete OME Lift Kit please ensure all the above features are considered.**

## FITTING KIT CONTENTS – VM80010038

Item	Description	Qty	Spare Part No.
1	FRONT RESI BRACKET RIGHT (SHOWN)	1	VE10020035RSP
	FRONT RESI BRACKET LEFT	1	VE10020035LSP
2	FRONT DAMPER LOWER MOUNT BRACKET	2	VF60050040SP
3	M12 X 1.75 X 90MM BOLT	2	6151250SP
4	M12 WASHER FLAT	4	4581011SP
5	M12 X 1.75 NYLOC NUT	2	6151574SP
6	MOUNT SLEEVE	2	VF50121640SP
7	ADJUSTER TOOL	1	VC10010071SP
8	RESERVOIR CLAMP	2	VE10010003SP
9	M6 X 16MM BOLT	4	VD60030003SP
10	M6 WASHER FLAT	4	VE70020005SP
11	M6 NYLOC NUT	4	VD60010003SP
12	M8 X 25MM BOLT	2	6151546SP
13	M8 WASHER FLAT	4	VE70020004SP
14	M8 NYLOC NUT	2	VD60010004SP
15	M10 X 100MM BOLT	2	6151299SP
16	M10 WASHER FLAT	4	4581040SP
17	M10 NYLOC NUT	2	6151322SP
18	FRONT RESI BRACKET SPACER	2	VF60050041SP

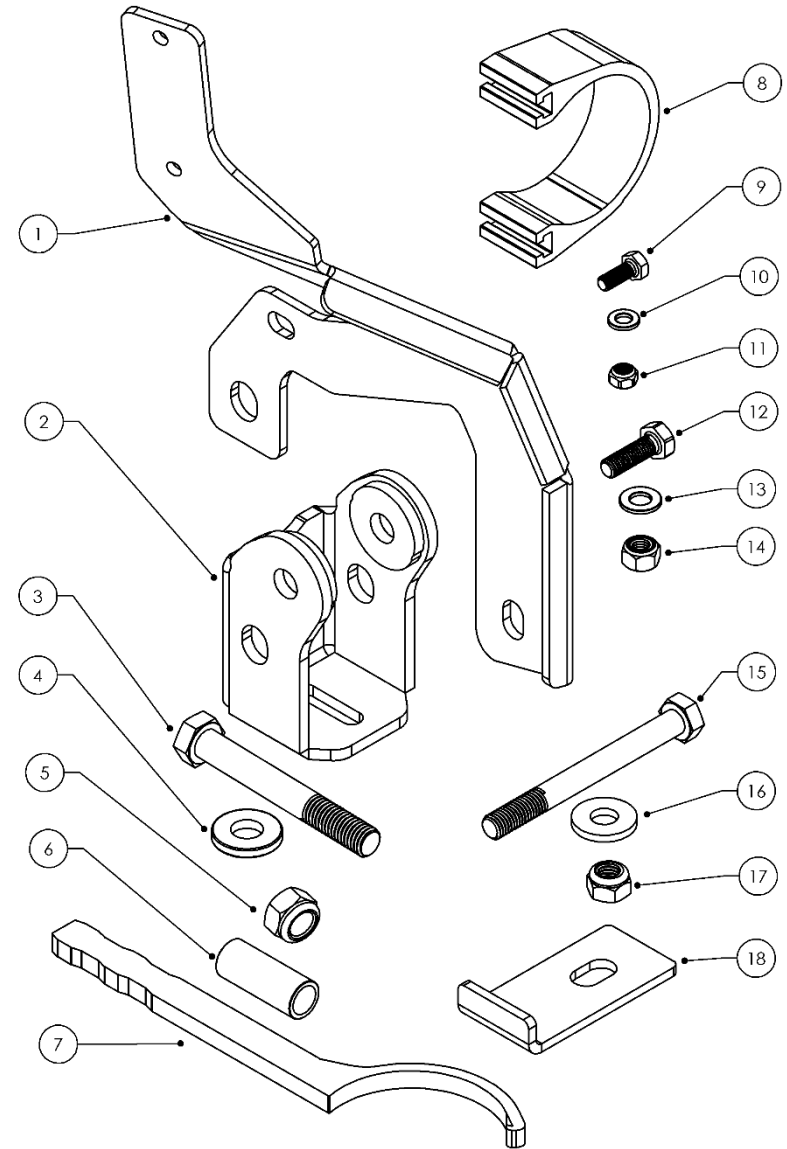

## VEHICLE PREPARATION

Remove existing dampers from the vehicle.  
Remove internal wheel arch liner from vehicle.

## DAMPER LOWER MOUNT BRACKET

Follow steps 1-3.

**1.** Fit the supplied damper mount bracket **VF60050040** to the lower OE mount using the supplied M8 fasteners as shown. Tighten the bolt until there is little movement for the bracket.

**2.** Align the hole on the bracket with the hole on the OE mount as shown in the picture. Securely tighten the M8 bolt once holes are aligned.

*Torque to 22 Nm (16 lbf ft).*

**3.** Fit the supplied M12 fasteners and the crush tube **VF50121640** to the bracket as shown. Secure fasteners finger tight only.

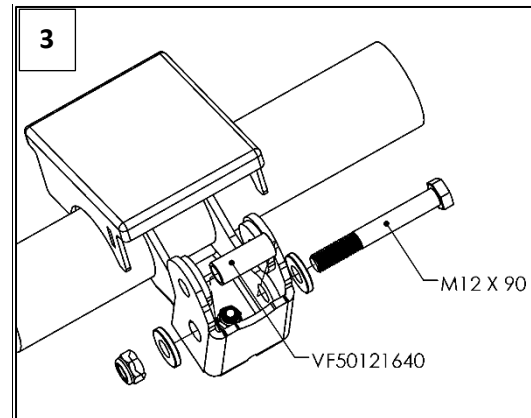
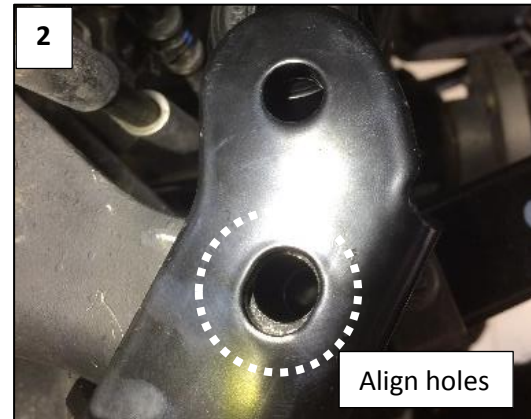
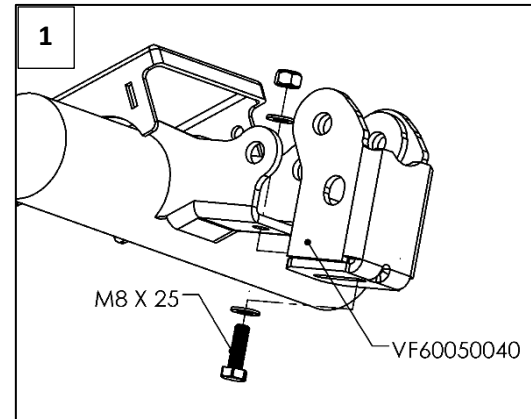

## DAMPER MOUNTING

The BP-51 needs to be fitted with the suspension in droop.

### TOP MOUNT

Fit the damper to vehicle top mount such that the hose fitting leaving the damper is pointing toward the outside of the vehicle as shown in the picture.

Reuse OE bolt.

**Torque (refer to Jeep JL workshop manual).**

### LOWER MOUNT

Fit the damper to the new lower mount reusing OE fasteners as shown. Finger tight only.

Securely tighten all fasteners in number sequence.

**M12 bolt supplied (1)**

**Torque to 103 Nm (76 lbf ft).**

**OE bolt (2)**

**Torque (refer to Jeep JL workshop manual).**

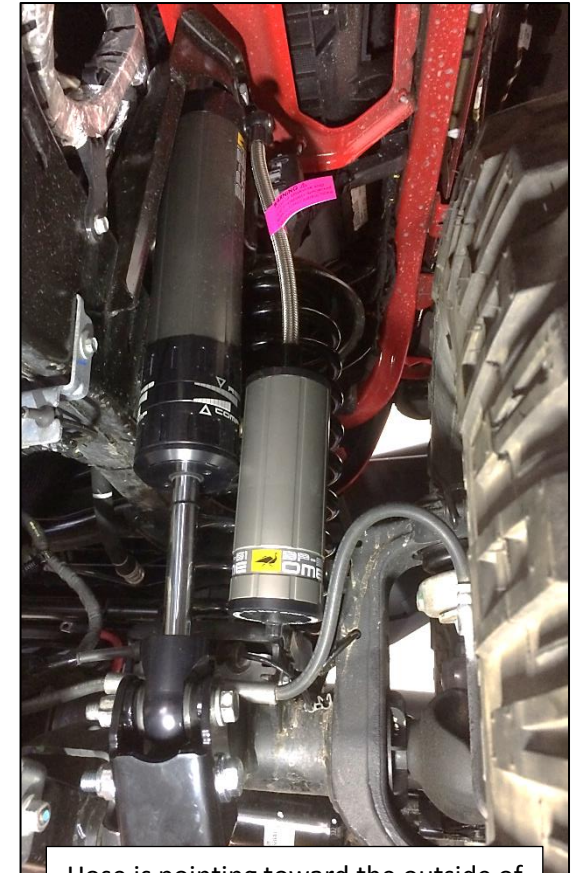
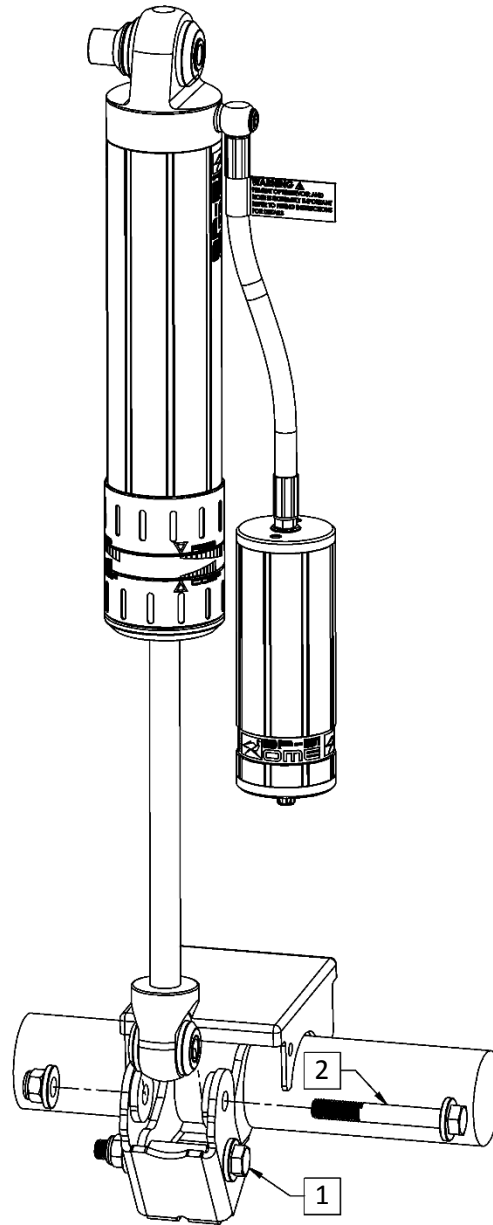

Hose is pointing toward the outside of the vehicle.

## RESERVOIR MOUNTING (RIGHT HAND SIDE)

Follow steps 1-4.

**1.** Pre-assemble the supplied M6 fasteners to the bracket as shown. Note washer on the nut side. Secure finger tight only.

**2.** Remove the M8 bolt (1) that secures the motor and use the other hole (2) to mount the reservoir bracket.

**3.** Fit the bracket to the vehicle in sequence as shown. Ensure the bracket is clear of the pump. Securely fasten all bolts.

*OE bolt.*

*Torque (refer to Jeep JL workshop manual).*

*Torque M10 bolt to 30 Nm (22 lbf ft).*

**4.** Refer to the picture for correct fitment.

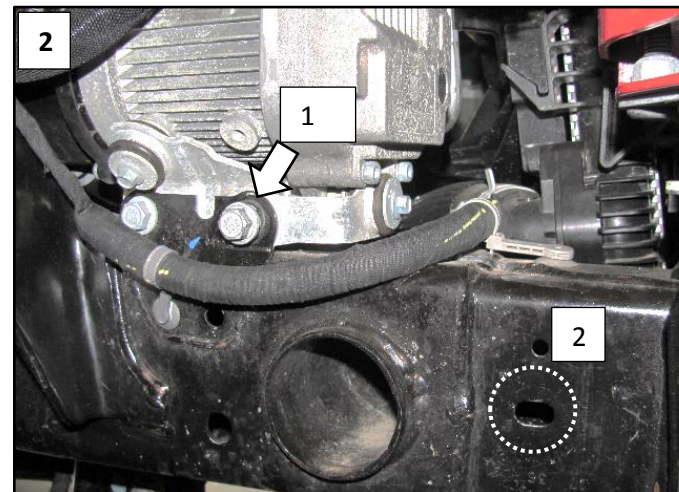
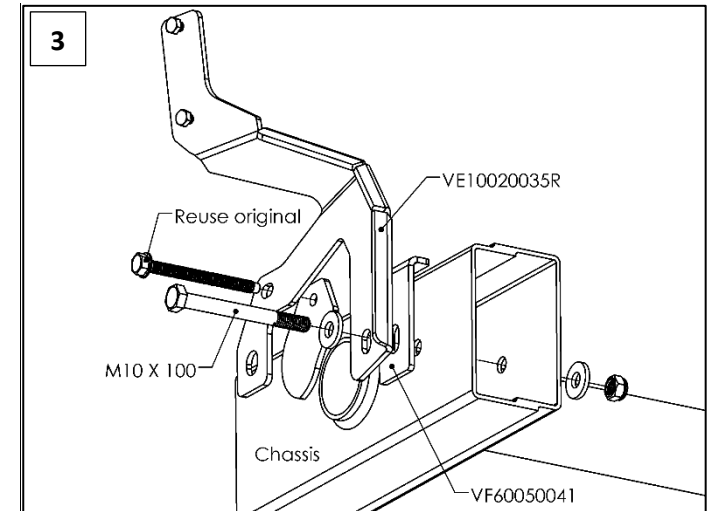
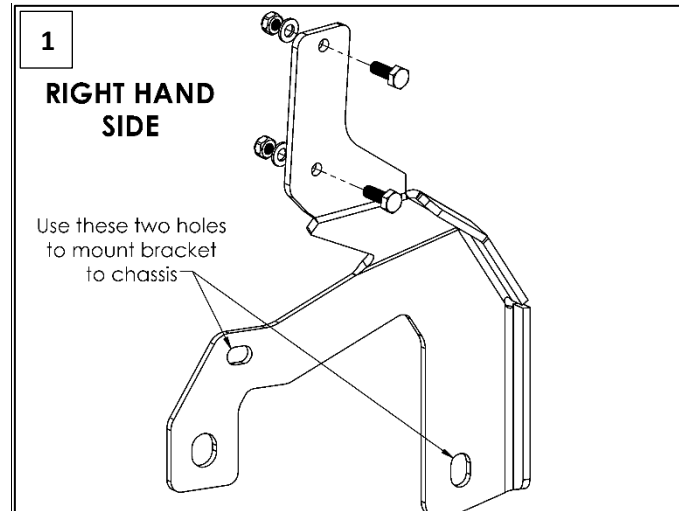



## RESERVOIR MOUNTING (RIGHT HAND SIDE) CONTINUED...

5. Fit the mounting saddle to the reservoir and slide over the heads of the bolts in the mounting bracket. Adjust the position of the reservoir as shown in the diagram. Rotate the reservoir slowly clockwise and push it toward the damper to achieve the position. Tighten the M6 nut securely.

**Torque to 12 Nm (9 lbf ft).**

Refer to the picture for correct fitment.

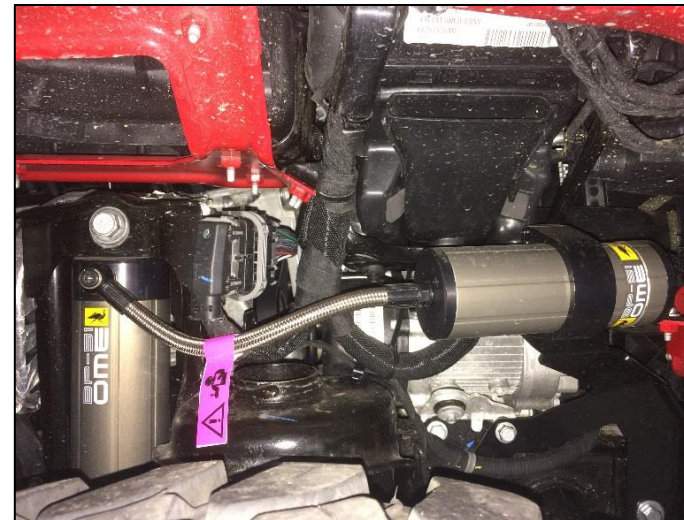
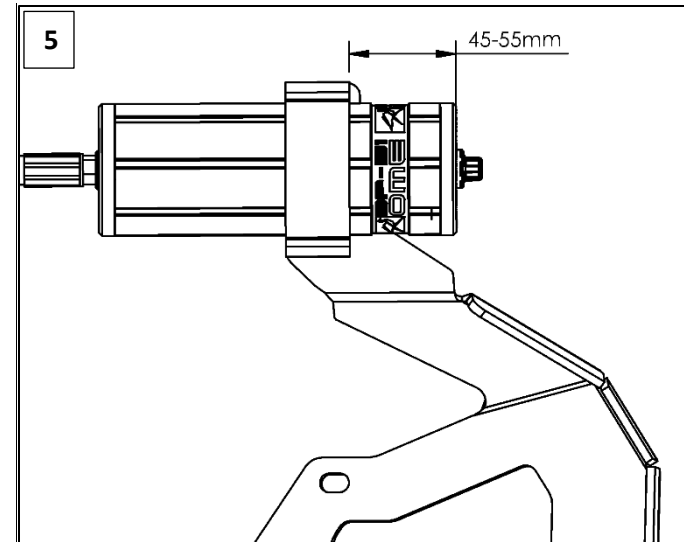

## RESERVOIR MOUNTING (LEFT HAND SIDE)

Follow steps 1-4.

1. Pre-assemble the supplied M6 fasteners to the bracket as shown. Secure finger tight only. Note washer on the nut side.

2. Remove the blot (1) that secures the steering box to the chassis and use the other hole (2) to mount the reservoir bracket.

3. Fit the bracket to the vehicle in sequence as shown. Securely tighten all bolts.

**OE bolt.**  
*Torque (refer to Jeep JL workshop manual).*

*Torque M10 bolt to 30 Nm (22 lbf ft).*

4. Refer to the picture for correct fitment.

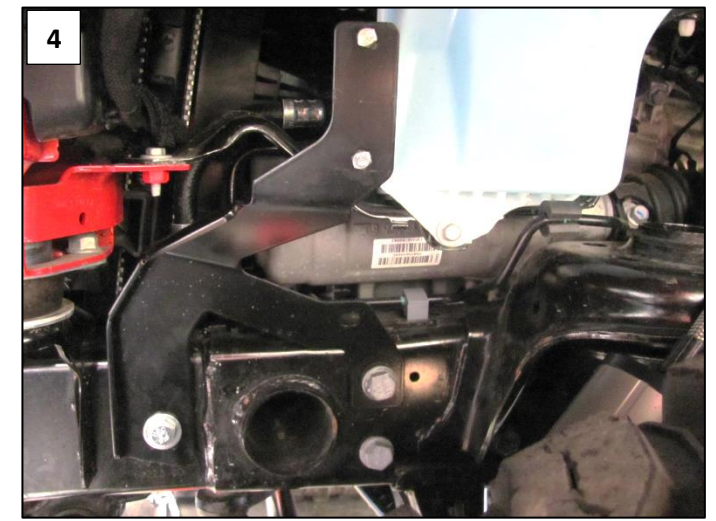
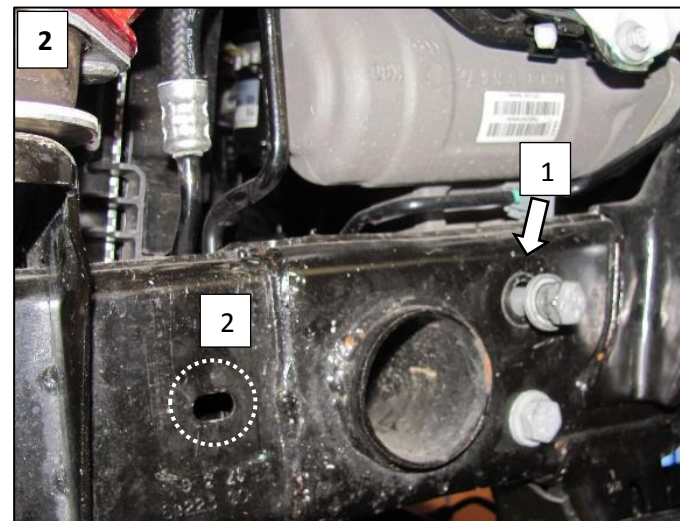
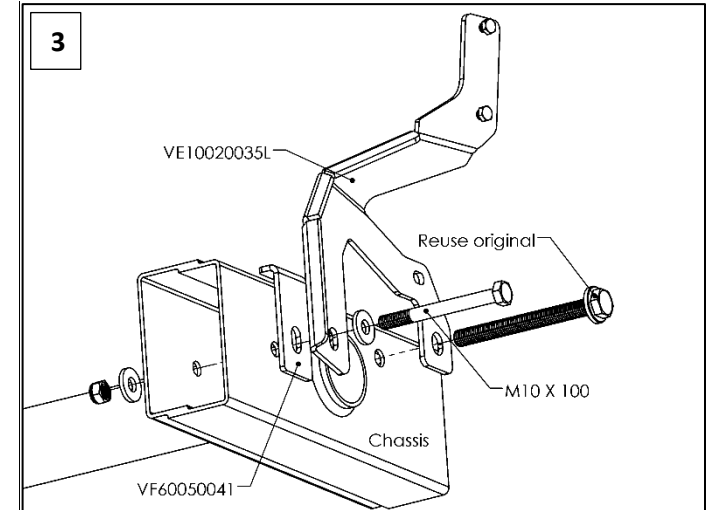
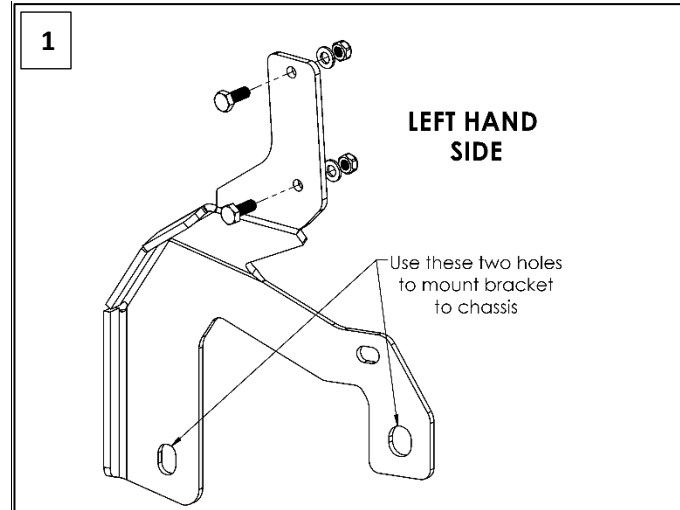



## RESERVOIR MOUNTING (LEFT HAND SIDE) CONTINUED...

5. Fit the mounting saddle to the reservoir and slide over the heads of the bolts in the mounting bracket. Adjust the position of the reservoir as shown in the diagram. Rotate the reservoir slowly and push it toward the damper to achieve the position. Tighten the M6 nut securely.

***Torque to 12 Nm (9 lbf ft).***

Refer to the picture for correct fitment.

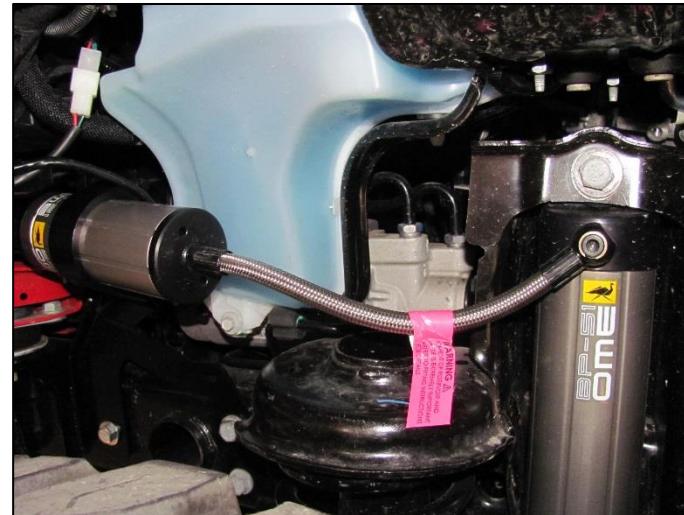
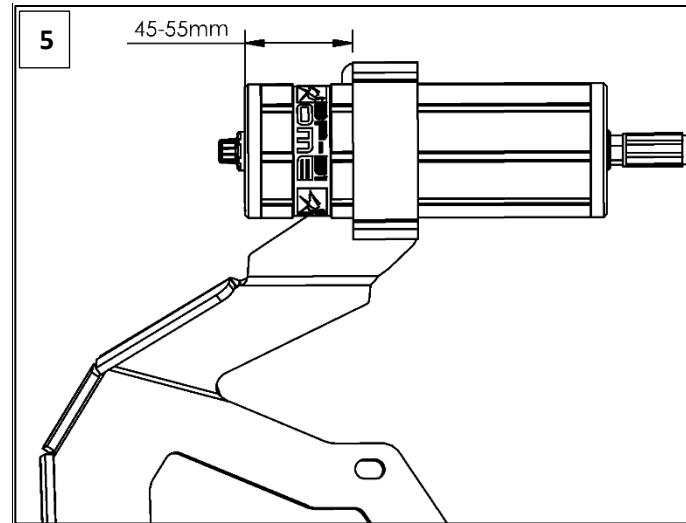

## RESERVOIR MOUNTING WHEEL ARCH PLASTIC TRIMMING

**This is a guide only. Care must be taken when following the steps below.**

With wheel arch liner removed, use a knife, a pair of straight tin snips, a marker and a 300mm rule to mark out and cut the plastic.

Follow the steps shown in the picture. Left and right are mirrored. (Right hand side shown).

1. Mark out lower line. Used the bottom of the liner as datum point.
  2. Mark out upper line and the line on the right hand side as shown.
  3. Mark out the profile shown.
  4. After marking out, start the cut in the centre of the mark out and remove a small amount of material at a time.
- See next page for further instruction...

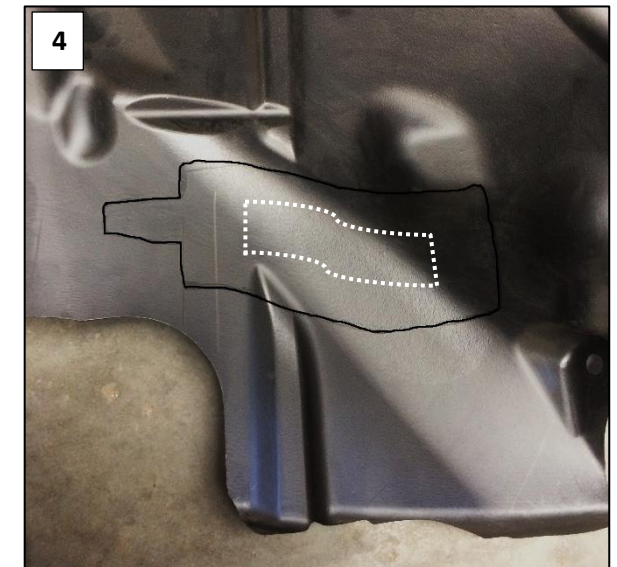
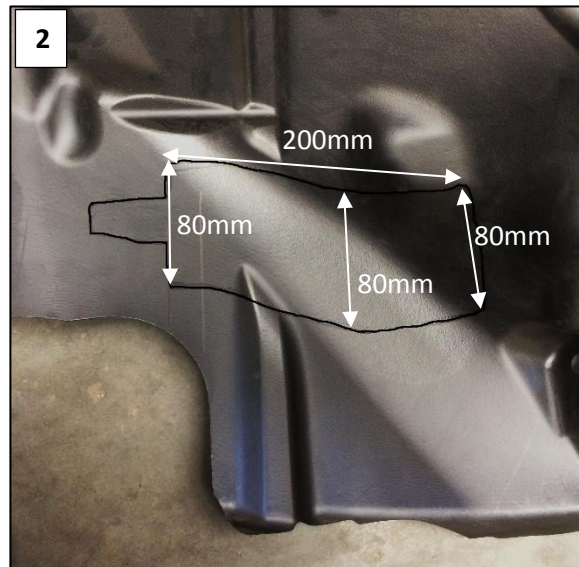
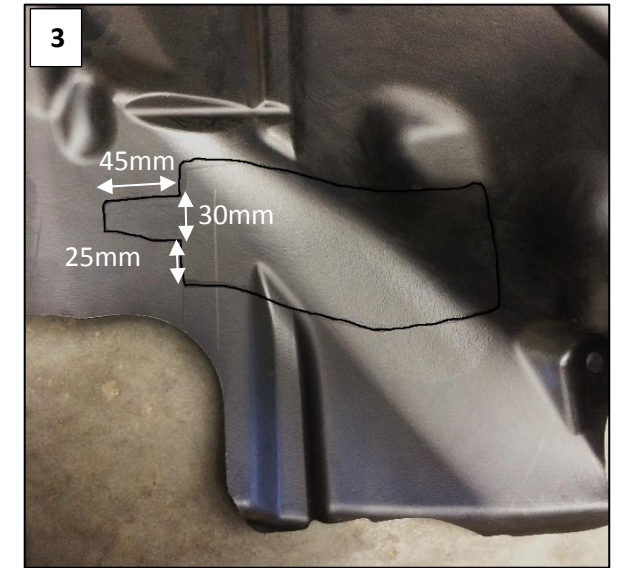
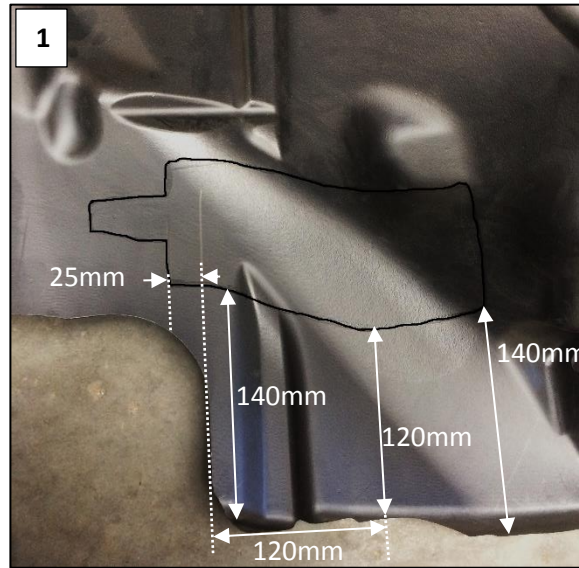

## RESERVOIR MOUNTING

### WHEEL ARCH PLASTIC TRIMMING CONTINUED...

5. Fit the wheel arch to the vehicle and check the progress after each cut. Ensure to secure the wheel arch with fasteners and clips so that the wheel arch is properly attached to the vehicle in every check.

The wheel arch may need to be pushed in to overcome any contact with reservoir.

6. Continue trimming and keep checking fit and clearance until the reservoir fully appears through the cut out.

7. The final cut out on the trim should appear similar to what is shown in picture.

8. The final fitment of the wheel arch should appear similar to what is shown in picture.

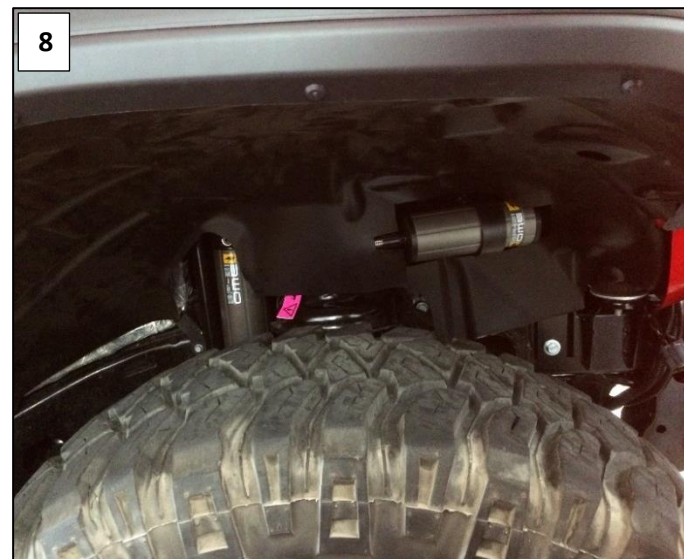

## DAMPING ADJUSTMENT

These dampers have been set in the factory to be used for a vehicle with accessories fitted. If your load or accessory fitment differs, use the table below as a guide for recommended compression (Comp) and rebound (Reb) adjuster settings. Refer to supplied Owners' Manual for more information.

Front accessories	Comp	Reb
Bar & winch	4-8	6-10
Bar only	2-6	5-9
No accessories	0-4	4-8

## SPECIFICATIONS

1	Factory Compression Setting	3
2	Factory Rebound Setting	5
3	Extended Length	649 mm
4	Compressed Length	416 mm

## SPARE PARTS

Refer to Service And Part manual, section BP-51 S&P 3.1\_BP5160033.

