

ROUGH COUNTRY

SUSPENSION SYSTEMS®



WARNING: This product contains a chemical known to the State of California to cause Cancer and Reproductive Harm. For more information, go to www.P65Warnings.ca.gov.

2019-UP CHEVY SILVERADO 1500

PRIOR TO INSTALLATION

- A) Install the flares according to these written instructions with the hardware provided. **WARNING:** Failure to install according to these instructions will invalidate the warranty. This includes, but is not limited to, using alternative installation methods, hardware, or materials. **DO NOT USE:** Loctite, Superglue, or similar products on the hardware or the flares. *Install flares on cleaned vehicle surfaces.*
- B) **Fit:** Verify the fit of the flares to vehicle prior to installation (some filing, sanding, or cutting may be necessary to ensure proper fit).
- C) **Painting:** (Optional) if paint is desired it must be done prior to installing flares on vehicle. Clean outer surface with a good grade degreaser. **DO NOT USE LACQUER THINNER OR ENAMEL REDUCER AS A DEGREASER.** Wipe outer surface thoroughly with a tack rag prior to paint. Application of plastic adhesion promoter for ABS plastic as per your paint system manufacturer's recommendations is required. Paint flares using a high-quality enamel, or polyurethane automotive paint. If painting edge trim (not recommended), use a flex additive.
- D) **Performance:** Using larger tires may increase the area required to turn the vehicle. Some tire/rim combinations may require lowering bump stops and or installing steering stops to prevent tire from contacting flare.
- E) **Exhaust System:** Modifications may be necessary to maintain a minimum 4" clearance between flares and exhaust pipes. (Exhaust gases should not vent directly onto flares)
- F) **Metal Protection:** All exposed fasteners and bare metal should be treated with rust resistant paint **BEFORE** installing flares. Spray inner fender wells with undercoating **AFTER** flare attachments have been completed.
- G) **Decals:** Flares may interfere with existing decals on vehicle. If you wish, remove decals prior to installation of flares.
- H) **Care & Cleaning:** Fender flares are built to last; any detergent you use to wash your vehicle is sufficient to clean the flare. Do not use any harsh abrasive detergents.

TOOLS FOR EASY INSTALLATION:

- Soft Cloth or Alcohol Wipe
- 1/2" or 13mm Wrench
- Socket Wrench
- 10mm socket
- T15 Torx Bit
- Utility Knife

PLEASE READ: Dirt and debris can become lodged between the fender flares and the vehicle's fenders, causing scratching and paint wear from vibration. Manufacturer is not responsible for any damage, and the installation of our fender flares is done with the buyer's understanding that this scratching and paint wear may occur.

LIMITED LIFETIME WARRANTY AGAINST ANY MANUFACTURING DEFECTS: To claim warranty you must provide Proof of Purchase.

INCLUDED IN HARDWARE KIT:

1.



SS Pocket Torx Bolt
34 pcs

2.



SS Pocket Washer
34 pcs

3.



Pocket Nylock Nut
34 pcs

4.



T-45 Torx Bit
1 pc

5.



Short "U" Clip
4 pcs

6.



Long "U" Clip
6 pcs

7.



#8 Speed Clip
4 pcs

8.



Pinch Clip Part A
4 pcs

9.



Pinch Clip Part B
4 pcs

10.



#8 Truss-Head Screw
4 pcs

11.



#10 Truss-Head
Screw
14 pcs

12.



Foam Tabs
10 pcs

13.



Wiper Style Edge
Trim
358 inches

SECTION 1: FRONT FLARE EXTENSION PIECE INSTALLATION



Install extension pieces to main front flares using 2 supplied #8 Speed Clips and #8 Truss Head Screws per side.



Before tightening, make sure that molded flare features are aligned. Tighten screws using #2 Phillips driver.

SECTION 2: EDGE TRIM INSTALLATION

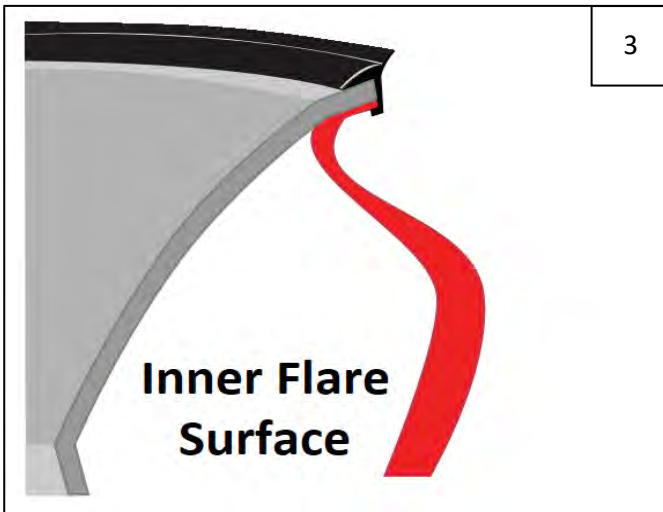

Peel 2-3 inches of red vinyl backing away from supplied edge trim tape. Applying the adhesive side of the edge trim to the inner side of the flare, affix the edge trim to the top edge of the flare (the portion that comes in contact with the side of the vehicle).

Press edge trim into place along the top edge of the flare in one-foot increments, pulling red vinyl backing free as you continue to work your way around the top edge of the flare. Trim edge trim flush with ends of flare.



When you come to the jointure of the flare and extension piece, cut a notch in the back of the edge trim.

SECTION 3: POCKET HARDWARE INSTALLATION



Install a supplied SS Pocket Washer onto each SS Pocket Torx Bolt.



Insert each Bolt/Washer combination through pocket holes in flare, Bolt head and Washer on the outside.



Place a supplied Pocket Nylock Nut over the end of each bolt and tighten using a 1/2" wrench for the Nut and the supplied T-45 Torx Bit for the Bolt. Repeat for all pockets.

SECTION 4: FRONT FLARE INSTALLATION



Using a T15 Torx bit, remove 3 factory fasteners indicated by arrows holding the factory mud flap on. Retain all screws.



Using a 10mm socket, remove 1 factory bolt from mud flap indicated by arrow. Remove mud flap by pulling firmly away from vehicle body (a hidden clip will disengage).



Attach 2 supplied Short "U" Clips to the supplied Inner Bracket as shown.



Inner Bracket Short "U" Clip locations.



Remove 2 factory T15 Torx screws at top of wheel well as shown. Retain.



Install Inner Bracket using 2 T15 Torx screws retained in Step 12. Tighten both fasteners. **NOTE:** Driver Side bracket is marked with LH, Passenger Side is RH.



14

Align flare on vehicle and mark 2 forward hole locations with a grease pencil.



15

Peel liner from a supplied Foam Tab and center tab over each mark made in Step 14, folding over wheel well lip.

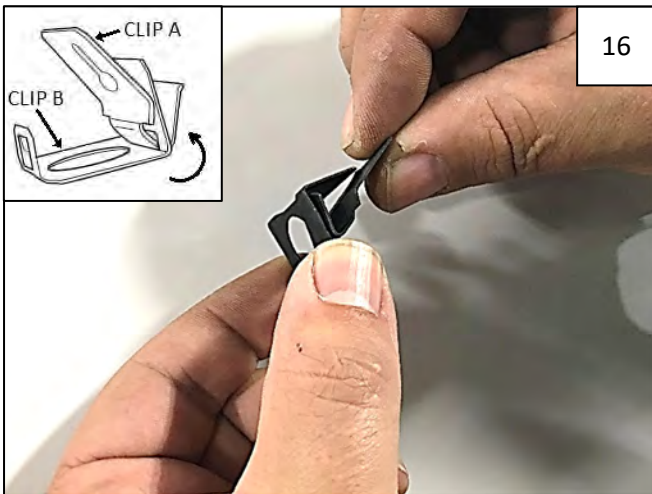

16

Assemble Pinch Clip A and Pinch Clip B as shown. Do NOT pinch down to engage at this time.

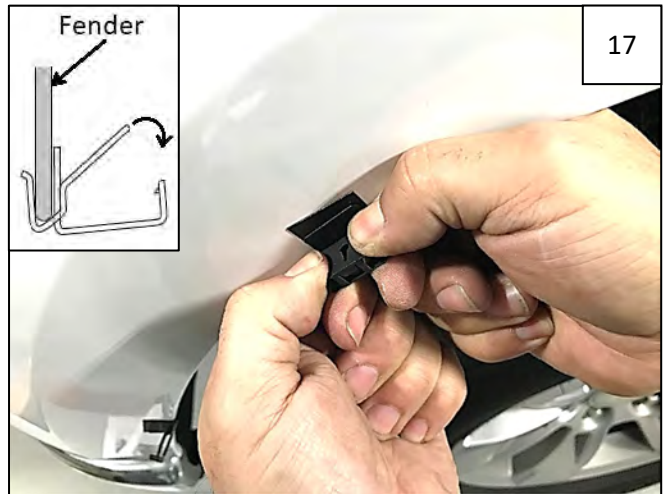

17

Slide assembled Pinch Clip over each Foam Tab and pinch down to engage – clip will clamp onto wheel well lip and make a snapping sound when engaged.



18

Align flare on vehicle and start 4 supplied Truss-Head Screws through holes in flare and into fender as shown.



19

Start 2 factory T15 Torx screws at bottom rear of wheel well as shown. Apply pressure to flare towards vehicle body at each fastening point and tighten all fasteners.

SECTION 5: REAR FLARE INSTALLATION



Remove 1 factory T15 Torx screw on rear splash guard. Retain all factory screws; some will be used.

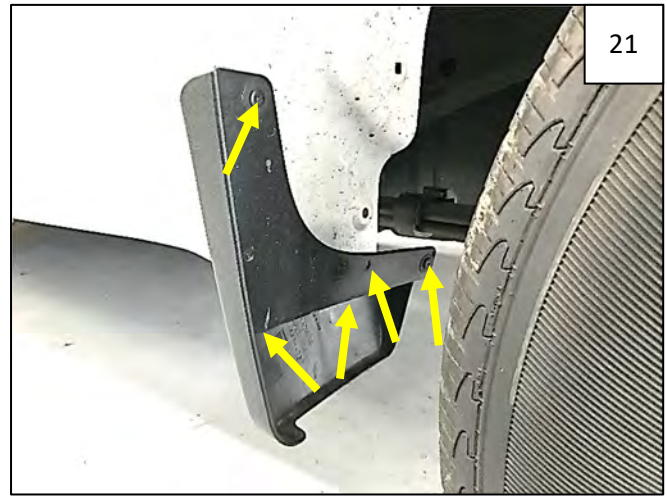

Remove 5 factory screws from the front splash guard. Splash guard is held on with a hidden clip – to remove, pull splash guard firmly from vehicle.



Align the flare on the fender and mark 3 holes using a grease pencil.



Hole locations.



Peel liner from a supplied Foam Tab and center tab over each mark made in Step 22; fold each tab over lip of wheel well.



Slide a supplied Long "U" Clip over each Foam Tab, making edge of clip flush with outer edge of wheel well lip as shown.



Hold flare on fender. Start 3 factory screws removed in Steps 18 and 19 as shown.



Start 3 supplied Truss-Head Screws through upper holes in flare and into clips installed in Step 25. Apply pressure to flare towards vehicle body at each fastening point and tighten all fasteners.