

8-Gang Switch Instructions

Thank you for choosing Rough Country for all your vehicle needs.

Please read instructions before beginning installation. Check the kit hardware against the kit contents shown below. Be sure you have all needed parts and know where they go.

If question exist, please call us @1-800-222-7023. We will be happy to answer any questions concerning this product.

Check all fasteners for proper torque. Check to ensure for adequate clearance between all components.

Periodically check all hardware for tightness.

KIT CONTENTS:

- Circuit Breaker x1
- Circuit Board x1
- Circuit Board Mount x1
- Positive Wire x1
- Negative Wire x1
- Switch Panel x1
- Cable Ties x10

- Switch Panel Wiring Harness x1
- Accessory Harness x1
- 50 Custom Stickers x1
- Supplied Hardware and Allen Wrench x1
- Switch Panel Mounting
 - Flat Mount x1
 - Adjustable Mount x1



Torque Specs:

Size	Grade 5	Grade 8	Size	Class 8.8	Class 10.9
5/16"	15 ft/lbs	20ft/lbs	6MM	5ft/lbs	9ft/lbs
3/8"	30 ft/lbs	35ft/lbs	8MM	18ft/lbs	23ft/lbs
7/16"	45 ft/lbs	60ft/lbs	10MM	32ft/lbs	45ft/lbs
1/2"	65 ft/lbs	90ft/lbs	12MM	55ft/lbs	75ft/lbs
9/16"	95 ft/lbs	130ft/lbs	14MM	85ft/lbs	120ft/lbs
5/8"	135ft/lbs	175ft/lbs	16MM	130ft/lbs	165ft/lbs
3/4"	185ft/lbs	280ft/lbs	18MM	170ft/lbs	240ft/lbs



INSTALLATION INSTRUCTIONS

1. Locate the Circuit board mounting bracket. Secure the bracket to the desired location in an unobstructed area to safely route the wiring. Use the supplied hardware to secure.
2. Place the Circuit board onto the mounting bracket. Route the supplied positive and negative wiring, accessory switch wire and the switch panel wiring through the right side of bracket and the circuit board. **See Photo 1.**
3. Connect the switch wire connector and the switch panel connector wires onto the circuit board. **See Photo 2.**
4. Connect the white wire to ACC / Factory dimmer switch and the red wire to a Positive power source.

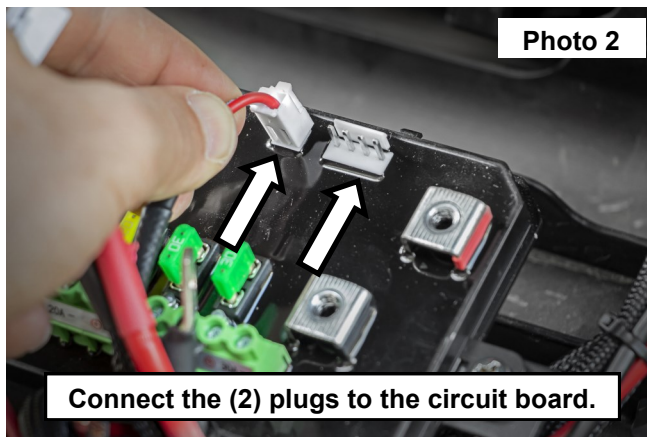
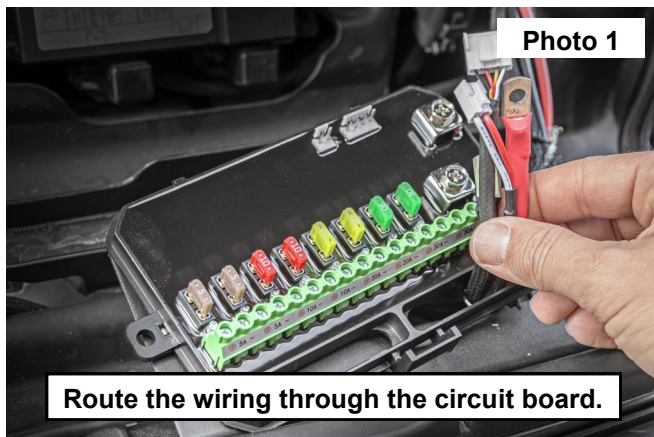

5. Connect the Positive and Negative wires to the circuit board. Remove the screw from the circuit board and place the wire onto the terminal, place the screw into the terminal and tighten using a Phillips head bit. **See Photo 3.**
6. Install the circuit breaker in a accessible location. Secure using (2) of the supplied screws. Tighten using a Phillips bit driver. **See Photo 4.**

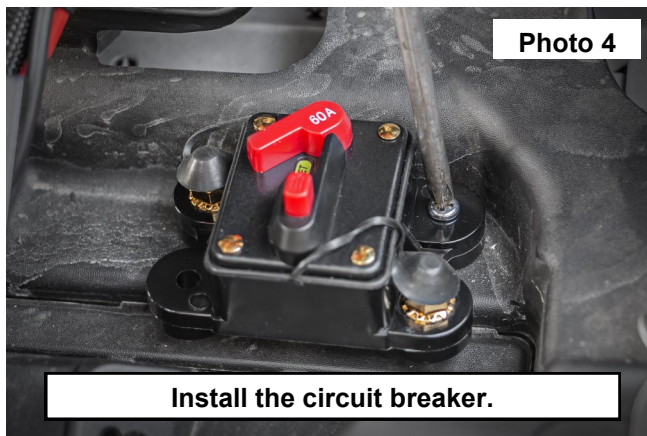

7. Secure the positive cables on each terminal of the circuit breaker. Tighten using an 11mm socket. **See Photo 5.**
8. Place the clear cover over the circuit breaker. **See Photo 6.**
9. Connect the Positive and Negative wires to the battery.

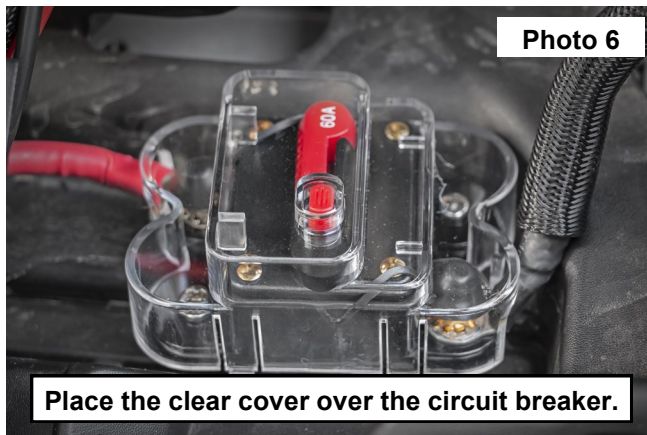
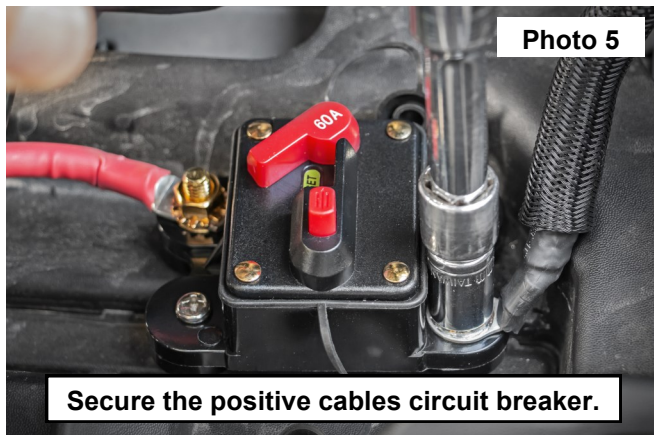

10. Secure the circuit breaker to the mounting bracket using (2) of the supplied nuts and bolts. Tighten using a Phillips head bit and an 10mm wrench. **See Photo 7.**
11. Locate the Switch panel. **See Photo 8.**

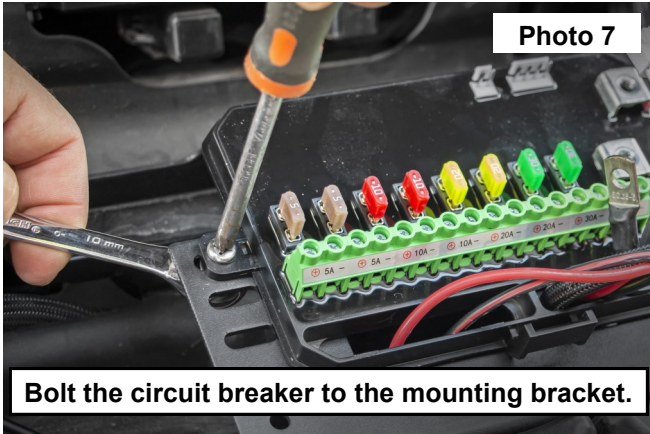

12. Choose the mounting bracket that is best for your application and install onto the control panel using the supplied screws. **See Photos 9 and 10.**

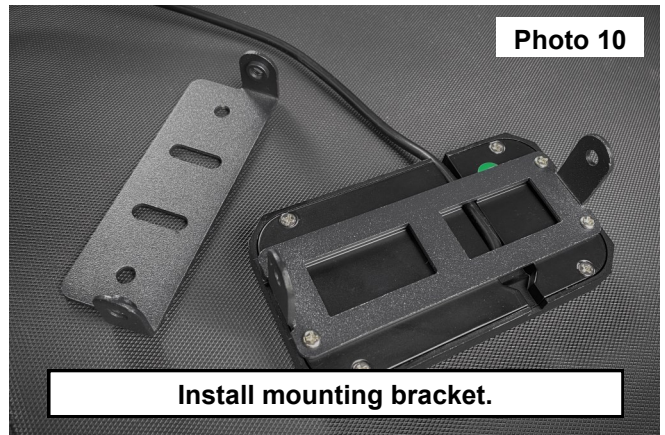

13. Mount the control panel into the desired location and connect the wiring harness together. Tighten the threaded nut to secure and seal the connectors. **See Photos 11 and 12.**

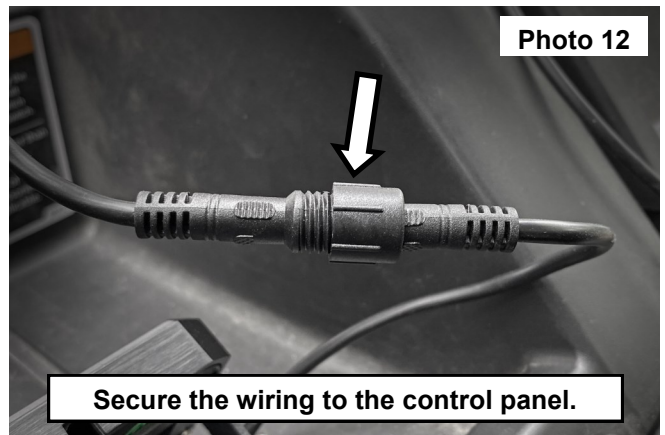
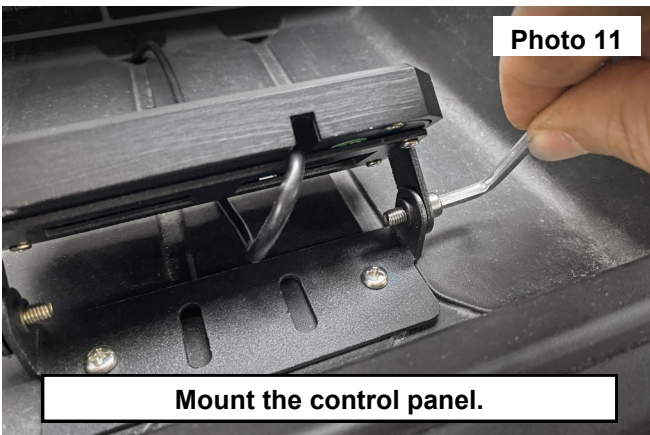

14. Connect the wiring from the products that will be used by the switch panel. Choose from the fused 5A, 10A, 20A, 30A slots for your application. **See Photo 13.**
15. Press each button on the switch panel to confirm the switched product is working properly.
16. Install the circuit breaker cover. **See Photo 14.**

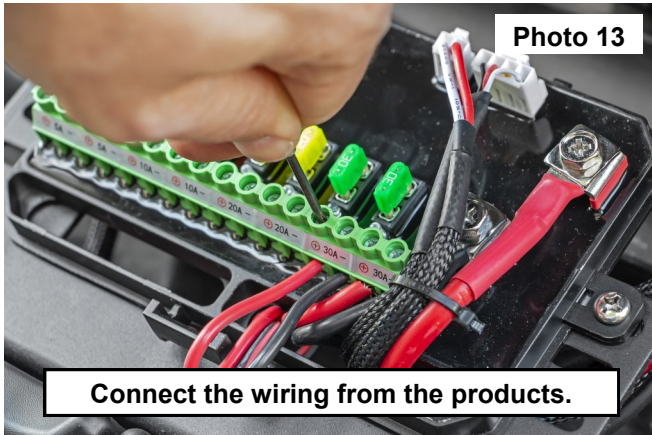

Connect the wiring from the products.

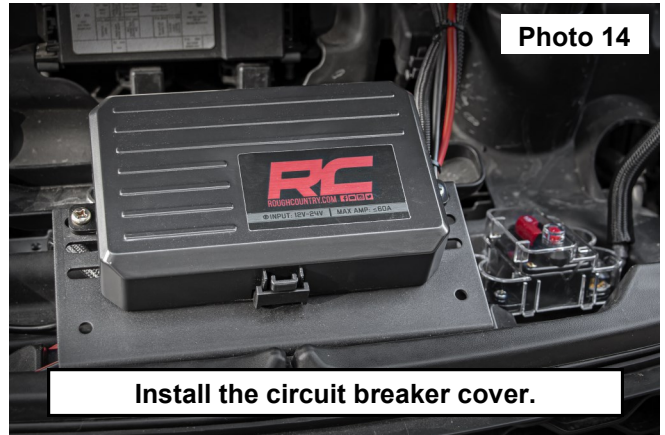

Install the circuit breaker cover.

17. Choose the appropriate sticker for each switched application and apply onto the switch panel. **See Photo 15.**



18. Apply 8 of the stickers that closely matches the switched application onto the buttons of the switch panel. **See Photo 16.**

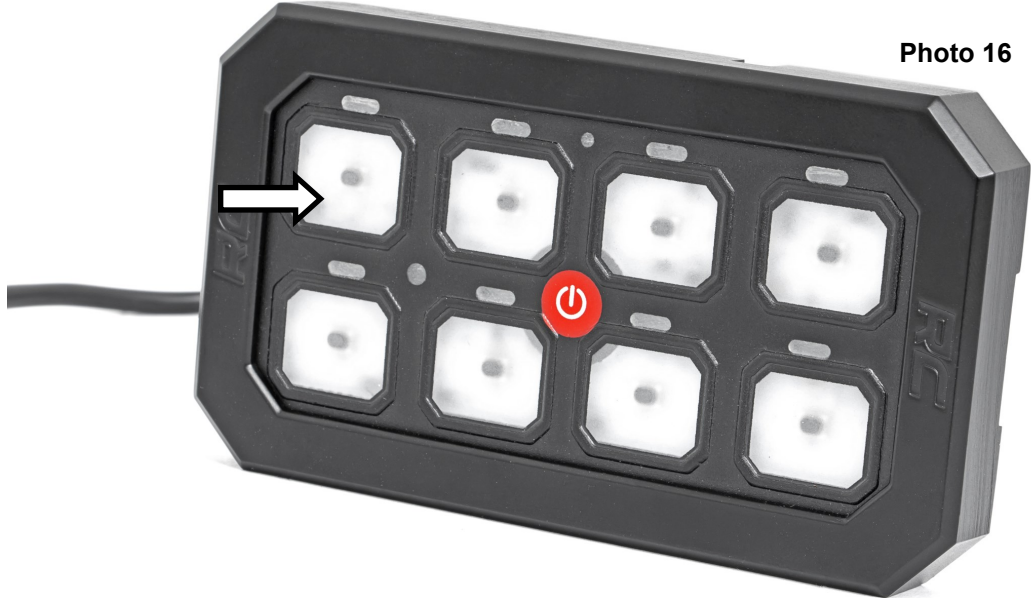

When LED light is red, the fuse is bad.

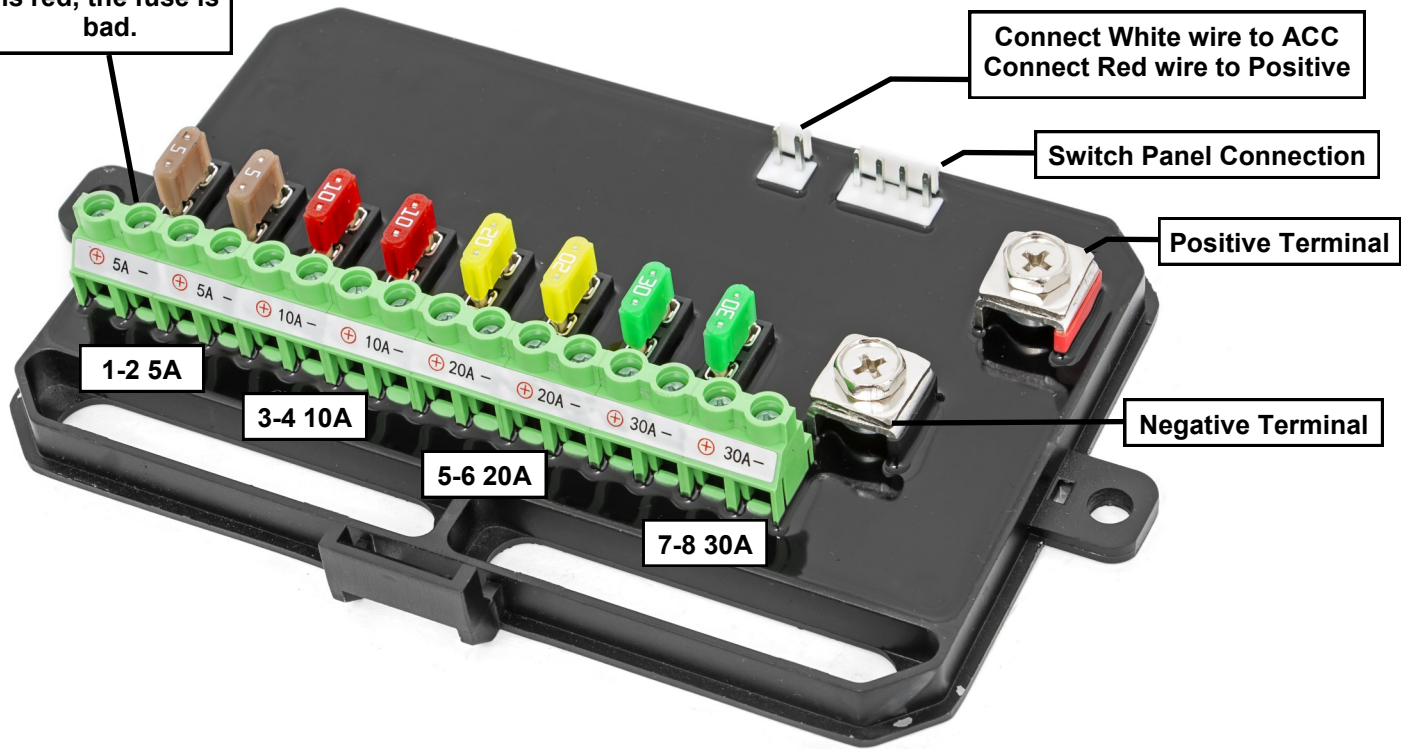

Note Switch number as it coordinates with fuse panel and Amp

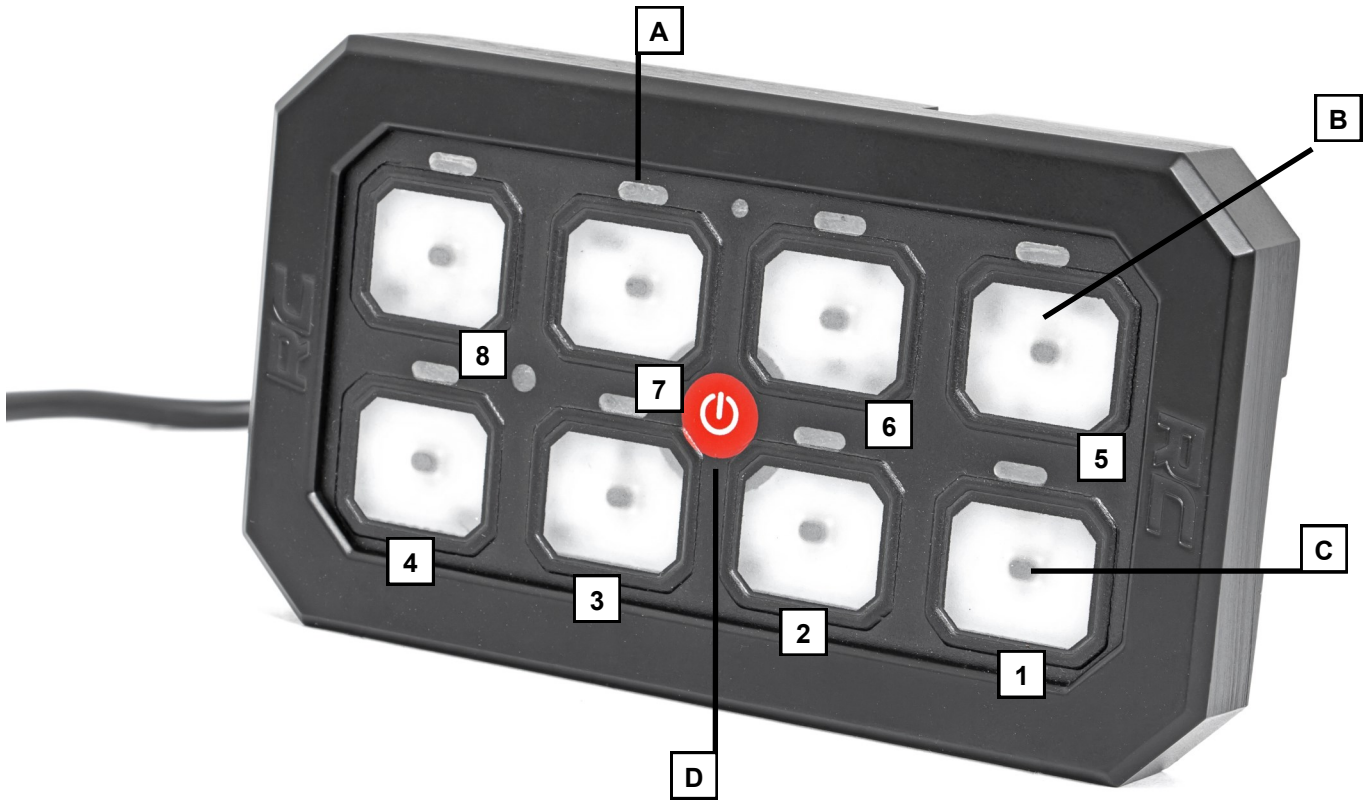

- A-Red LED lights up to show the circuit is on.
- B-Area for DIY placement of the selected labels.
- C-Blue LED illumination area, back light for the label.
- D-Manual power activation button, press to turn on/off. Function momentary.



Wire Connections

This switch panel control system has eight switch circuits, each has a maximum current rating. The total operating amperage of the connected accessories can not exceed 60 amps(600 watts). You may have multiple electrical devices or auxiliary LED lights connected that total more than 60 amps, but you can not have them turned on at the same time. Otherwise, the control box will be damaged. The switch panel comes configured with the following fuses:

Circuit 1 30A, Circuit 2 30A, Circuit 3 20A, Circuit 4 20A, Circuit 5 10A, Circuit 6 10A, Circuit 7 5A, Circuit 8 5A.

Spare Fuses

Spare fuses and fuse removal / install tool are supplied under the circuit breaker cover.



Dimmable Feature

Connecting the 'White Wire' to the ACC / Factory dimmer switch will allow the backlit brightness to be incrementally adjusted.

By purchasing any item sold by Rough Country, LLC, the buyer expressly warrants that he/she is in compliance with all applicable, State, and Local laws and regulations regarding the purchase, ownership, and use of the item. It shall be the buyers responsibility to comply with all Federal, State and Local laws governing the sales of any items listed, illustrated or sold. The buyer expressly agrees to indemnify and hold harmless Rough Country, LLC for all claims resulting directly or indirectly from the purchase, ownership, or use of the items.

