

# ROUGH COUNTRY

## SUSPENSION SYSTEMS®

### 84-96 Jeep XJ MLC-6 Kit

Thank you for choosing Rough Country for all your lighting needs.

#### ▲ NOTICE

Please read instructions before beginning installation. Check the kit hardware against the kit contents shown below. Be sure you have all needed parts and know where they go. If question exist, please call us @1-800-222-7023. We will be happy to answer any questions concerning the design, function, and correct use of our products.

#### Tools Needed:

1/4" Drill Bit  
15mm Socket  
Ratchet  
Flat head Screwdriver  
Phillips Screwdriver  
Drill Motor  
8mm Wrench  
3mm Allen Wrench

#### Kit Contents

(1) Switch Pod Bezel w/Switches  
(1) Relay Pod w/Mounting Bracket  
(1) Wiring Harness  
(1) Power & Ground Wires  
(6) Allen Head Bolts  
(6) Lock Nuts  
Heat shrink Tubing  
Wire ends  
Zip Ties



## INSTALLATION INSTRUCTIONS

1. Park the vehicle on a smooth level surface.
2. Assemble the fuse panel on the mounting bracket with the fuse panel hardware if not already.
3. Remove the 4 bolts shown in **Photo 1** using a 11mm wrench.
4. Secure the mounting bracket to the firewall with the stock hardware. Tighten using a 11mm wrench. **See Photo 2.**

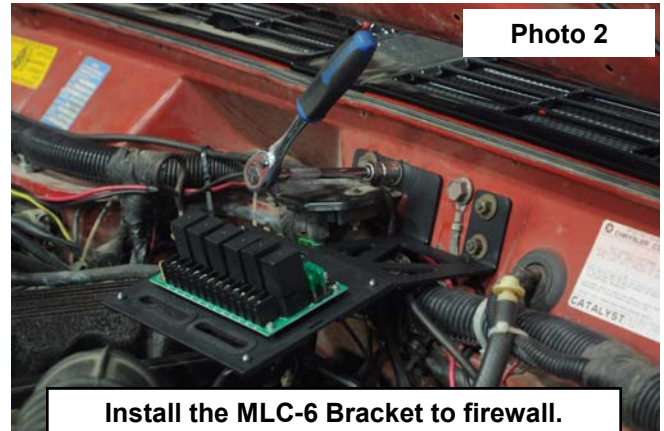
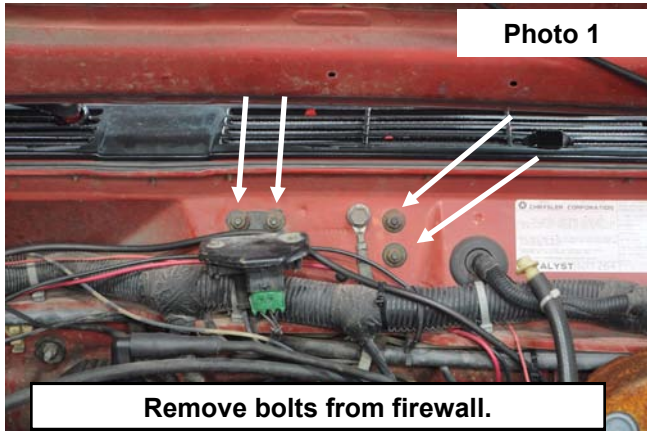

5. Remove the center console as shown using a Phillips and flat head screwdriver. **See Photo 3 & 4.**



6. Remove the two screws under the shifter bezel using a Philips head screwdriver. **See Photo 5 & 6.**

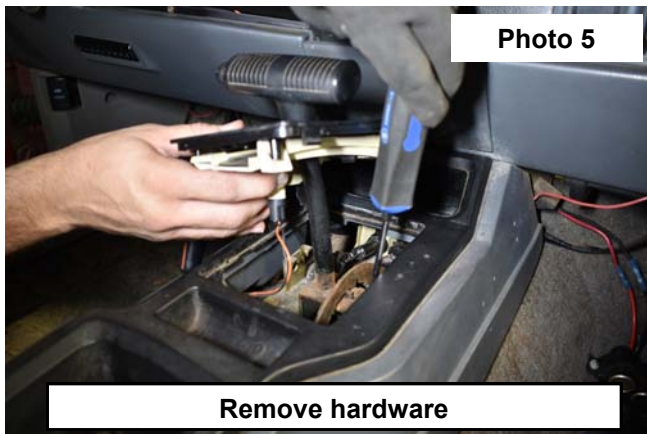



7. Remove the cover as shown in **Photo 7**.
8. Drill a hole in the bottom of the center cover and enlarge hole to allow the bezel plug to pass through. **See Photo 8**.



9. Place the switch bezel on the center cover as shown in **Photo 9** and mark the holes to be drilled. Drill using a 1/4" drill bit.
10. Install the supplied Allen head bolts and tighten bezel to the cover using a 3mm Allen wrench and a 1/4" socket. Do NOT over tighten the Allen bolts. It is only necessary to only tighten enough to hold the bezel in place.
11. Route the switch wires through the hole in bezel and under dash.
12. Re-install the console cover with the stock hardware and tighten using a Phillips screwdriver. **See Photo 10**.

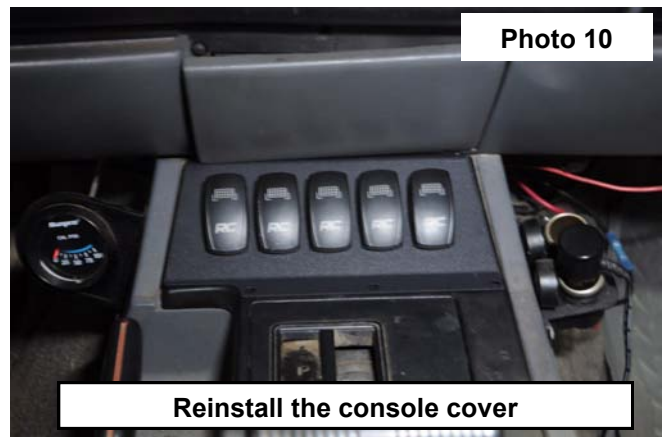

13. Route the wiring harness through the firewall taking care not to install near heat sources or sharp edges that might cut or damage wires.
14. Wire LED lights to fuse panel. **See Photo 11**.

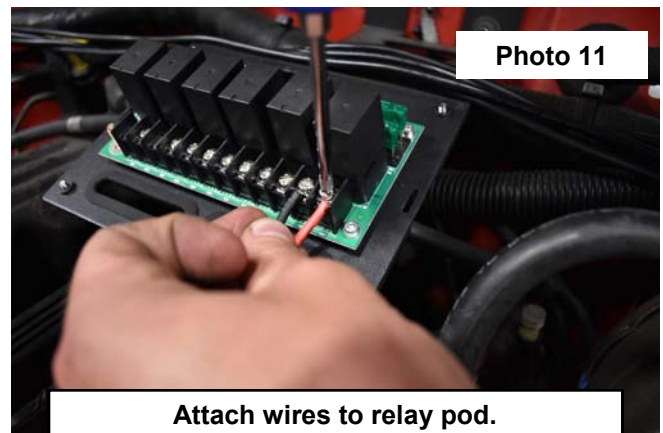

**▲ NOTICE** AFTER INSTALLATION, YOU MUST START THE ENGINE TO ACTIVATE THE SYSTEM! **▲ NOTICE**



**▲ NOTICE** AFTER INSTALLATION, YOU MUST START THE ENGINE TO ACTIVATE THE SYSTEM! **▲ NOTICE**

By purchasing any item sold by Rough Country, LLC, the buyer expressly warrants that he/she is in compliance with all applicable , State, and Local laws and regulations regarding the purchase, ownership, and use of the item. It shall be the buyers responsibility to comply with all Federal, State and Local laws governing the sales of any items listed, illustrated or sold. The buyer expressly agrees to indemnify and hold harmless Rough Country, LLC for all claims resulting directly or indirectly from the purchase, ownership, or use of the items.

