



14-18 Subaru Forester Spoiler Light

Thank you for choosing Rough Country for all of your suspension needs.

Rough Country recommends that a certified technician install this system. In addition to these instructions, professional knowledge of disassemble/reassembly procedures as well as post installation checks must be known. Attempts to install this system without this knowledge and expertise may jeopardize the integrity and/or operating safety of the vehicle. Please read all the instructions before beginning the installation. Check the kit hardware against the "Kit Contents" list below. If question exist, please call us @1-800-222-7023. We will be happy to answer any questions concerning this product. Check all fasteners for proper torque. Check to ensure for adequate clearance between all components. Check and retighten wheels at 50 miles and again at 500 miles. Periodically check all hardware for tightness. Be sure you have all the needed parts and understand where they go. Also, please review the "Tools Needed" list to be certain you have the necessary tools to complete the installation.

PRODUCT USE INFORMATION

⚠ WARNING As a general rule, the taller a vehicle is the easier it will roll. We strongly recommend that seat belts and shoulder harnesses be worn at all times. Braking performance and capabilities are decreased when significantly larger/heavier tires and wheels are used. Do not add, alter, or fabricate any factory or after-market parts which increase vehicle height over the intended height of the Rough Country product purchased. Rough Country makes no claims regarding lifting devices and excludes any and all implied claims. We will not be responsible for any product that is altered.

NOTICE TO DEALER AND VEHICLE OWNER

⚠ NOTICE Any vehicle equipped with any Rough country product must have the "Warning to Driver" decal installed on the sun visor or dash. The decal is to act as a constant reminder for whoever is operating the vehicle of its unique handling characteristics. **INSTALLING DEALER**—It is your responsibility to install the warning decal and to forward these installation instructions on too the vehicle owner for review and to be kept in the vehicle for its service life.



14-18 Subaru Forester Spoiler Light

TOOLS NEEDED:

Wire Stripper
Wire Crimper
Sander
Cutting Tool
Electrical Connectors
Metric Wrench/Socket
10mm

KIT CONTENTS:
Driver Side Bracket
Pass Side Bracket

HARDWARE INCLUDED:
Double Sided Tape
25' Extension Harness



Spoiler Light Installation

1. Start by opening the back door. Look up at the trim panels surrounding the window. Grab and gently pull down and away from the door the middle panel. **Photo 1**
2. Once this is out of the way, you will see two access holes in the door and behind those a nut. Remove using a 10mm socket. Do not lose these as they will need to be reinstalled later. **Photo 2**

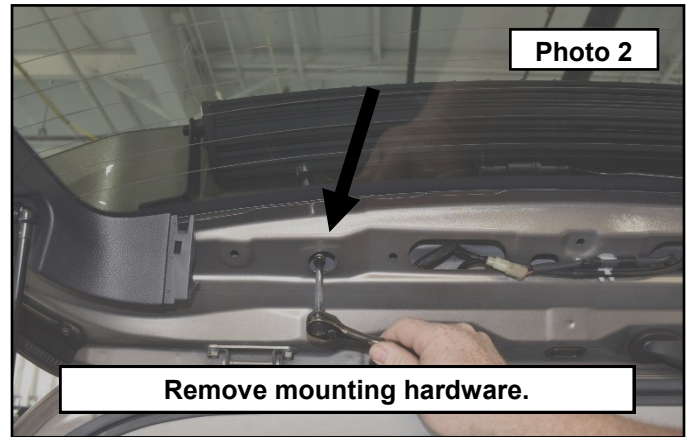
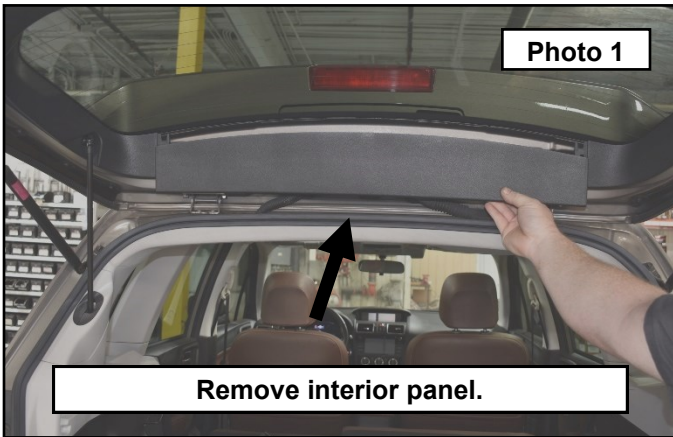

3. Disconnect the third brake light electrical connector. **Photo 3**
4. Close the door. Now look on top of the spoiler at both ends. You will find pop out panels. Use a small prying tool to pop these out of the spoiler. **Photo 4**

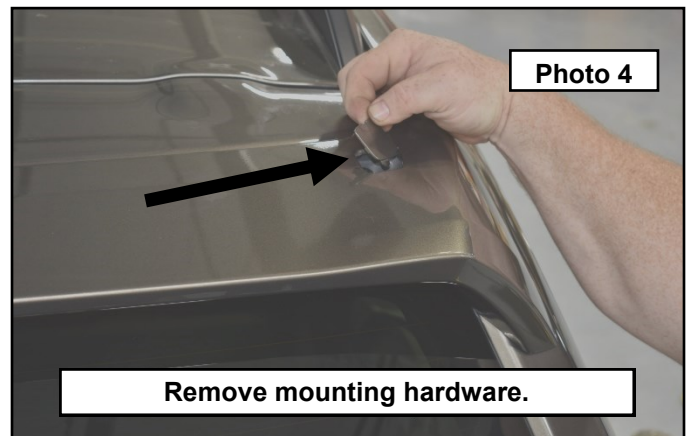
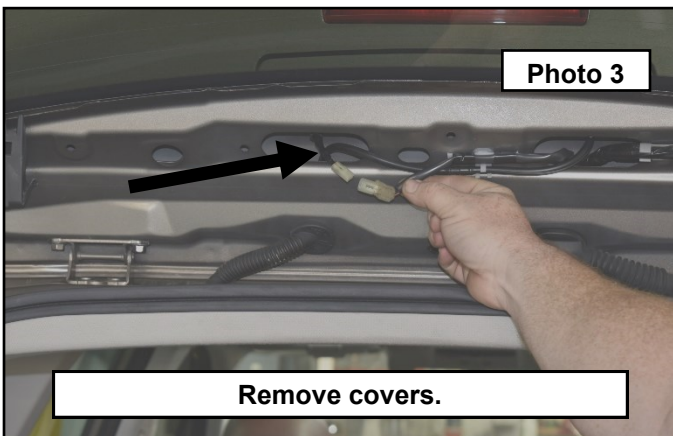

5. Underneath you will find a bolt. Remove using a 10mm socket. **Photo 5**
6. Next you will need to pop the spoiler out of the rest of its mounts. It is held in place with plastic pop clips. You will have to pull out and away from the door. This takes quite a bit to pop off and you may want to have a helper grab one end while you do this. Remove the harness by gently pulling the grommet out of the body. **Photo 6**

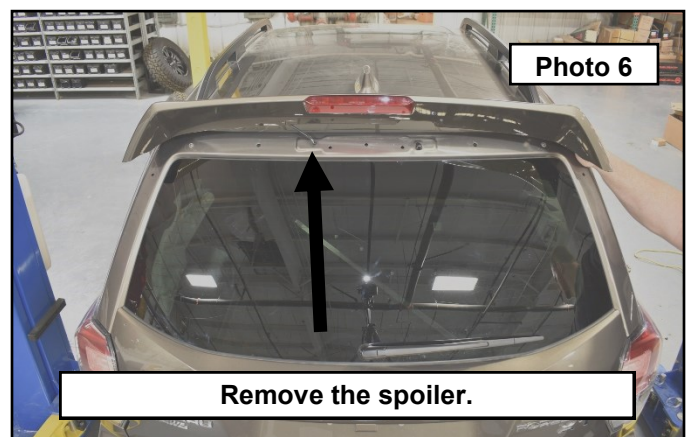
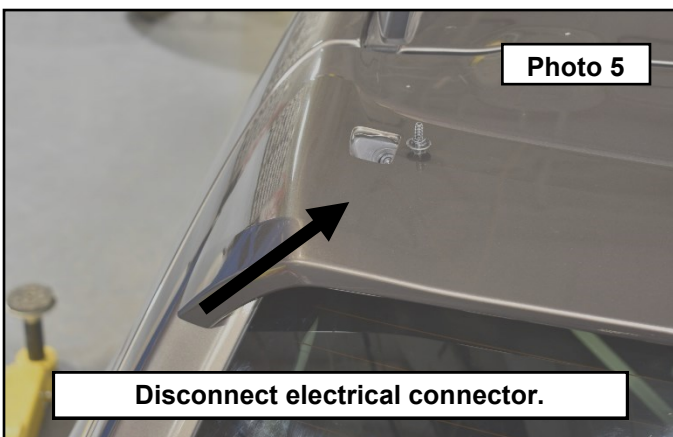

- Clean the window to remove any debris and grease. Locate the light bar mounts and attach the double sided tape to the area shown. This is to aid in installation as well as protect the glass from the bracket resting on it. **Photo 7**
- Install the brackets to the glass while lining up the bolt hole locations. You will notice the outer hole has a raised lip, the bracket will sit around this lip. This is important to make sure you have this hole lined up properly for the spoiler to fit back to the door. Once the brackets are lined up, firmly press onto the area with the tape. **Photo 8**

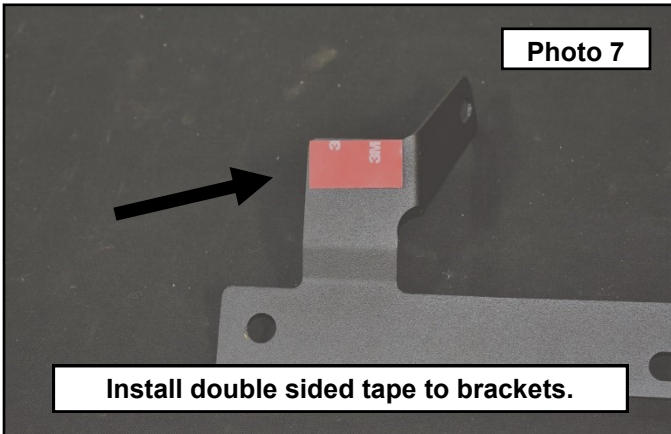

- Once the brackets are lined up and taped to the window, lay the spoiler in place to mark where the brackets will make contact. DO NOT pop the spoiler into place yet. Mark the area. **Photo 9**
- Remove 1/16" of material deep at the marked area using a cutting (deburr tool shown) or sanding tool. Take your time to make this a clean install. **Photo 10**

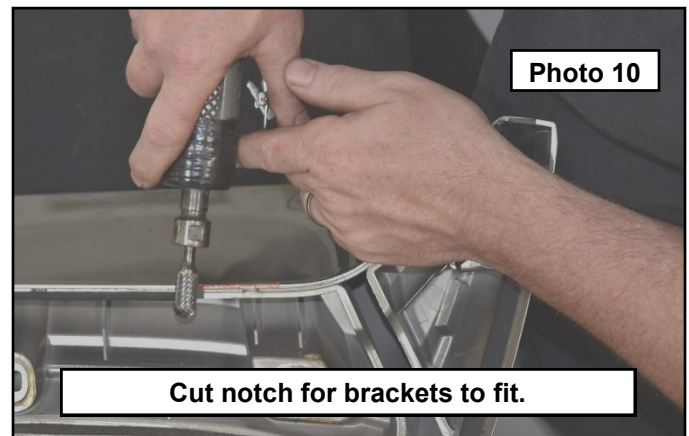
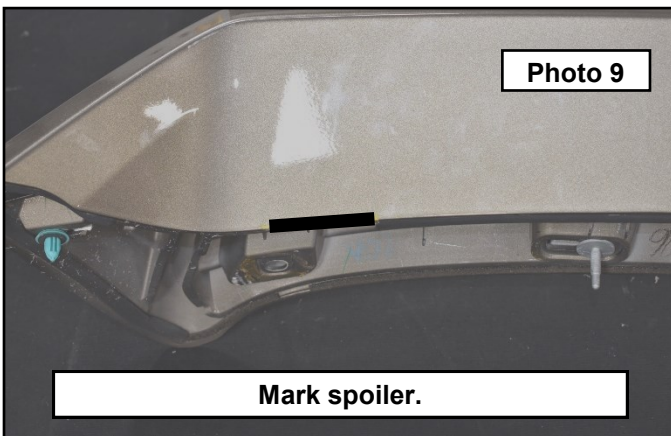

- You will need to notch out the spoiler for the wire harness as well. Mark as shown and cut out a 1/2" recess for the harness. **Photo 11**
- With the spoiler modifications done, you will want to run your harness extension. We suggest that you use the rubber grommet and wire loom that the factory third brake light is using. This will require you to cut and splice the light harness. This is all customer preference and you will determine how far you want to go to make it look nice. **Photo 12**

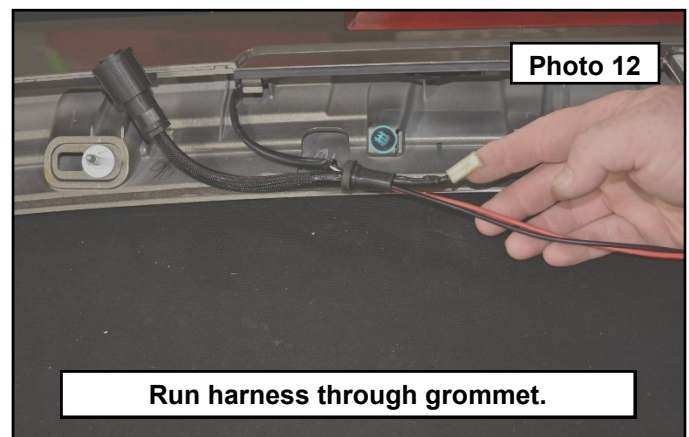
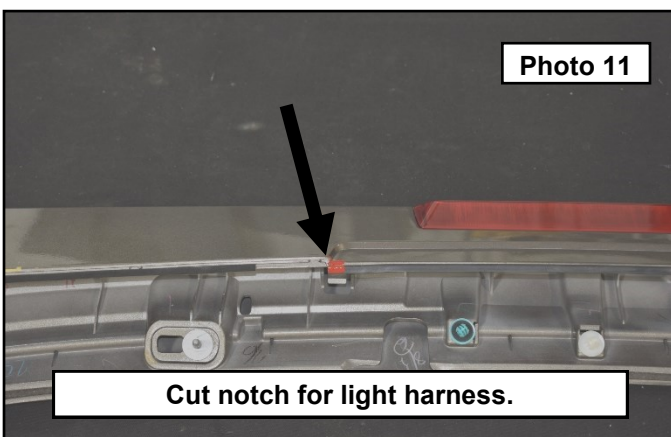

13. Pop the spoiler into place. Attach the spoiler using the factory bolts using the 10mm socket. Do not over tighten.

Photo 13

14. Reinstall the bolt covers by popping them back into place in their corresponding sides. **Photo 14**



15. Connect the electrical connector for the light. **Photo 15**

16. Attach the light bar using the provided hardware in the light bar kit. Do not fully tighten at this time. **Photo 16**

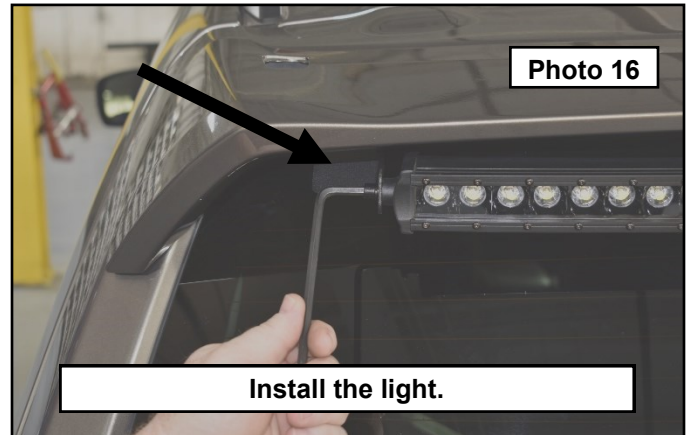
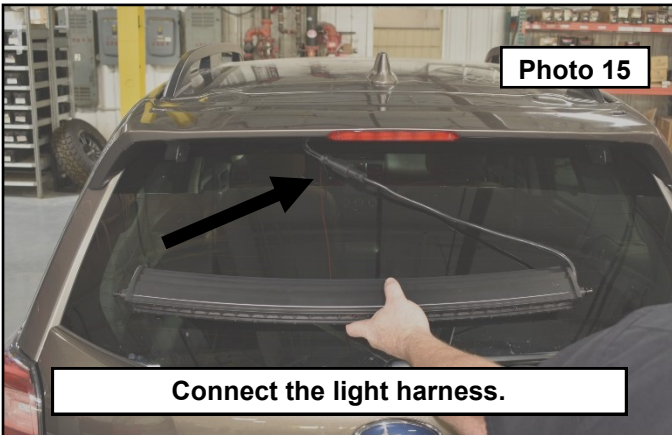

17. Reinstall the two nuts from the inside of the door. Do not overtighten. **Photo 17**

18. Reinstall the plastic trim panel. **Photo 18**

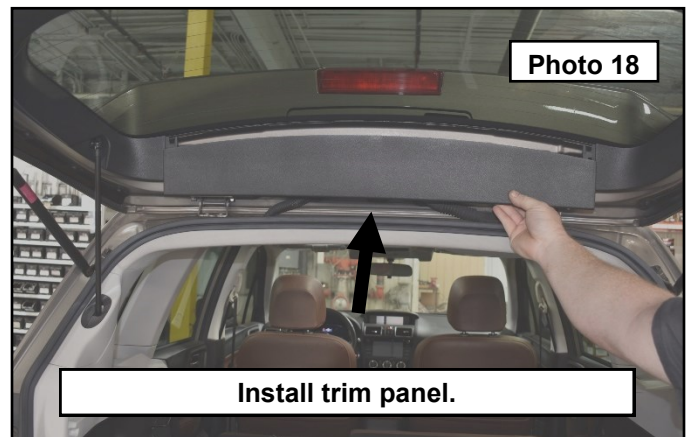
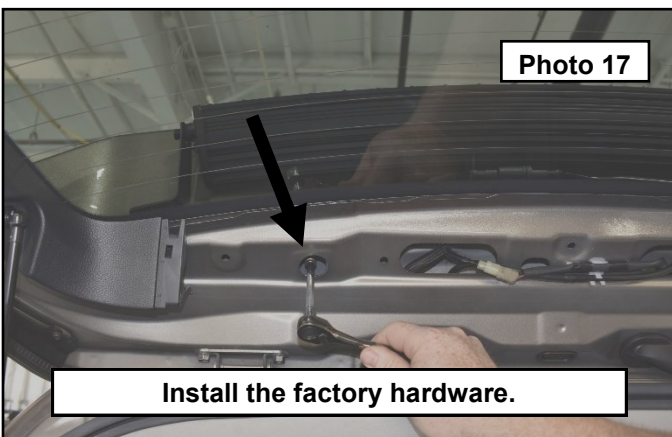

19. Run the wire harness accordingly. We suggest that you run the harness through the existing wire loom rubber tube, down the back pillar and along the floor to the front firewall. Tucking the wire under the plastic trim panels along the way. Find a spot that you can run the wire through the firewall. Typically you will find a block off panel that you can drill through or a rubber grommet that passes other harnesses through as done at the back door. This again is up to you and how you would like the finished product to look. Run the harness that came with the light to the battery and attach the switch to your preferred location. Make sure to protect any wires from metal contact that could cut or fray the insulation. **Photo 17 / 18**

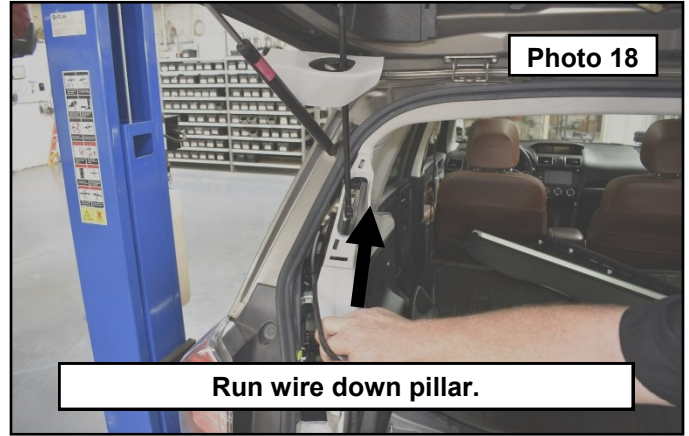
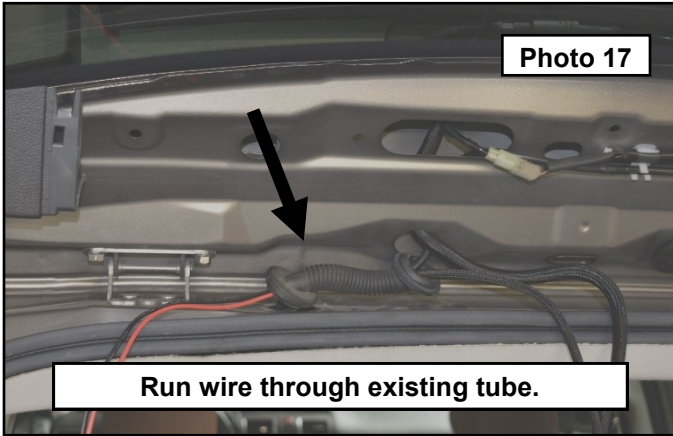

By purchasing any item sold by Rough Country, LLC, the buyer expressly warrants that he/she is in compliance with all applicable , State, and Local laws and regulations regarding the purchase, ownership, and use of the item. It shall be the buyers responsibility to comply with all Federal, State and Local laws governing the sales of any items listed, illustrated or sold. The buyer expressly agrees to indemnify and hold harmless Rough Country, LLC for all claims resulting directly or indirectly from the purchase, ownership, or use of the items.