



Tundra Dual Ditch Light Mount

Thank you for choosing Rough Country for all of your suspension needs.

Rough Country recommends that a certified technician install this system. In addition to these instructions, professional knowledge of disassemble/reassembly procedures as well as post installation checks must be known. Attempts to install this system without this knowledge and expertise may jeopardize the integrity and/or operating safety of the vehicle. Please read all the instructions before beginning the installation. Check the kit hardware against the “Kit Contents” list below. If question exist, please call us @1-800-222-7023. We will be happy to answer any questions concerning this product. Check all fasteners for proper torque. Check to ensure for adequate clearance between all components. Check and retighten wheels at 50 miles and again at 500 miles. Periodically check all hardware for tightness. Be sure you have all the needed parts and understand where they go. Also, please review the “Tools Needed” list to be certain you have the necessary tools to complete the installation.

PRODUCT USE INFORMATION

⚠WARNING As a general rule, the taller a vehicle is the easier it will roll. We strongly recommend that seat belts and shoulder harnesses be worn at all times. Braking performance and capabilities are decreased when significantly larger/heavier tires and wheels are used. Do not add, alter, or fabricate any factory or after-market parts which increase vehicle height over the intended height of the Rough Country product purchased. Rough Country makes no claims regarding lifting devices and excludes any and all implied claims. We will not be responsible for any product that is altered.

NOTICE TO DEALER AND VEHICLE OWNER

⚠NOTICE Any vehicle equipped with any Rough country product must have the “Warning to Driver” decal installed on the sun visor or dash. The decal is to act as a constant reminder for whoever is operating the vehicle of its unique handling characteristics. **INSTALLING DEALER**—It is your responsibility to install the warning decal and to forward these installation instructions on too the vehicle owner for review and to be kept in the vehicle for its service life.



Dual Ditch Light Bracket

TOOLS NEEDED:

Cutters
Metric Wrench/Socket
12mm
13mm

KIT CONTENTS:

Driver Bracket
Passenger Bracket
Light Kit

HARDWARE INCLUDED:

8mm Bolt (4)
8mm Flat Washer (4)
Zip Tie (2)
3" Rubber Trim (1)



Bracket Installation

1. Park your vehicle on a clean flat surface, engage the parking brake.
2. Cut the provided rubber edging in half. Open the hood. Mock up where the brackets will line up with the bolts in the hood hinge. Install the rubber edging to the hood leading edge where the brackets will stick out. **Photo 1**
3. Run the light bar harness through the mount to help keep it away from the wiper arms when they are activated. **Photo 2**

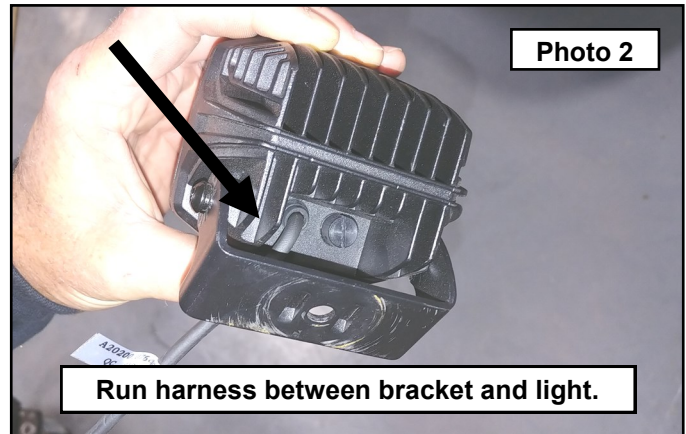
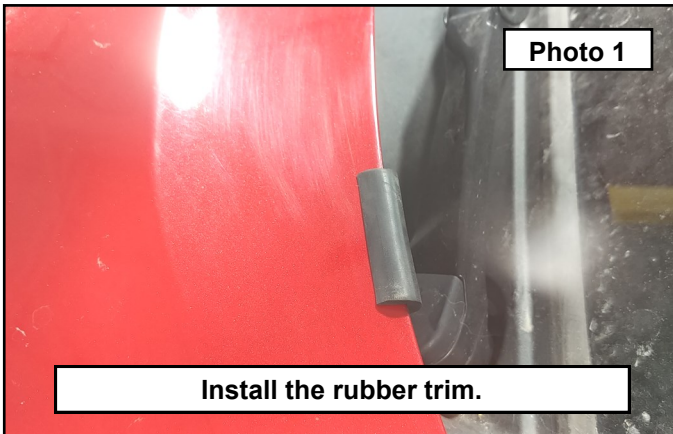

4. Assemble the ditch light brackets and lights with the provided hardware from the light kit. Install the bolts so that the head is as shown. Snug the lights so they are square with the bracket to aid in the installation to the hood mounts. You can adjust later once the brackets are fully installed. **Photo 3**
5. Have an assistant hold the hood while you remove the bolts using a 12mm socket. Discard the hardware. **Photo 4**

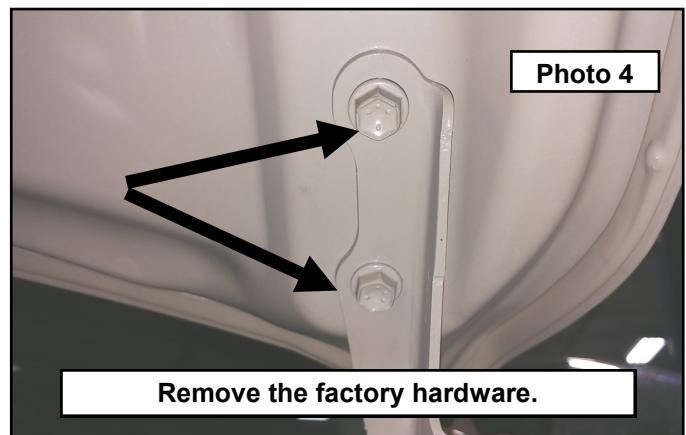
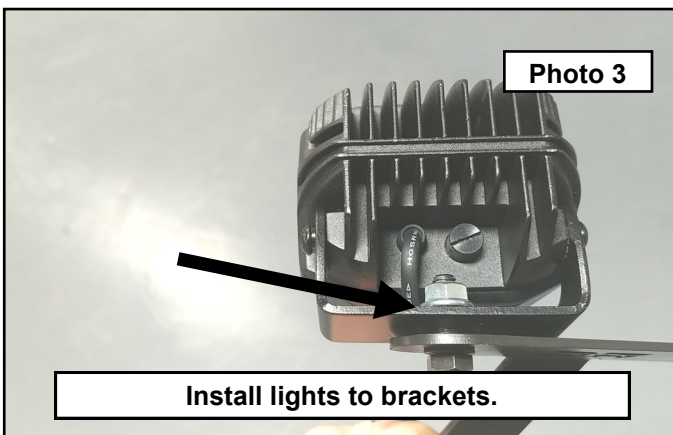

6. Install the light brackets by sliding them between the hood and the windshield. Line up the holes in the bracket, the hood hinge and the hood. Install the brackets using the provided 8mm hardware. Torque to 10 ft-lbs. Route the wires for the lights down the side of the brackets and attach with the provided zip ties to the hole in the bracket. **Photo 5**
7. Run the wires for the lights accordingly. Adjust the lights to preference. **Photo 6**

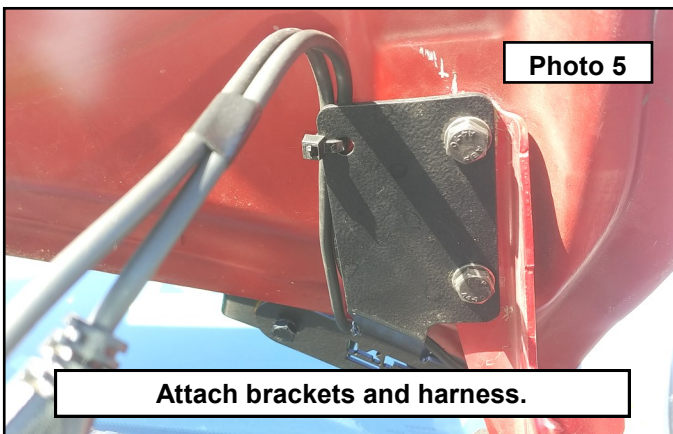

By purchasing any item sold by Rough Country, LLC, the buyer expressly warrants that he/she is in compliance with all applicable, State, and Local laws and regulations regarding the purchase, ownership, and use of the item. It shall be the buyers responsibility to comply with all Federal, State and Local laws governing the sales of any items listed, illustrated or sold. The buyer expressly agrees to indemnify and hold harmless Rough Country, LLC for all claims resulting directly or indirectly from the purchase, ownership, or use of the items.