

# ROUGH COUNTRY

## SUSPENSION SYSTEMS®

924400300

### RAM 2015-18 1500 Crew Cab Raptor Step Kit

Thank you for choosing Rough Country for all your vehicle needs.

Please read instructions before beginning installation. Check the kit hardware against the kit contents shown below. Be sure you have all needed parts and know where they go.

If question exist, please call us @1-800-222-7023. We will be happy to answer any questions concerning this product.

Check all fasteners for proper torque. Check to ensure for adequate clearance between all components.

Periodically check all hardware for tightness.

#### KIT CONTENTS:

- Driver Side Step Rail x1
- Pass Side Step Rail x1
- Driver Side Step Brackets x3
- Passengers Side Step Brackets x3
- Driver Side Gussets x3
- Passengers Side Gussets x3

#### TOOLS NEEDED:

- 10mm Wrench or Socket
- 13mm Wrench or Socket

#### HARDWARE INCLUDED:

- Double Bolt Plate x6
- 6mm x25mm Hex Bolt x12
- 6mm Flat Washers x36
- 6mm Lock washers x12
- 6mm Hex Nuts x12
- 6mm Lock Nuts x12
- 8mm Flat Washers x24
- 8mm Lock Washers x12
- 8mm Nylock Nuts x6
- 8mm Hex Nuts x6
- 8mm x30mm Hex Bolt x18
- Flag Bolt x6
- 8mm Plastic Retainers x6

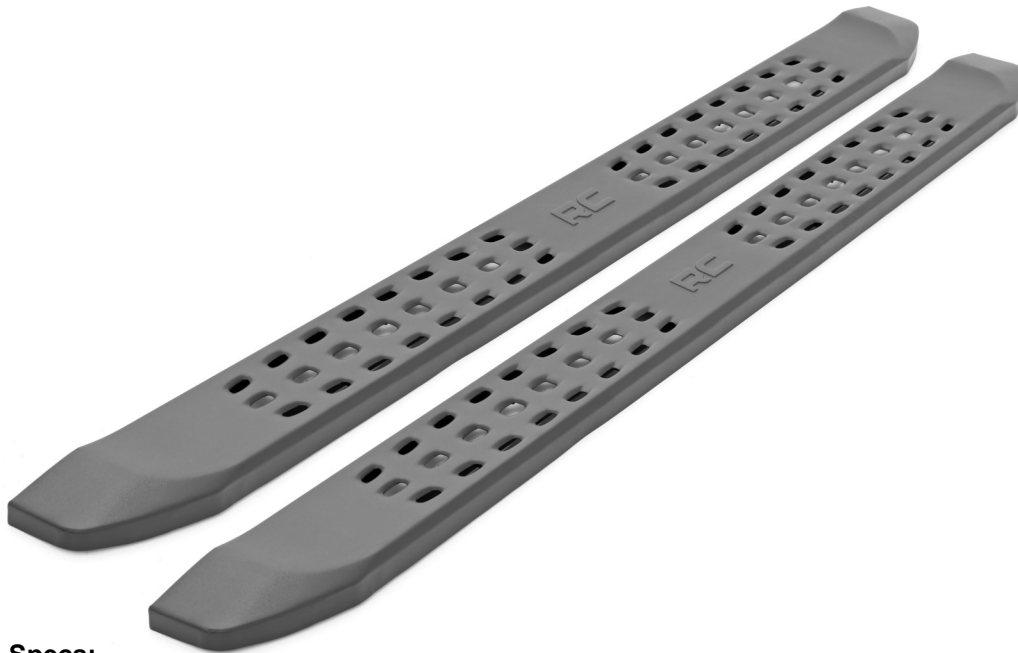

#### Torque Specs:

| Size  | Grade 5   | Grade 8   | Size | Class 8.8 | Class 10.9 |
|-------|-----------|-----------|------|-----------|------------|
| 5/16" | 15 ft/lbs | 20ft/lbs  | 6MM  | 5ft/lbs   | 9ft/lbs    |
| 3/8"  | 30 ft/lbs | 35ft/lbs  | 8MM  | 18ft/lbs  | 23ft/lbs   |
| 7/16" | 45 ft/lbs | 60ft/lbs  | 10MM | 32ft/lbs  | 45ft/lbs   |
| 1/2"  | 65 ft/lbs | 90ft/lbs  | 12MM | 55ft/lbs  | 75ft/lbs   |
| 9/16" | 95 ft/lbs | 130ft/lbs | 14MM | 85ft/lbs  | 120ft/lbs  |
| 5/8"  | 135ft/lbs | 175ft/lbs | 16MM | 130ft/lbs | 165ft/lbs  |
| 3/4"  | 185ft/lbs | 280ft/lbs | 18MM | 170ft/lbs | 240ft/lbs  |



## INSTALLATION INSTRUCTONS

1. Locate (3) bolt plates. **See Photo 1.**
2. Install the (3) bolt plates into the channel of the step. **See Photo 2.**

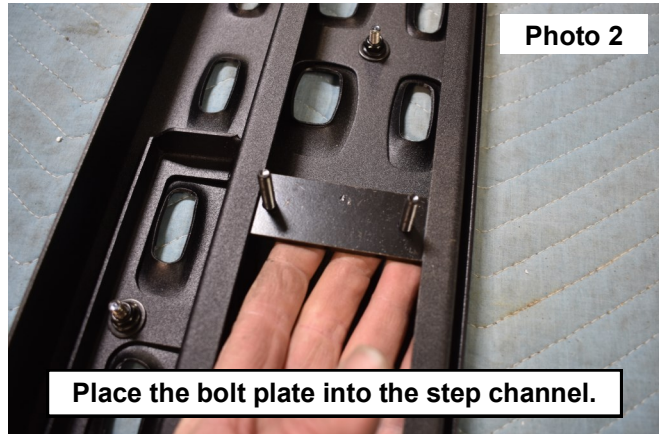
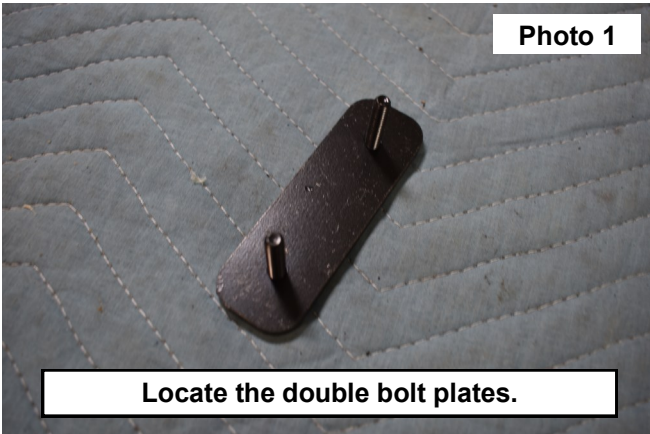

3. Locate the (1) front bracket. This bracket will have the mounting slots toward the front of the vehicle. **See Photo 3.**
4. Place the bolt plate studs into the slots of the step mounting bracket. Secure the step bracket and bolt plate using (2) of the supplied 6mm flat washers (2) 6mm lock washers and (2) 6mm nuts for each of the (3) mounting brackets. **See Photo 4.**

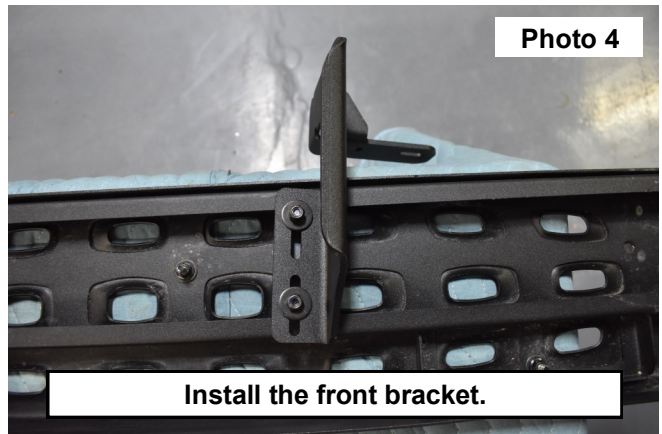
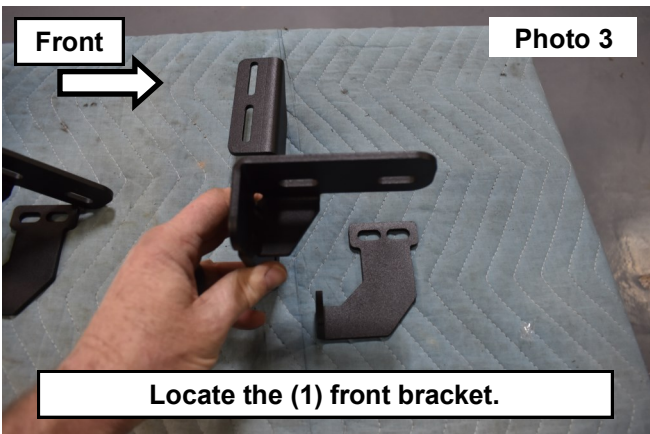

5. Repeat the installation of the (2) bolt plates in the slot for the center and rear step mounting brackets. **See Photo 5.**
6. Locate the rear and center mounts. These brackets will have the slotted mounting holes toward the rear of the vehicle. **See Photo 4.**

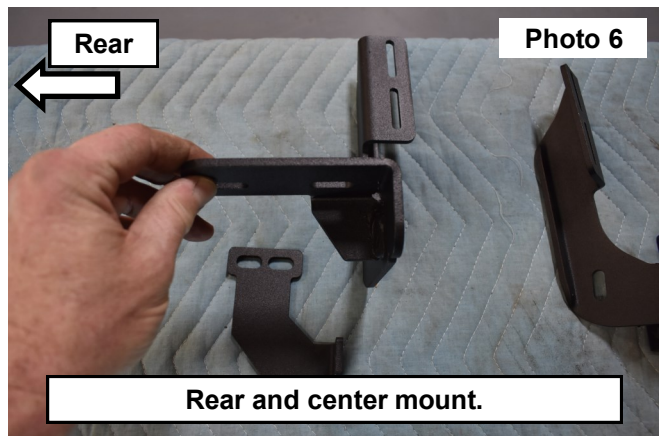
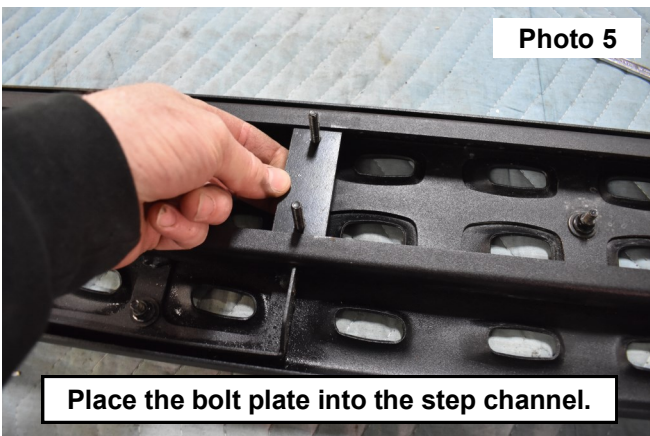

7. Install the slots of the center and rear brackets onto the bolt plate studs installed in the step. Secure the step mounting bracket and bolt plate using (2) of the supplied 6mm flat washers (2) 6mm lock washers and (2) 6mm nuts for each of the (3) mounting brackets. **See Photo 7.**
8. Locate the flag bolt and mounting bolt and nut plate and hardware. **See Photo 8.**

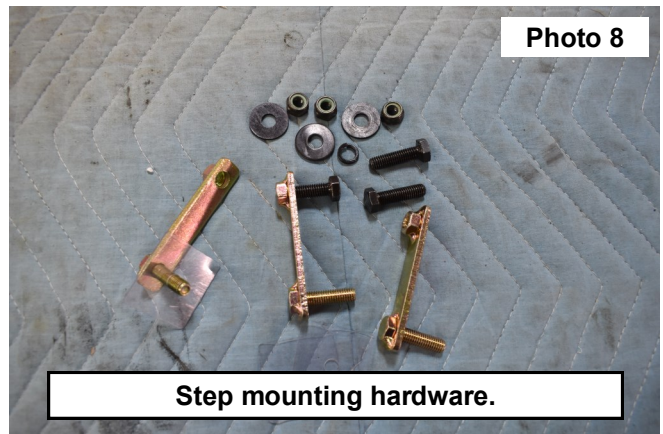
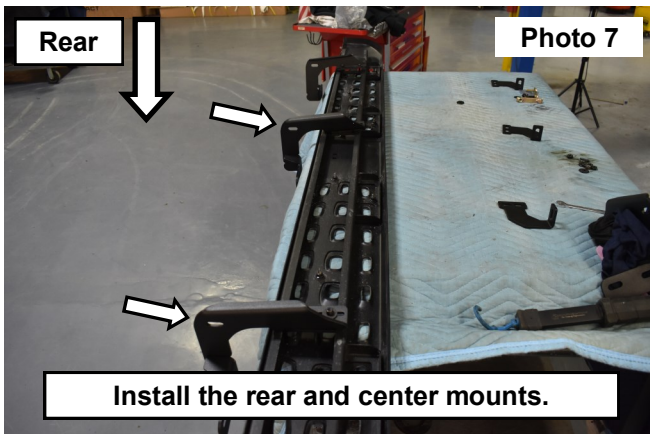

9. Install the flag bolt into the body mounting holes and secure using the clear tabs over the stud. **See Photo 9.**
10. Support the step and install the step brackets on to the mounting hardware. **See Photo 10.**

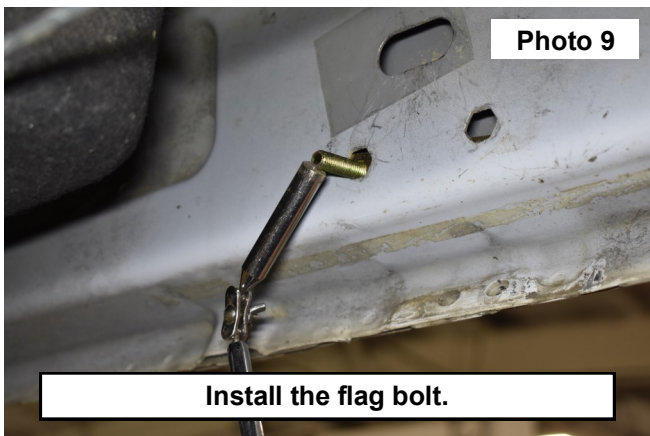

11. Secure the brackets to the vehicle using (2) 8mm flat washers and (2) 8mm nylock nuts on to the stud. Then secure the nut side of the flag bolt using (1) 8mm flat washer, (1) 8mm lock washer and (1) 8mm bolt. Snug the front center and rear brackets using a 13mm socket. **See Photo 11.**
12. Locate the (3) gusset brackets. **See Photo 12.**

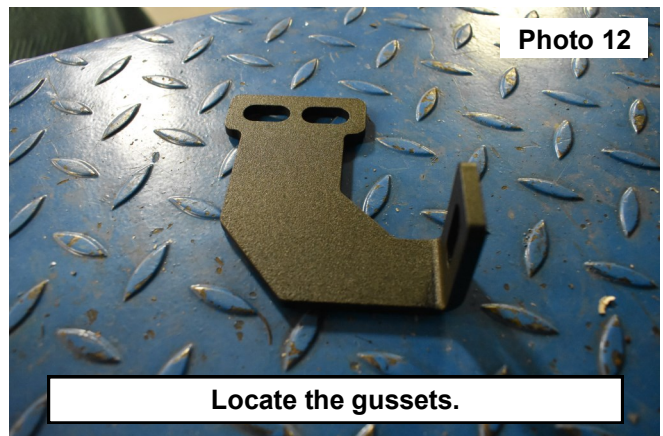

13. Install the gusset to the pinch weld and step bracket using (6) 8mm flat washers (3) 8mm nylock nuts and (3) 8mm hex head bolts. Snug the gusset bracket hardware using a 13mm socket. **See Photo 13.**
14. Center the step plate into the desired position. **See Photo 14.**

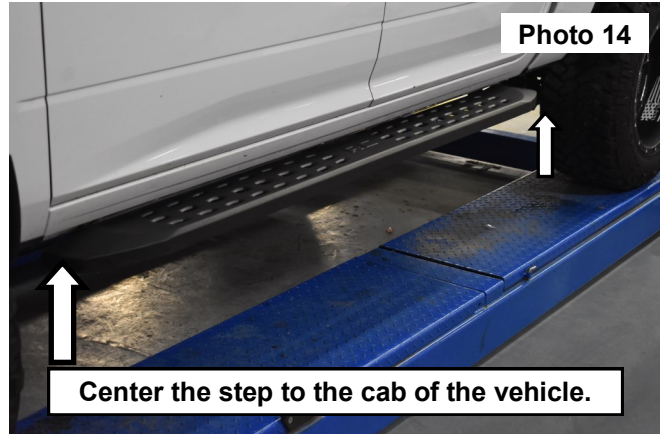
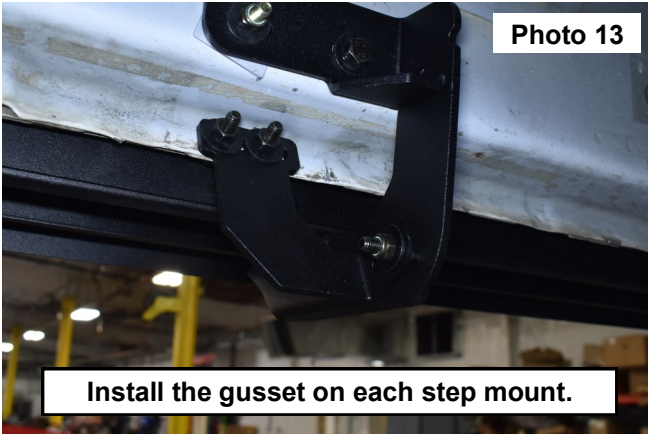

15. Adjust the inside of the step plate within a 1/4" away from the cab of the vehicle. **See Photo 15.**
16. Tighten the lower rocker hardware using a 13mm socket. **See Photo 16.**

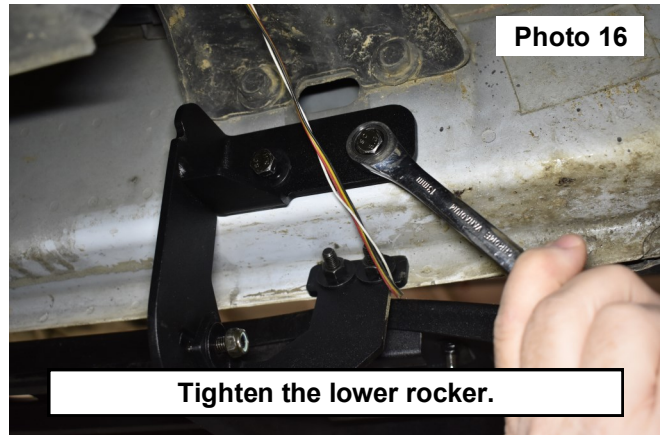
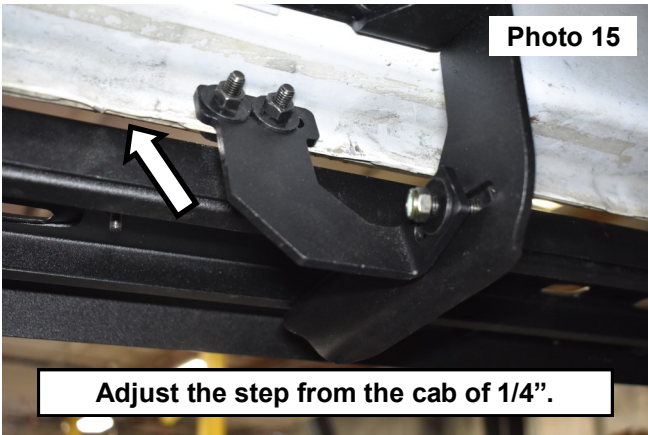

17. Tighten the hardware using a 13mm wrench on each of the (3) mounting brackets. **See Photo 17.**
18. Tighten the (2) nuts in the using a 10mm wrench on each of the (3) mounting brackets. **See Photo 18.**

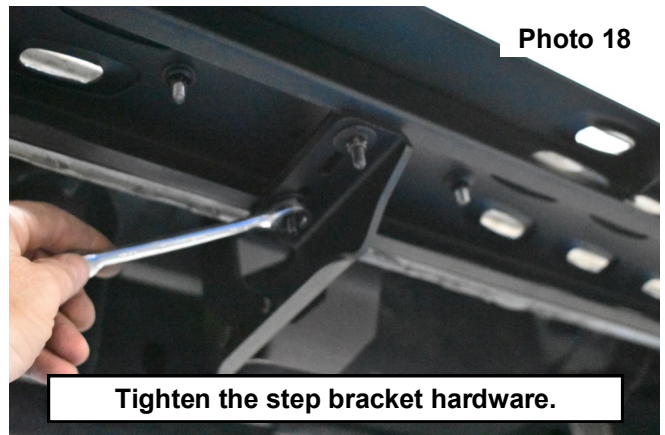

By purchasing any item sold by Rough Country, LLC, the buyer expressly warrants that he/she is in compliance with all applicable, State, and Local laws and regulations regarding the purchase, ownership, and use of the item. It shall be the buyers responsibility to comply with all Federal, State and Local laws governing the sales of any items listed, illustrated or sold. The buyer expressly agrees to indemnify and hold harmless Rough Country, LLC for all claims resulting directly or indirectly from the purchase, ownership, or use of the items.

