

ROUGH COUNTRY

SUSPENSION SYSTEMS®

RAM TRX 1.5" Leveling Kit

Thank you for choosing Rough Country for all your vehicle needs.

Please read instructions before beginning installation. Check the kit hardware against the kit contents shown below. Be sure you have all needed parts and know where they go.

If question exist, please call us @1-800-222-7023. We will be happy to answer any questions concerning this product.

Check all fasteners for proper torque. Check to ensure for adequate clearance between all components.

Periodically check all hardware for tightness.

Kit Contents:

Fr Preload Spacer with Alignment Pin x2
 Fr Preload Spacer without Alignment Pin x2
 Fr Dr Side Sensor Bracket x1
 Fr Pass Side Sensor Bracket x1
 Rear Dr Side Sensor Bracket x1
 Rear Pass Side Sensor Bracket x1
 Rear Coil Spacer x2

Tools Needed:

10mm Socket/Wrench
 13mm Socket/Wrench
 16mm Socket/Wrench
 21mm Socket/Wrench
 30mm Socket/Wrench
 Pliers
 Pry Tool
 T20 Torx Bit

Hardware Included:

6mm x 25mm Bolts x2
 6mm Nylock Nuts x2
 3/8" x 2-1/4" Bolts x4
 3/8" Flat Washers x4
 3/8" Lock Nuts x4



Torque Specs:

Size	Grade 5	Grade 8	Size	Class 8.8	Class 10.9
5/16"	15 ft/lbs	20ft/lbs	6MM	5ft/lbs	9ft/lbs
3/8"	30 ft/lbs	35ft/lbs	8MM	18ft/lbs	23ft/lbs
7/16"	45 ft/lbs	60ft/lbs	10MM	32ft/lbs	45ft/lbs
1/2"	65 ft/lbs	90ft/lbs	12MM	55ft/lbs	75ft/lbs
9/16"	95 ft/lbs	130ft/lbs	14MM	85ft/lbs	120ft/lbs
5/8"	135ft/lbs	175ft/lbs	16MM	130ft/lbs	165ft/lbs
3/4"	185ft/lbs	280ft/lbs	18MM	170ft/lbs	240ft/lbs



FRONT INSTALLATION INSTRUCTIONS

1. Jack up the front of the vehicle and place on jack stands. Remove the wheels.
2. Remove the front skid plate using a 16mm socket/wrench. **See Photo 1.**
3. Unplug the wiring harness for the active terrain struts. **See Photo 2.**

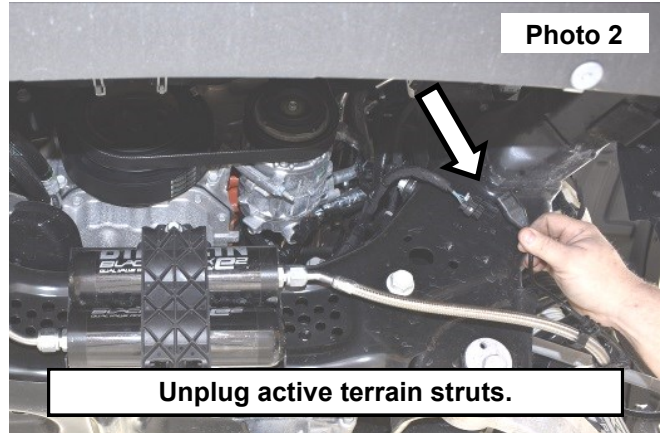
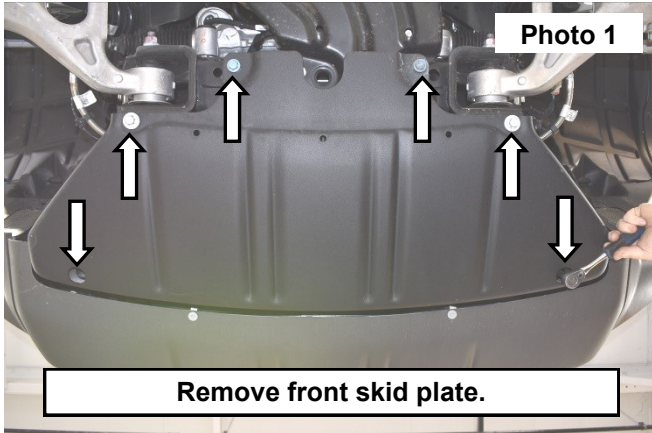

4. Remove bolt from reservoir holder and remove reservoirs using a 13mm socket/wrench. **See Photo 3.**
5. Remove the active sensor arm from the upper control arm using a 10mm wrench. **See Photo 4.**

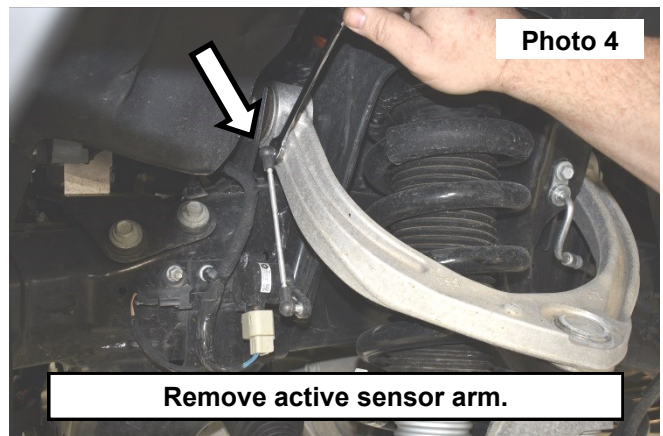
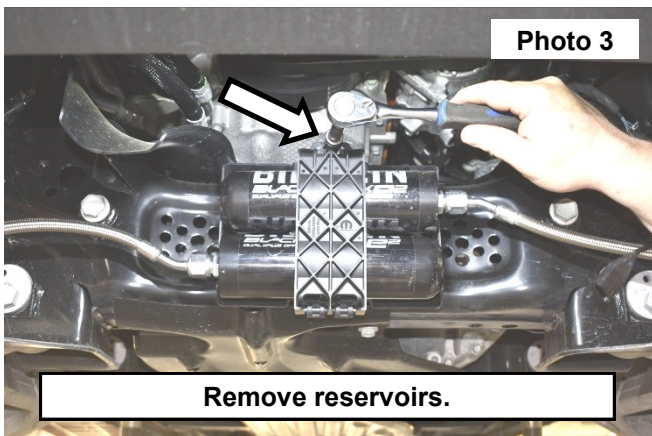

6. Remove the tie rod end using a 21mm wrench and 10mm wrench. **See Photo 5.**
7. Loosen the upper ball joint nut at the knuckle using a 21mm wrench. **See Photo 6.**

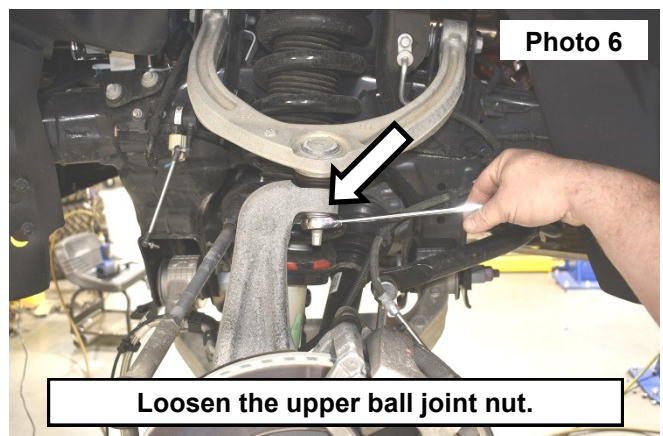
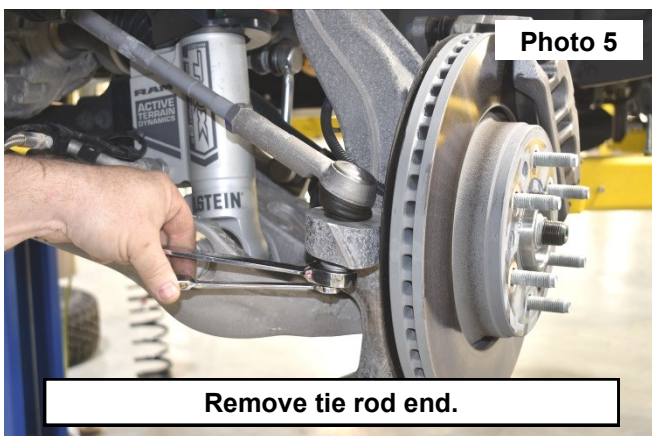

8. Strike the knuckle to unseat the taper. Then remove the nut from the ball joint and separate from the knuckle. **See Photo 7.**
9. Remove the sway bar link from the lower control arm using a 21mm wrench. **See Photo 8.**

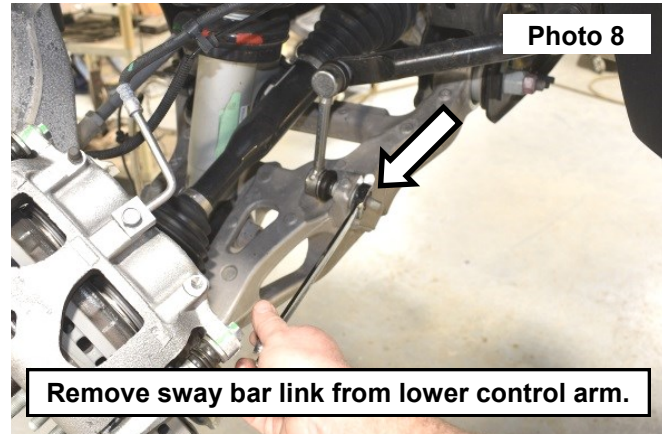
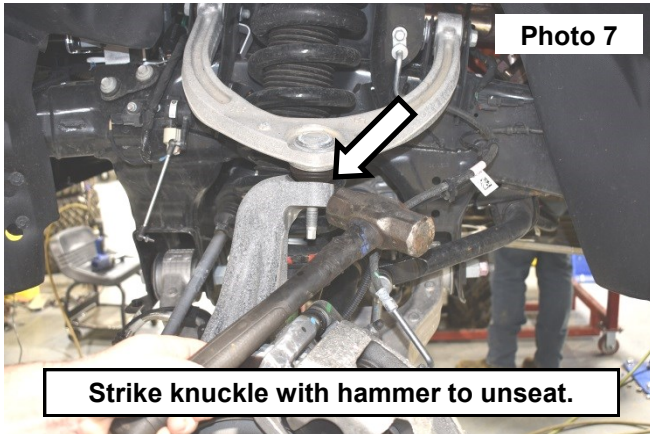

10. Remove the lower strut mount bolt using two 30mm socket/wrenches. **See Photo 9.**
11. Loosen the upper control arm using a 21mm wrench but do not remove (this helps remove the strut). **See Photo 10.**

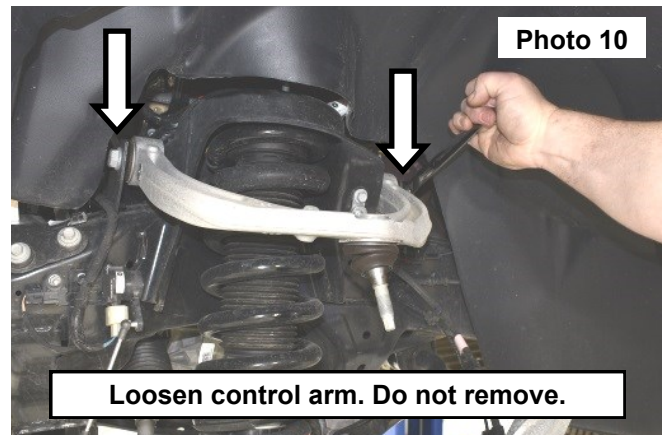
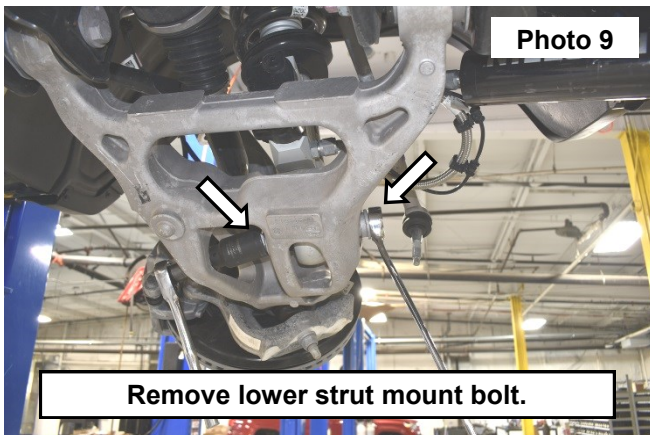

12. Remove the wiring harness clips from the upper strut bolts using a pry tool. **See Photo 11.**
13. Remove the upper strut bolts using a 16mm wrench. **See Photo 12.**

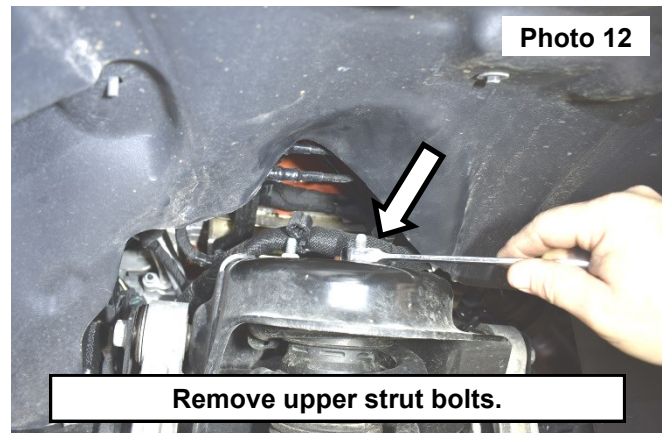
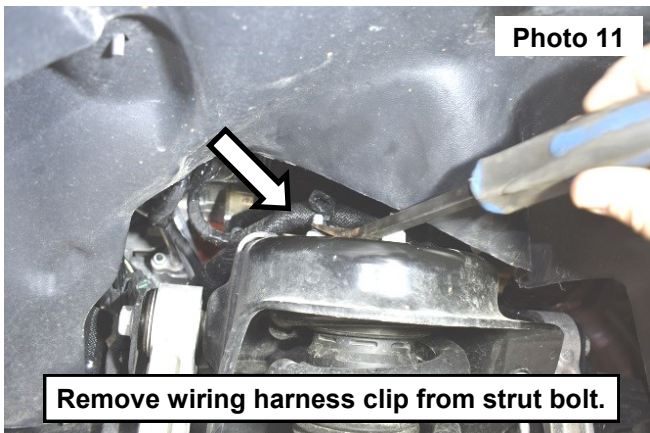

14. Raise the upper control arm, lower the lower control arm, and remove the strut from vehicle. **See Photo 13.**

NOTE: Be careful of CV axle when remove the strut.

15. Place the strut in a coil compressor and remove the bolt using a 21mm socket. **See Photo 14.**

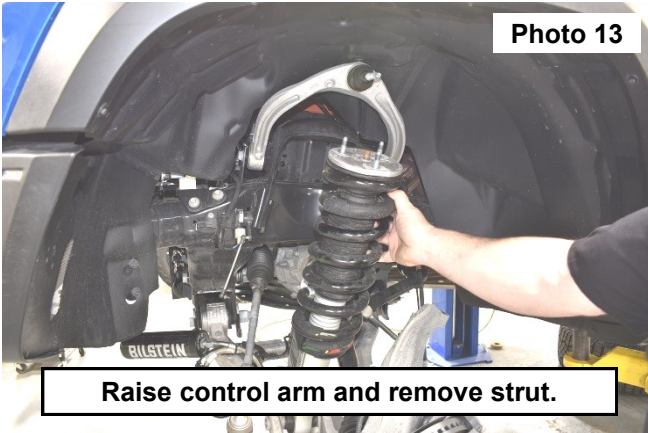

16. Release the coil compressor and remove the upper strut hat. **See Photo 15.**

17. Pull the spring isolator down to make room for the preload spacer. **See Photo 16.**

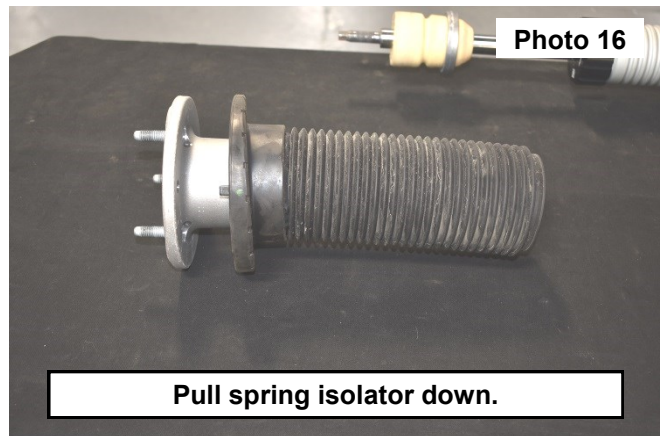

18. Place the preload spacer between the upper strut hat and spring isolator. **See Photo 17 and Photo 18.**

NOTE: Make sure the locating pin is in the correct spot.

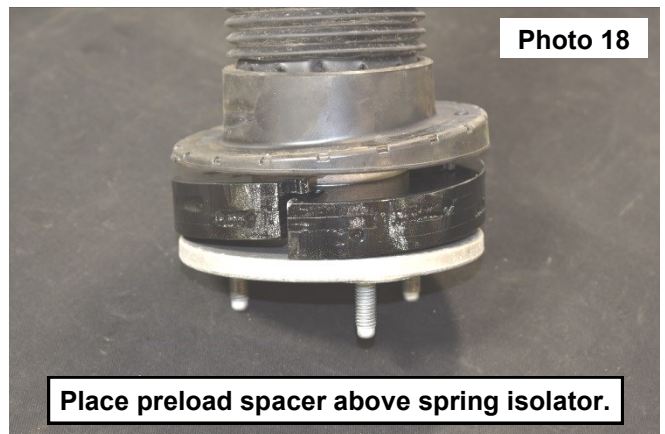
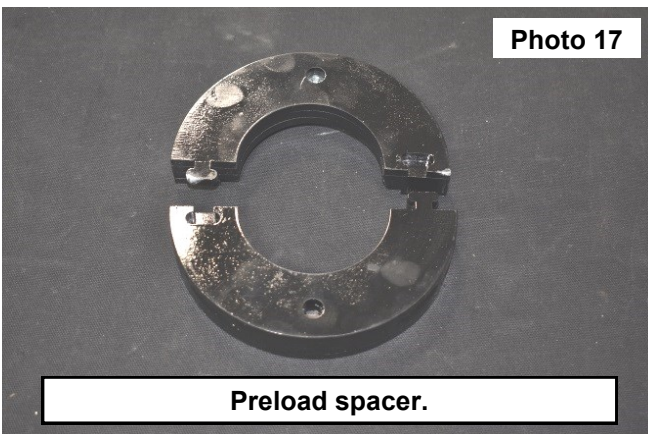

19. Reassemble the strut in the strut compressor and reinstall on vehicle. **See Photo 19.**

20. Unplug the active sensor and remove wiring harness clip from stud. **See Photo 20.**

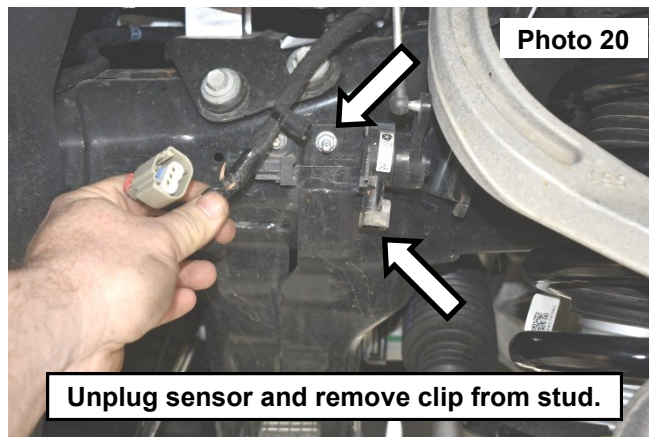
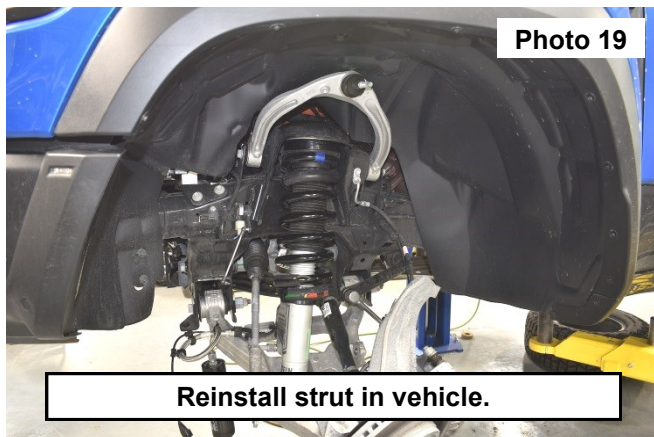

21. Remove the active sensor bracket using a 10mm socket/wrench. **See Photo 21 and Photo 22.**

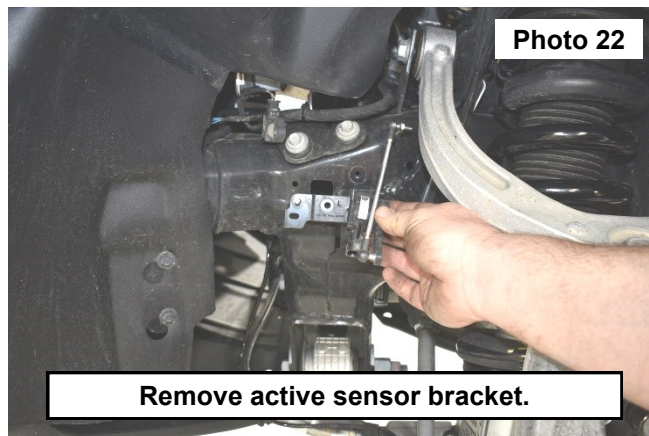
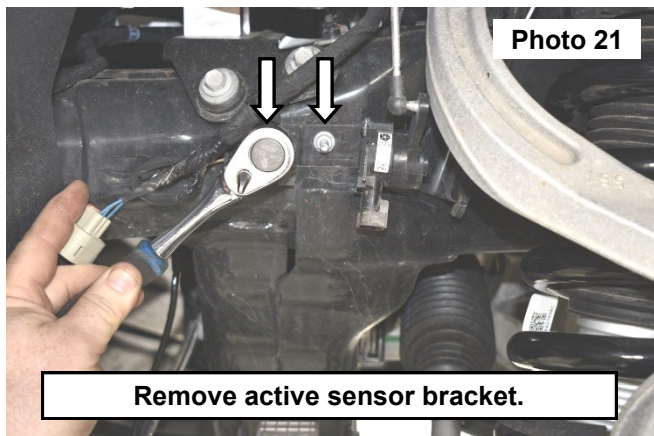

22. Remove the sensor from the bracket using a T20 Torx bit. **See Photo 23.**

23. Install the sensor to the new bracket using the stock hardware. **See Photo 24.**

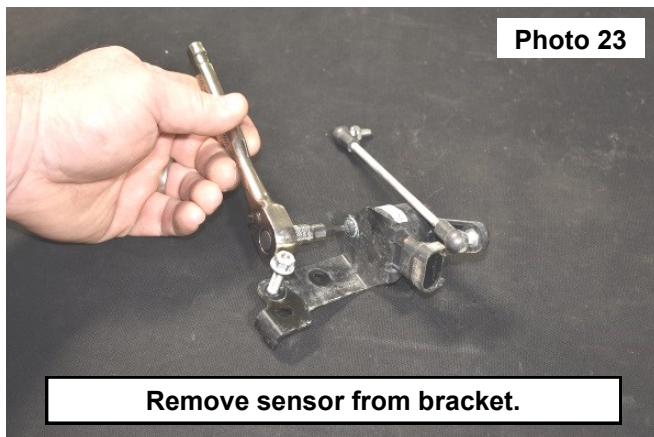

24. Reinstall the active sensor bracket to the vehicle using stock hardware, do not tighten. Attach the black plug to the bracket using the supplied 6mm bolt and nut. Plug in sensor, and reconnect to upper control arm. **See Photo 25.**

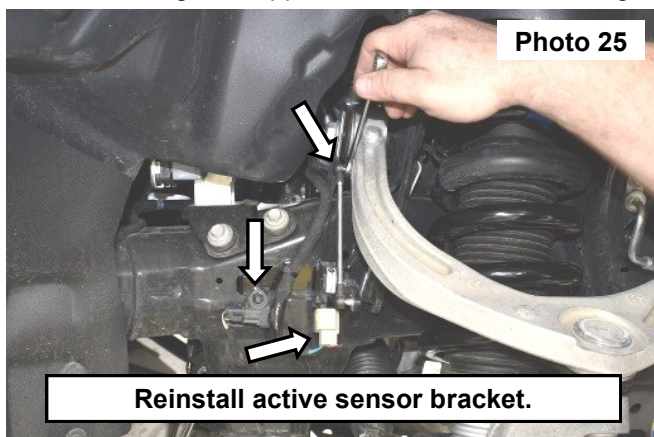

25. Reassemble front suspension in reverse order of tear down.
26. Put on wheels and lower.

REAR INSTALLATION INSTRUCTIONS

1. Jack up the rear of the vehicle and place on jack stands. Remove the rear wheels.
2. Remove the track bar bolt from the axle using a 21mm socket/wrench. **See Photo 1.**
3. Remove the active sensor from the upper control arm using a pair of pliers. **See Photo 2.**

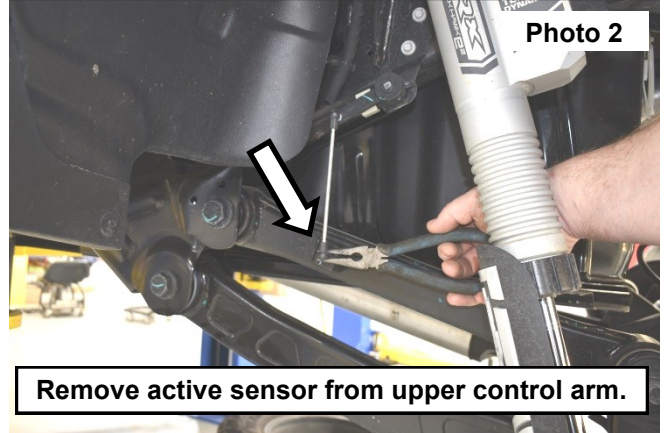
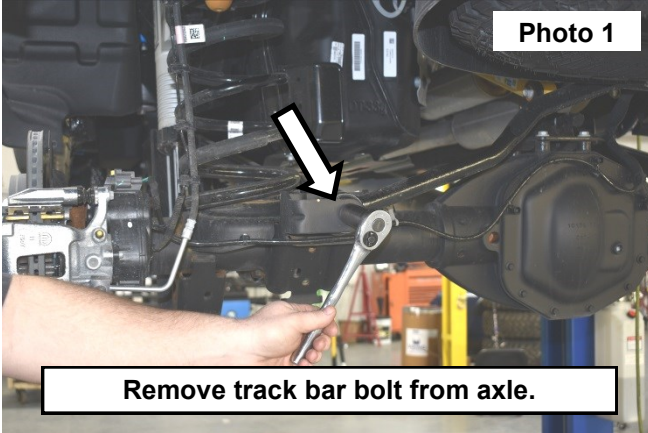

4. Unplug the active sensor and remove bracket from vehicle using a 10mm socket/wrench. **See Photo 3.**
5. Remove the active sensor from the bracket using a T20 Torx bit. **See Photo 4.**

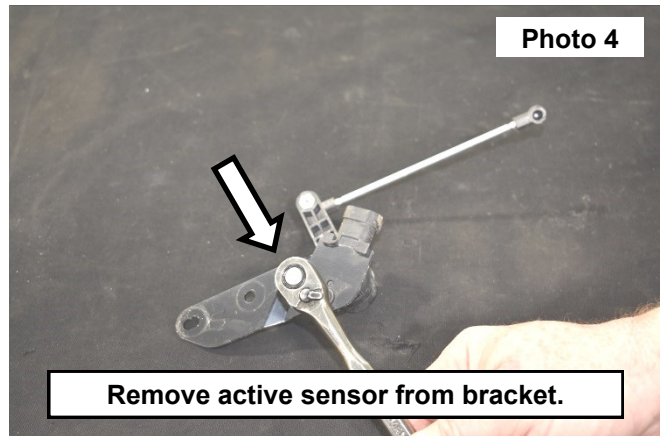
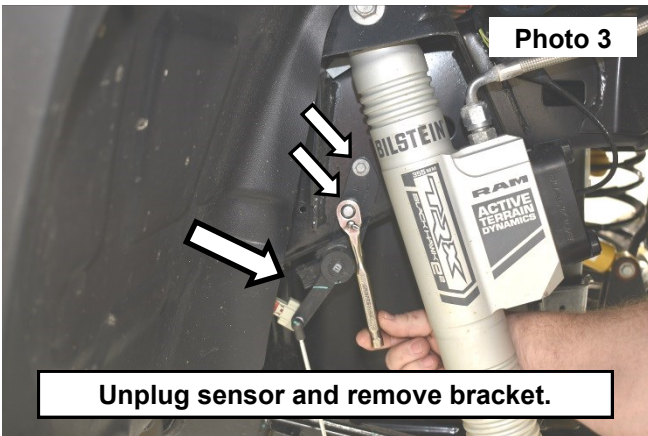

6. Install the active sensor to the new bracket using the stock hardware. **See Photo 5.**
7. Reinstall the sensor bracket to the vehicle using the stock hardware and reconnect the harness. **See Photo 6.**

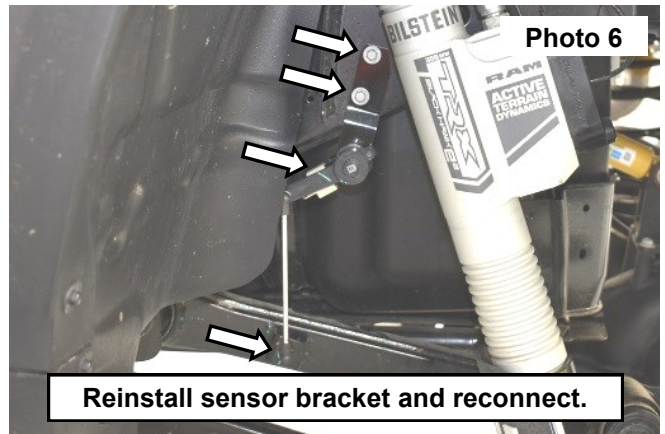
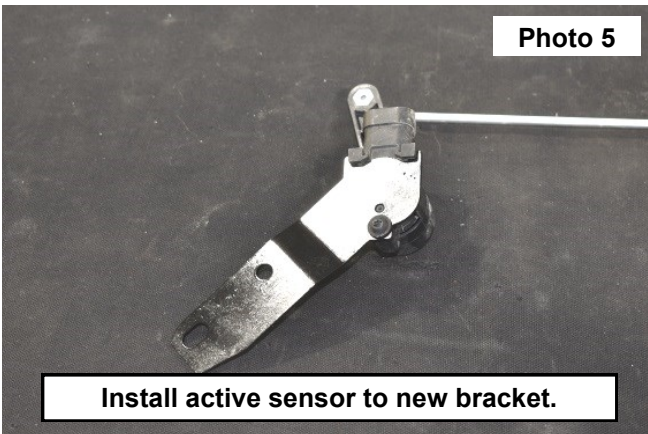

8. Remove the lower shock bolt using two 21mm socket/wrenches. **See Photo 7.**
9. Remove the coil spring and rubber isolator. **Take note of isolator pin orientation.** **See Photo 8.**

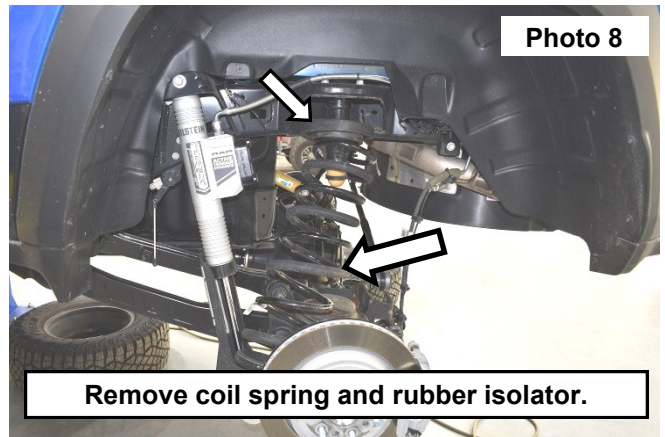
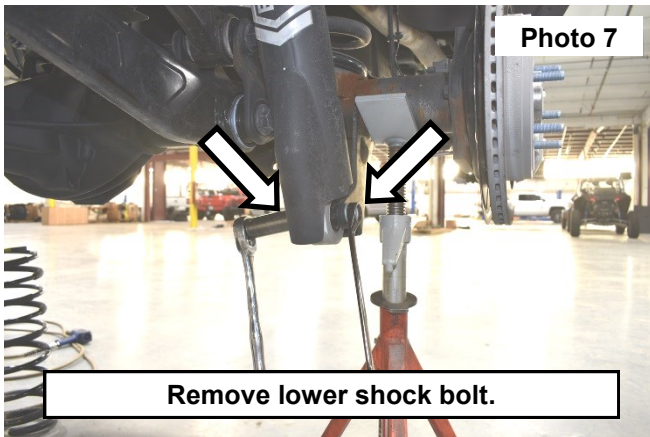

10. Remove the reservoir hose clip from stud using a pry tool. **See Photo 9.**
11. Remove the bump stop using a 16mm wrench. **See Photo 10.**

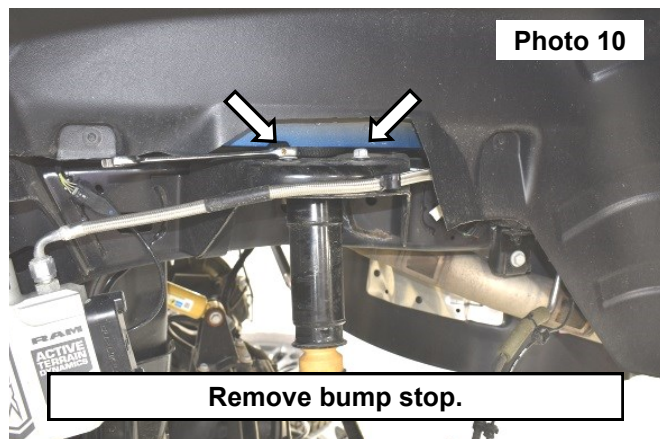

12. Place the stock nut on the bump stop studs and tap with a hammer to remove studs. **See Photo 11.**
13. Install the supplied spacer to the bump stop using the supplied 3/8" x 2-1/4" bolts. **See Photo 12.**

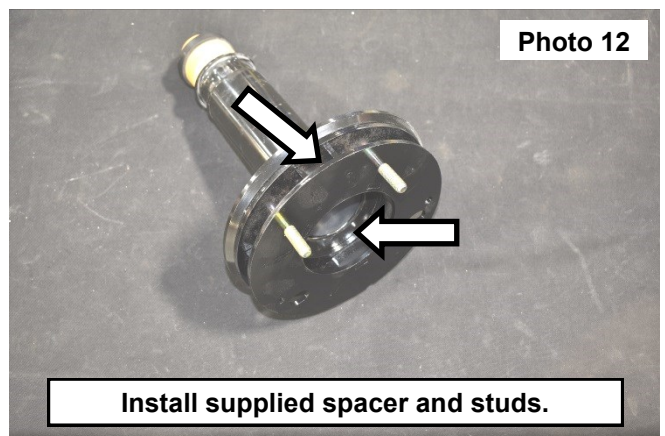
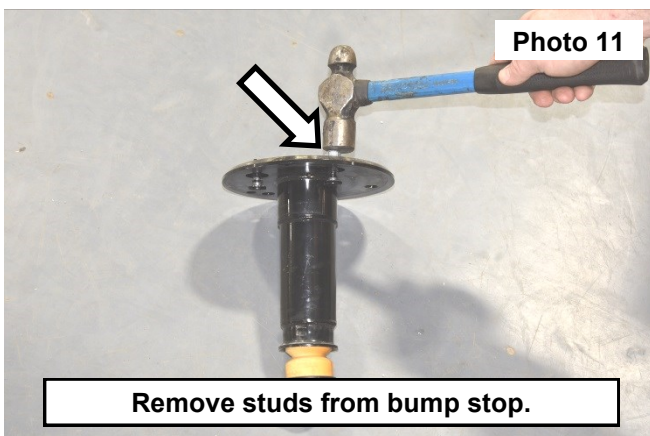

14. Install the bump stop with the spacer using two 9/16" (14mm) socket/wrenches. **See Photo 13.**
15. Reinstall the rubber isolator (aligning the rubber pin) and coil spring. **See Photo 14.**

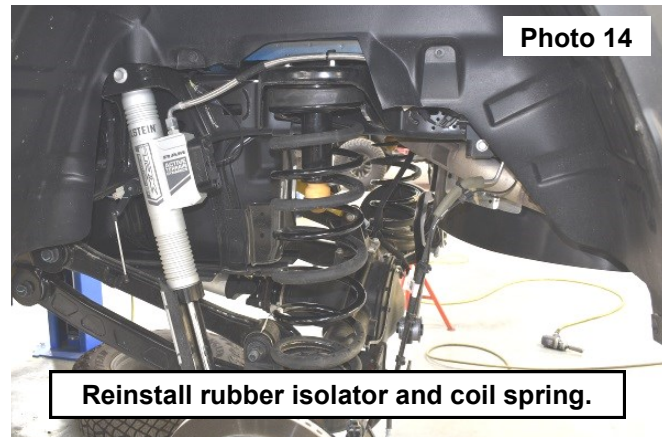
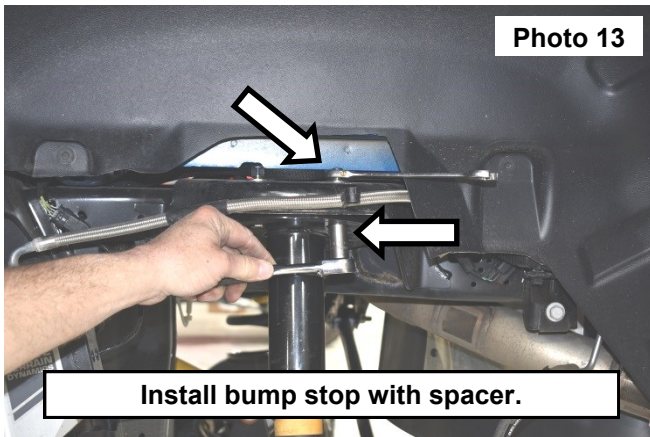

16. Reassembly rear suspension in reverse order of tear down.
17. Put on wheels and lower.

By purchasing any item sold by Rough Country, LLC, the buyer expressly warrants that he/she is in compliance with all applicable, State, and Local laws and regulations regarding the purchase, ownership, and use of the item. It shall be the buyers responsibility to comply with all Federal, State and Local laws governing the sales of any items listed, illustrated or sold. The buyer expressly agrees to indemnify and hold harmless Rough Country, LLC for all claims resulting directly or indirectly from the purchase, ownership, or use of the items.

