

9210786A00

ROUGH COUNTRY

SUSPENSION SYSTEMS®

RAM 2500/3500 2010-21 REAR BUMPER

Thank you for choosing Rough Country for all your vehicle needs.

Please read instructions before beginning installation. Check the kit hardware against the kit contents shown below. Be sure you have all needed parts and know where they go.

If question exist, please call us @1-800-222-7023. We will be happy to answer any questions concerning this product. Check all fasteners for proper torque. Check to ensure for adequate clearance between all components.

Periodically check all hardware for tightness.

KIT CONTENTS:

1-Rear Bumper
 1-Flush Mount LED Light Kit
 19-UP 2500/3500 Sensor Ext Harness x4
 09-18 1500/10-18 2500 Sensor Ext Harness x2

TOOLS NEEDED:

10mm wrench or socket
 13mm Wrench or Socket
 15mm wrench and socket
 18mm wrench and socket
 2.5mm allen wrench
 Ratchet

HARDWARE INCLUDED:

14-4mm x 10mm Button Screw
 4-4mm Flat Washer
 2-4mm Hex Nut
 2-4mm Lock Washer
 4-8mm x 40mm Hex Bolt
 4-8mm Lock Washer
 4-8mm Flat Washer
 8-12mm Lock Nut
 8-12mm x 50mm Hex Bolt
 16-12mm Flat Washer
 4-Rubber Caps
 4-Plastic Retainer Caps



Torque Specs:

| Size | Grade 5 | Grade 8 | Size | Class 8.8 | Class 10.9 |
|-------|-----------|-----------|------|-----------|------------|
| 5/16" | 15 ft/lbs | 20ft/lbs | 6MM | 5ft/lbs | 9ft/lbs |
| 3/8" | 30 ft/lbs | 35ft/lbs | 8MM | 18ft/lbs | 23ft/lbs |
| 7/16" | 45 ft/lbs | 60ft/lbs | 10MM | 32ft/lbs | 45ft/lbs |
| 1/2" | 65 ft/lbs | 90ft/lbs | 12MM | 55ft/lbs | 75ft/lbs |
| 9/16" | 95 ft/lbs | 130ft/lbs | 14MM | 85ft/lbs | 120ft/lbs |
| 5/8" | 135ft/lbs | 175ft/lbs | 16MM | 130ft/lbs | 165ft/lbs |
| 3/4" | 185ft/lbs | 280ft/lbs | 18MM | 170ft/lbs | 240ft/lbs |



INSTALLATION INSTRUCTIONS

1. Disconnect the 7 pin connector from the plug on the rear bumper. **See Photo 1.**
2. Disconnect the license plate light plugs on each side of the bumper. **See Photo 2.**

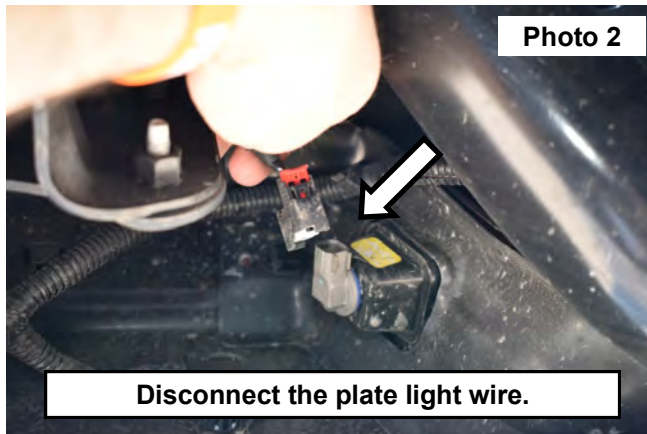
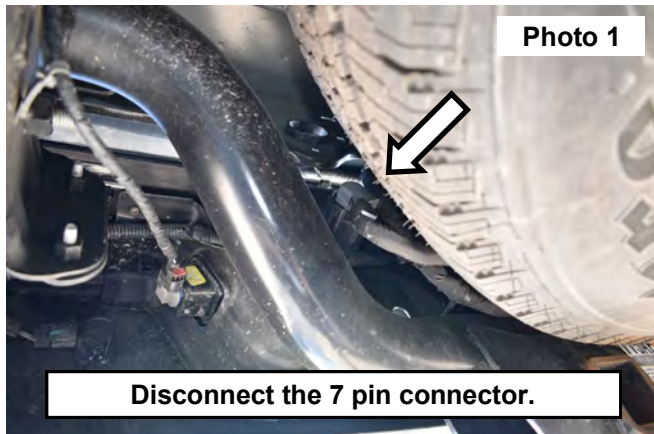

3. Disconnect the proximity sensors 2 on each side of the bumper. **See Photo 3.**
4. Release the proximity sensor wiring harness from the bumper. **See Photo 4.**

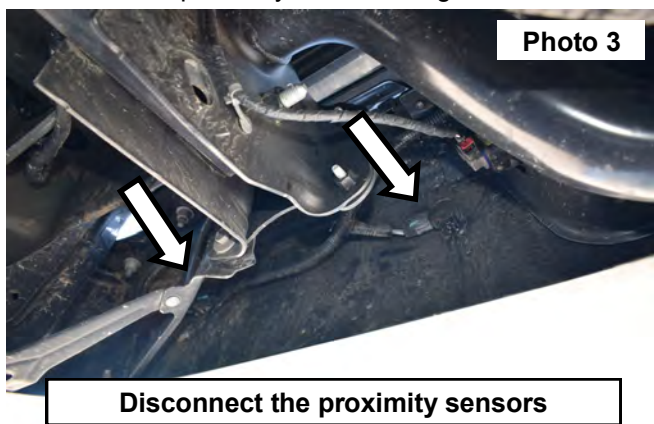

5. Remove the 2 bolts on the back side of the bumper mount using a 15mm socket. **See Photo 5.**
6. Remove the 2 bolts facing the bumper using a 10mm socket or 13mm for 2019-UP. **See Photo 6.**
7. Repeat steps 2-6 on the opposite side of the vehicle.

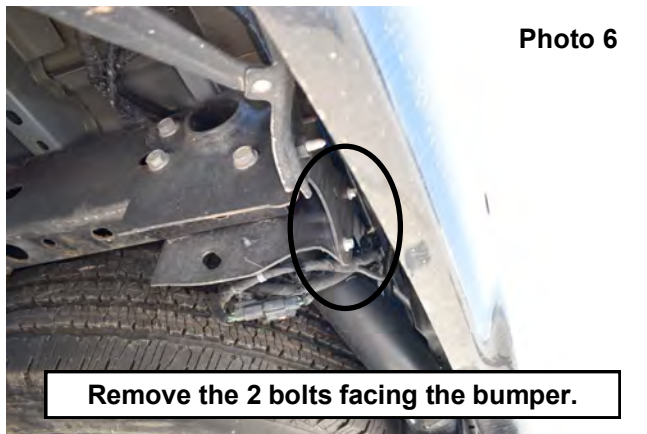
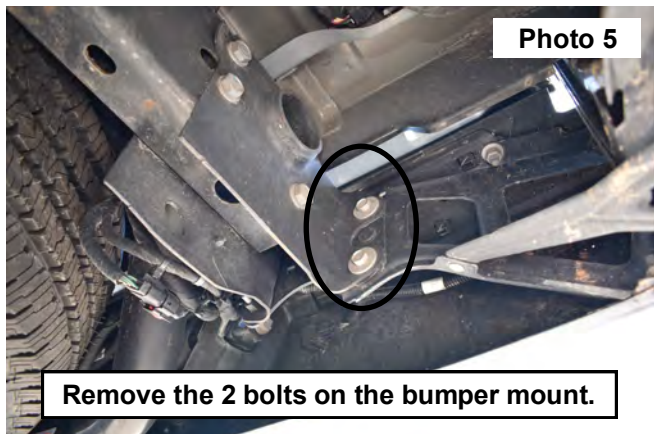

8. Remove the license plate from the bumper.
9. Remove the plastic push pins from the top and remove the nuts in the bottom hole, use a 15mm socket. **See Photo 7.**
10. Remove the bumper. **See Photo 8.**

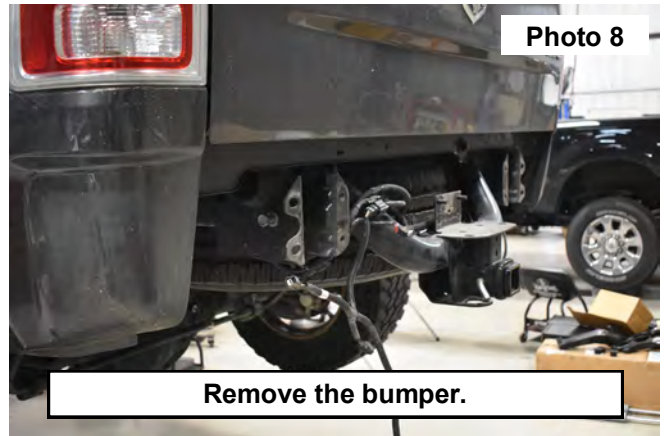
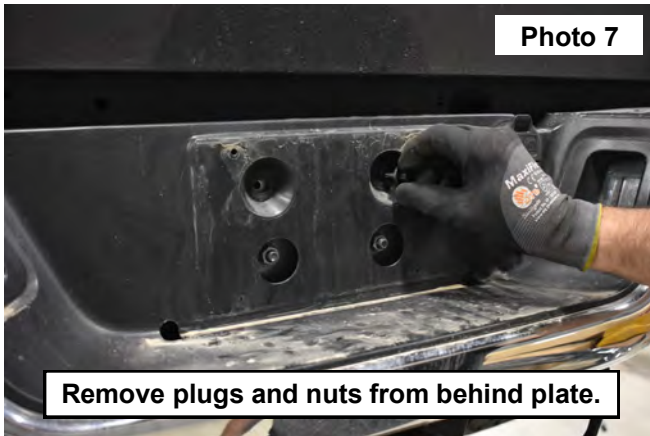

11. Remove the 7 pin plug from the bumper. Squeeze the metal tabs then release. **See Photo 9.**
12. If equipped, unplug and remove the rear TPMS module from bumper. **See Photo 10.**

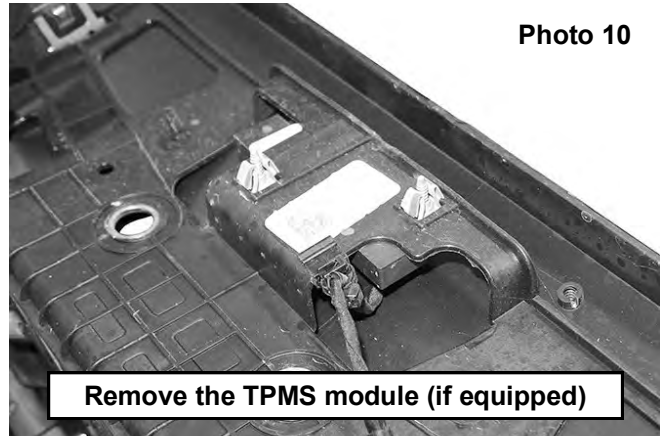
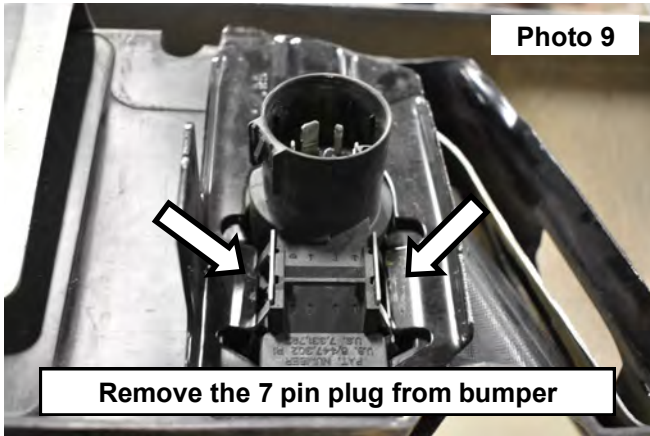

13. Remove the 4 proximity sensors out of the bumper by releasing the clips and pulling straight up. **See Photo 11.**
14. Install the proximity sensors into the new bumper using the supplied 4mm button head bolts to secure the sensor to the bumper. Tighten using a 2.5mm allen wrench slightly to secure the sensor in the bumper. Do not over tighten and damage the sensors. **See Photo 12.**

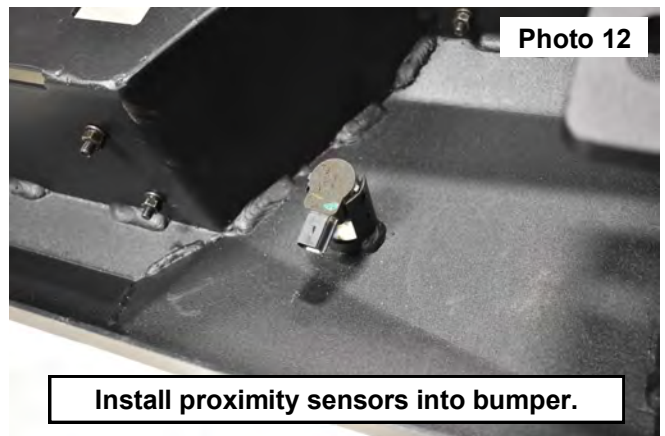
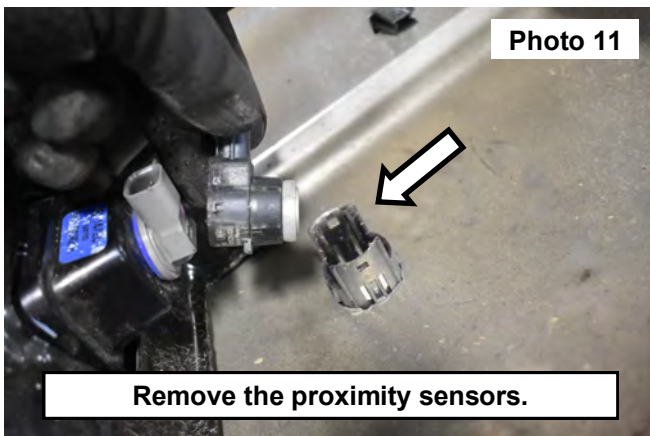

15. Install the 7 pin plug into the bumper, seat the clips into the bumper to secure. **See Photo 13.** It may be necessary to slightly bend the clips using a flat head screwdriver to secure the plug housing in the bumper.

16. Reinstall the TPMS sensor with the supplied 4mm bolts, lock washer, flat washers and nuts. **See Photo 14.**

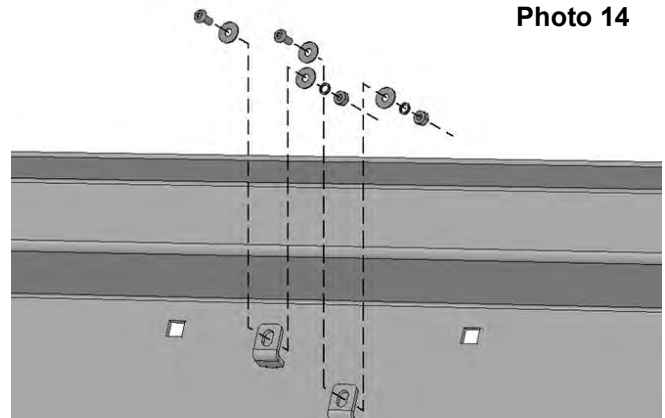
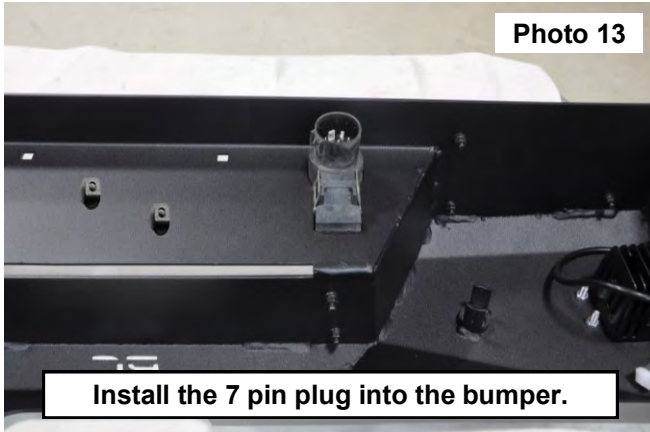

17. Install the 2" flush mount LED lights using the instruction sheets and hardware with those kits. **See Photo 15.**
18. Install the new bumper using the supplied 12mm x 50mm bolts washers flat washers and lock nuts into the bumper and the bumper mount on the vehicle.
19. Align the new bumper evenly with the tail gate edge. **See Photo 16.**
20. **Important Note:** *Check clearance between the tailgate and the bumper when the tailgate is in the lowered position. Adjust as necessary to ensure the bumper does not come into contact with the tailgate. Failure to check this could result in tailgate damage.*

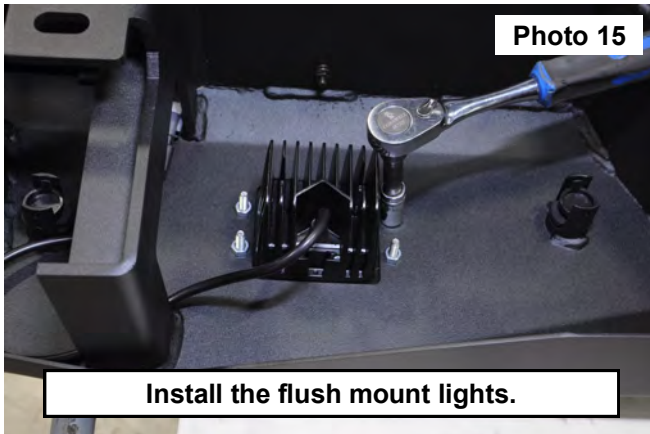

21. Tighten the bumper mount bolts on each side, Torque to 55ft-lbs. using a 18mm wrench and socket. **See Photo 17.**
22. Locate the supplied sensor extension harnesses and connect the 4 proximity sensors and TPMS module installed (if equipped) into the factory wiring harness. Note 09-18 1500/ 10-18 2500/3500 will use 2 sensor extensions for the center two sensors and 19-UP 2500/3500 will use 4 sensor extension harnesses for the center 4 sensors.
23. Install the license plate using the 2 supplied LED lights. These LED tag lights will need to be spliced in to the license plate illumination wire on the factory harness on the vehicle. **See Photo 18.**

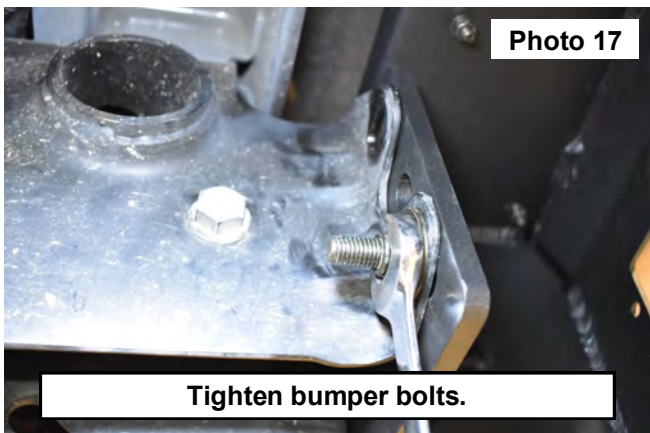

By purchasing any item sold by Rough Country, LLC, the buyer expressly warrants that he/she is in compliance with all applicable, State, and Local laws and regulations regarding the purchase, ownership, and use of the item. It shall be the buyers responsibility to comply with all Federal, State and Local laws governing the sales of any items listed, illustrated or sold. The buyer expressly agrees to indemnify and hold harmless Rough Country, LLC for all claims resulting directly or indirectly from the purchase, ownership, or use of the items.