

RAM V8-5.7L 2009-18 / 19 CLASSIC 1500 Cold Air Intake

Thank you for choosing Rough Country for all your vehicle needs.

Please read instructions before beginning installation. Check the kit hardware against the kit contents shown below. Be sure you have all needed parts and know where they go.

If question exist, please call us @1-800-222-7023. We will be happy to answer any questions concerning this product.

Check all fasteners for proper torque. Check to ensure for adequate clearance between all components.

Periodically check all hardware for tightness.

NOTE: This kit was not designed to fit a body lift.

KIT CONTENTS:

- Air Filter x1
- Filter Clamp x1
- Filter Adapter x1
- Coupler Clamps x3
- Intake Pipe Coupler x1
- Intake Tube x1
- 90 Deg. Intake Coupler x1
- Intake Clamp x1
- Bracket (Short w/2 Holes) x1
- Bracket (Long w/1 Hole) x1
- 2013 and Newer Panel x1
- 2012 and Older Panel x1
- Outer Heat Shield x1
- Rubber Gasket x1
- Vent Tube Hose x1
- Vent Tube Clamps x2
- Wiring Extension#1 x1
- Wiring Extension #2 x1
- Straight 5/8" Barbed Fitting x1
- 90 degree Barbed Fitting x 1
- Intake Pipe Grommet x1

TOOLS NEEDED:

- 5/16 Socket
- 3/4 Wrench
- Flat Head Screw Driver
- 10mm Socket and Wrench
- 13mm Socket
- Ratchet
- 4mm Allen Wrench

HARDWARE INCLUDED:

- 6mm-1.0 x 16mm Hex Head Bolts x5
- 6mm Flat Washers x8
- 6mm-1.0 Nylock Nuts x3
- 6mm lock washers x 2
- 6mm x 20mm Hex Head Bolt x1
- Spacer for 6mm x20mm bolt x1
- 5mm x8mm bolts x8
- 5mm Flat Washers x8
- Cable Tie x1



Torque Specs:

Size	Grade 5	Grade 8	Size	Class 8.8	Class 10.9
5/16"	15 ft/lbs	20ft/lbs	6MM	5ft/lbs	9ft/lbs
3/8"	30 ft/lbs	35ft/lbs	8MM	18ft/lbs	23ft/lbs
7/16"	45 ft/lbs	60ft/lbs	10MM	32ft/lbs	45ft/lbs
1/2"	65 ft/lbs	90ft/lbs	12MM	55ft/lbs	75ft/lbs
9/16"	95 ft/lbs	130ft/lbs	14MM	85ft/lbs	120ft/lbs
5/8"	135ft/lbs	175ft/lbs	16MM	130ft/lbs	165ft/lbs
3/4"	185ft/lbs	280ft/lbs	18MM	170ft/lbs	240ft/lbs

Figure 1.

2013 and Newer Vehicles.

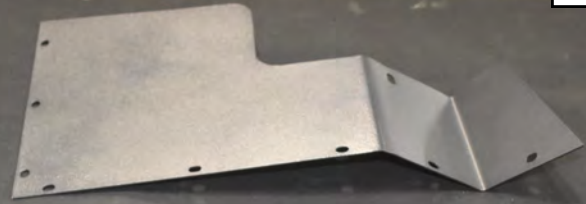

2012 and Older Vehicles.

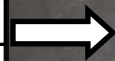

Identify the panel for the year range of the vehicle to be installed.

INSTALLATION INSTRUCTIONS

1. Release the 4 latch levers in the filter lid. **See Photo 1.**
2. Using a 8mm socket loosen the intake clamp and remove the vent tube from the air filter lid. **See Photo 2.**

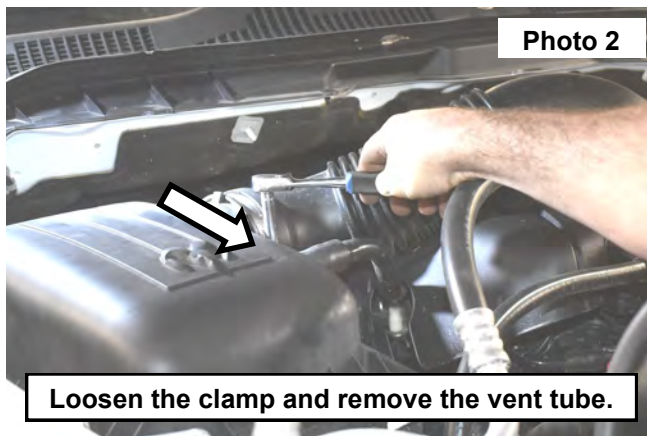
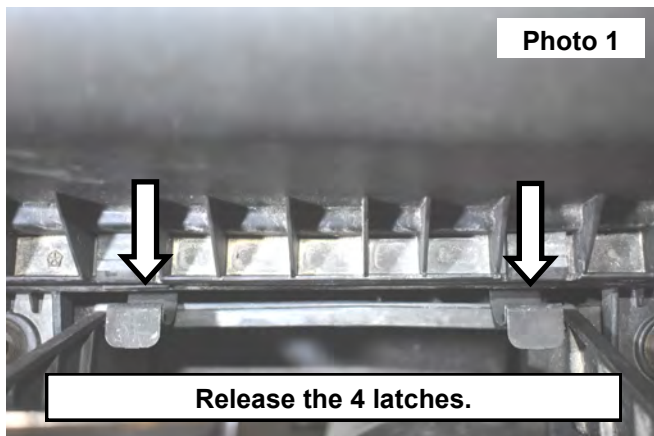

3. Remove the filter lid from the vehicle. **See Photo 3.**
4. Remove the air filter from the air box. **See Photo 4.**

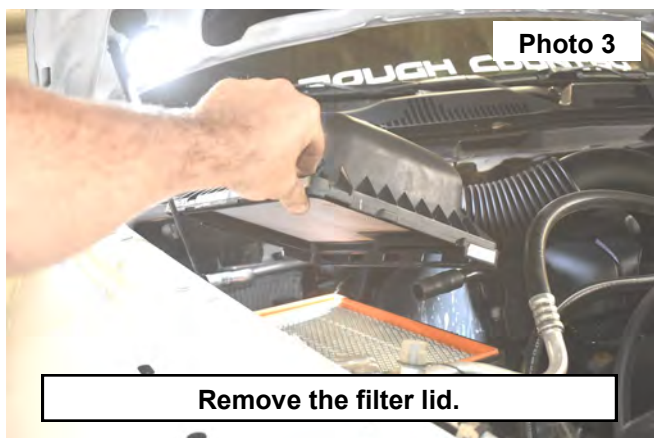

5. Release the rubber gromets on the air box from the inside mount then remove from the vehicle. **See Photo 5.**
6. Release the plug from the sensor on the OE intake. **See Photo 6.**

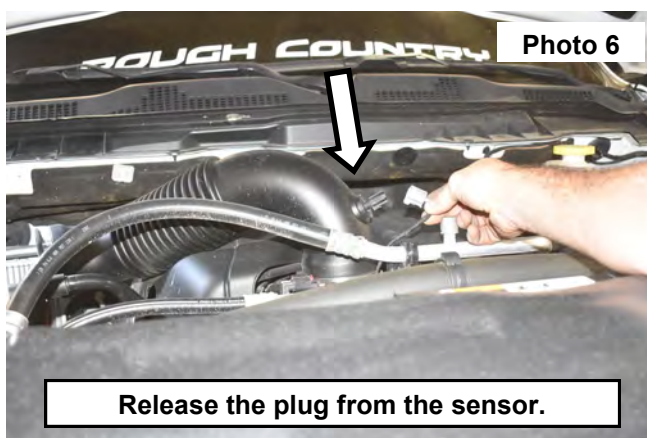
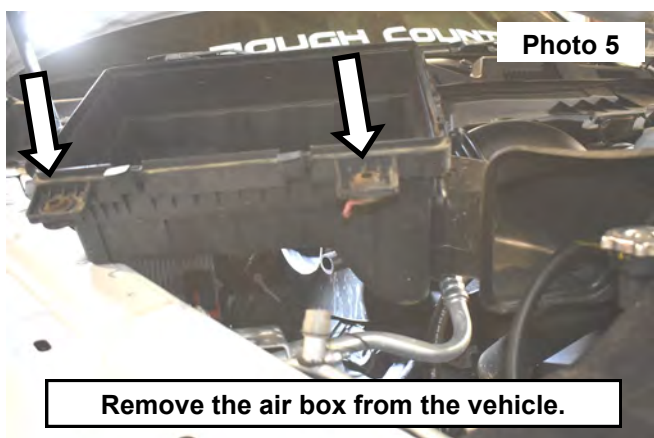

- Using an 8mm socket loosen the clamp around the OE intake tube. **See Photo 7.**
- Remove the intake tube from the vehicle. **See Photo 8.**

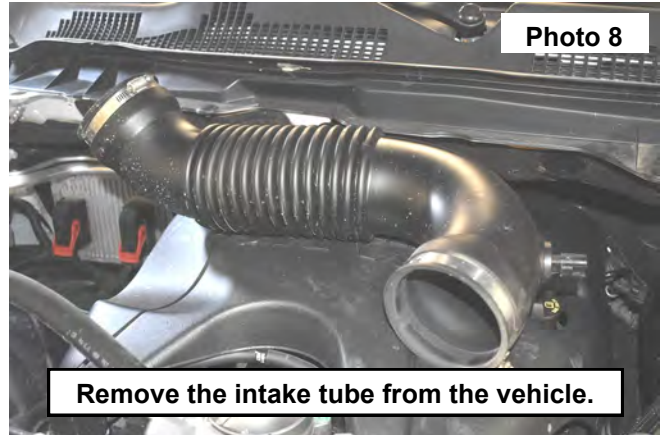
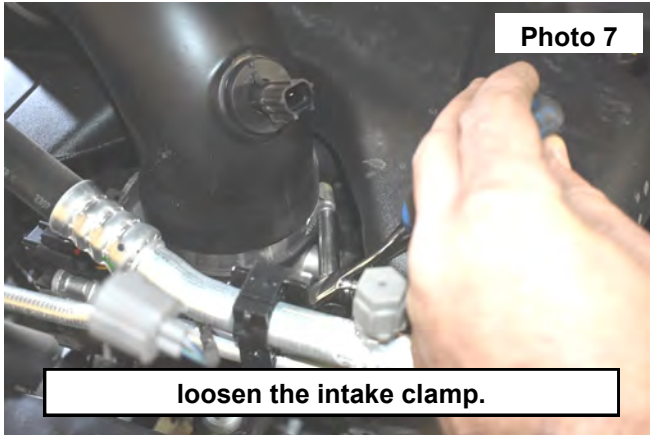

- Remove the engine cover from the vehicle. Retain for reuse. **See Photo 9.**
- Remove the vent tube from the engine. **See Photo 10.**

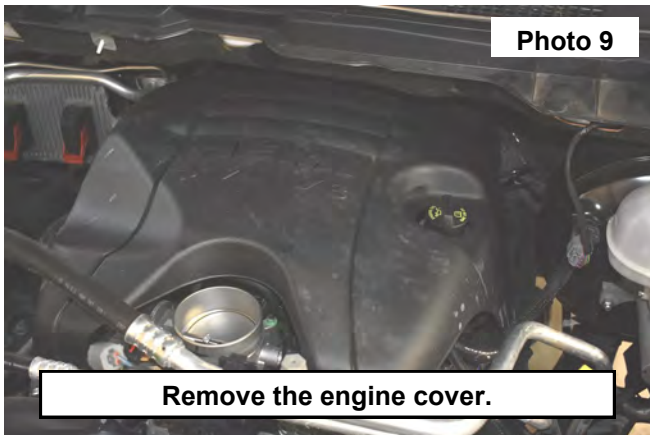

- From the air box side of the intake cut 11" off of the vent tube. **See Photo 11.**
- Install the supplied hose and clamps onto the vent tube and secure using (1) of the supplied hose clamps. **See Photo 12.**

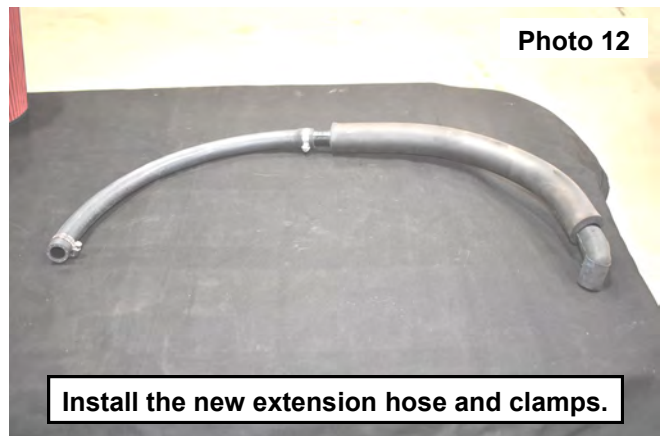
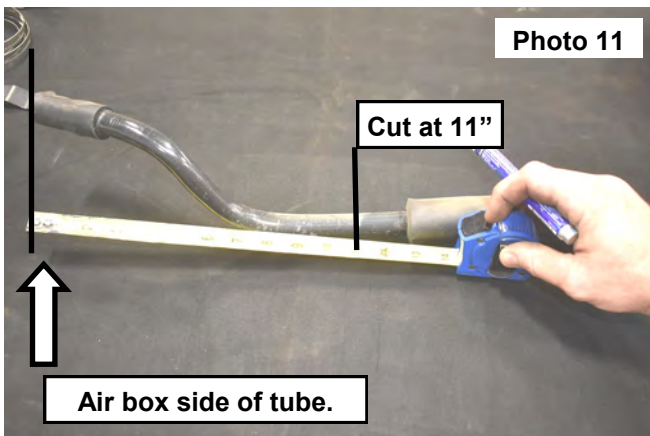

13. Install the vent tube onto the engine in the removed location. **See Photo 13.**

14. Install the engine cover. **See Photo 14.**



15. **▲ NOTICE** Identify the panel for the year range of the vehicle to be installed on the 2nd page of this instruction sheet in **Figure 1**. Using the supplied 5mm hardware install the (8) button head bolts and (8) 5mm flat washers to secure the side panel to the air box. **See Photo 15.**

16. Locate the rubber gasket shown in **Photo 16**.

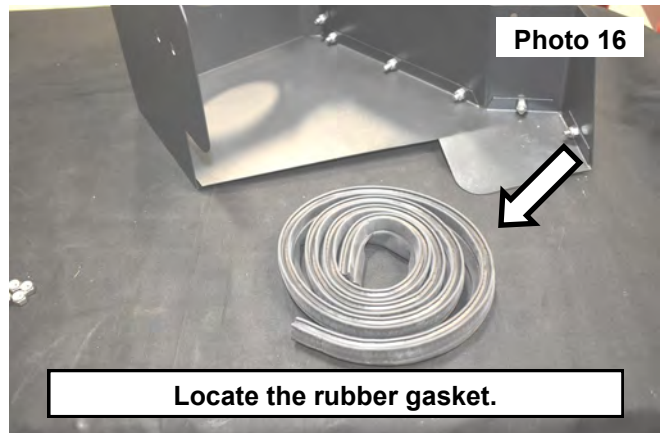
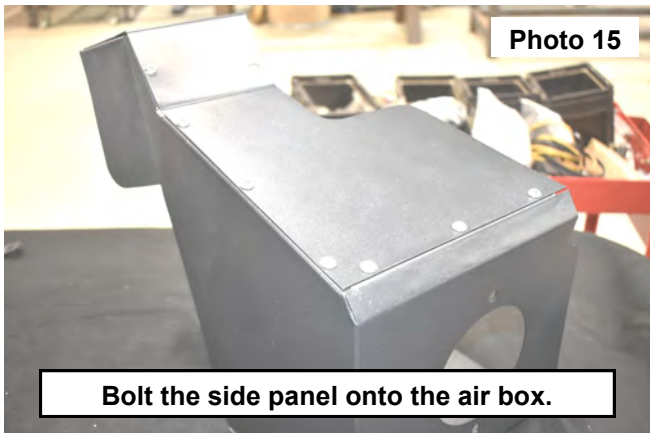

17. Install the rubber gasket onto the edge of the air box. Trim length if needed. **See Photo 17.**

18. Install the air filter adapters mounting flange to the inside of the air box, secure using the supplied 6mm hex head bolts, 6mm lock washers and 6mm flat washers. **See Photo 18.**

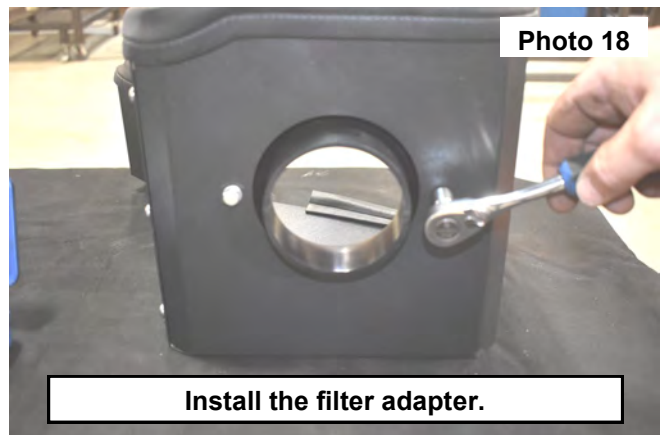

19. Locate the (2) supplied mounting brackets shown in **Photo 19**.
20. Install the shorter bracket with 2 mounting holes onto the inside of the air box using (2) of the supplied 6mm Hex head bolts 6mm flat washers and 6mm nylock nuts. **See Photo 20**.

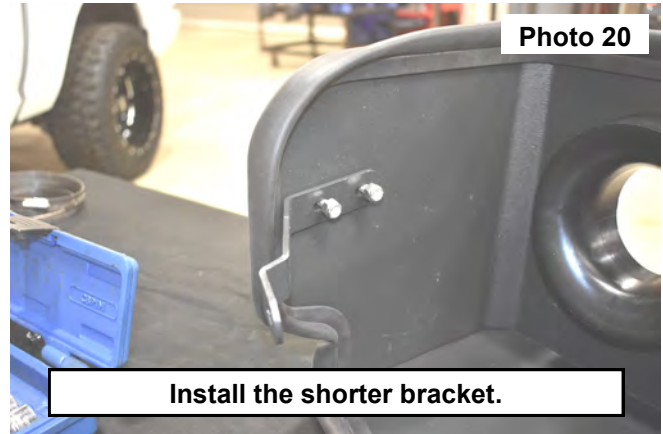
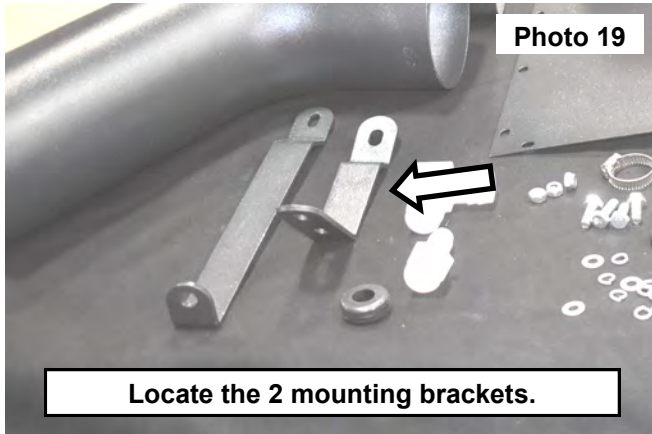

21. Install the spacer and the longer bracket onto the outer side of the air box with the supplied 6mm x 20mm bolt, flat washers and lock nuts. **See Photo 21**.
22. Remove the front bolt in the fender mount using a 13m wrench. Retain hardware for reuse. **See Photo 22**.

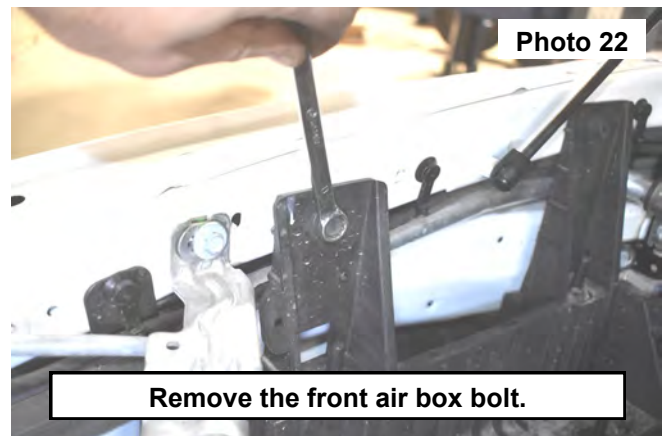
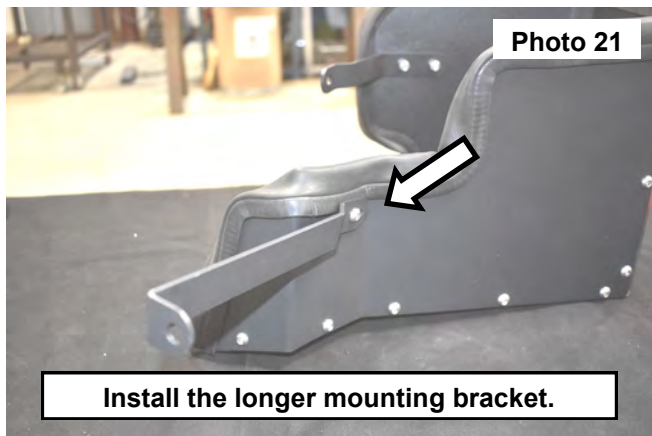

23. Remove the lower bolt in the front of the inner structure of the vehicle. Retain hardware for reuse. **See Photo 23**.
24. Install the new air box into the vehicle. **See Photo 24**.

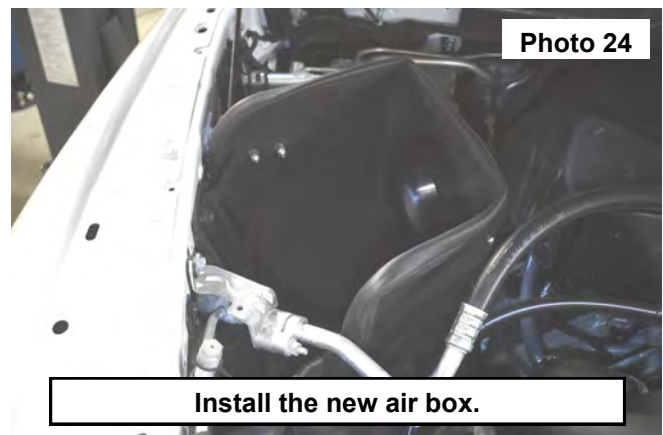
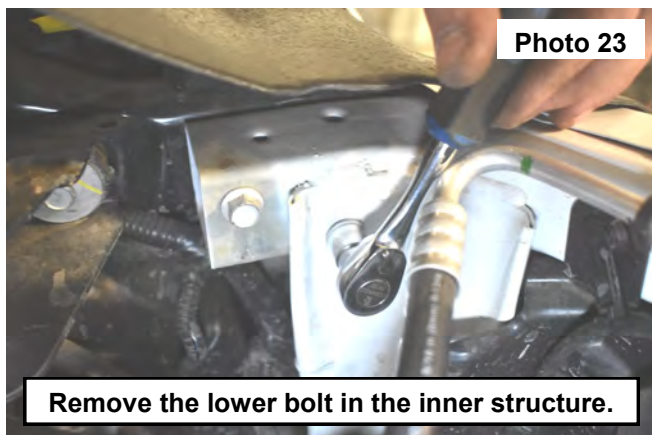

25. Install the retained bolts to secure the new air box into the vehicle. Tighten using a 13mm socket. **See Photos 25 and 26.**

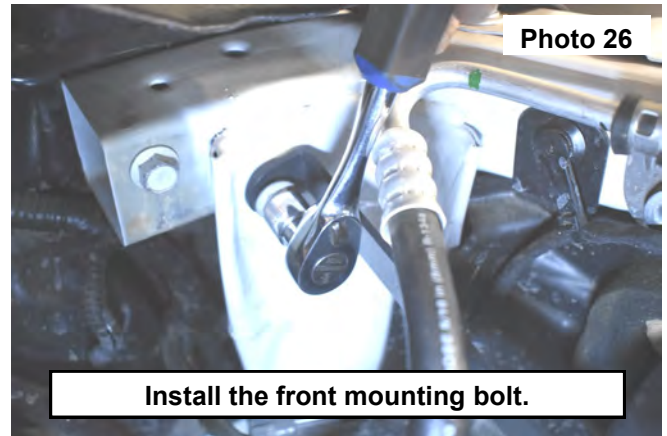
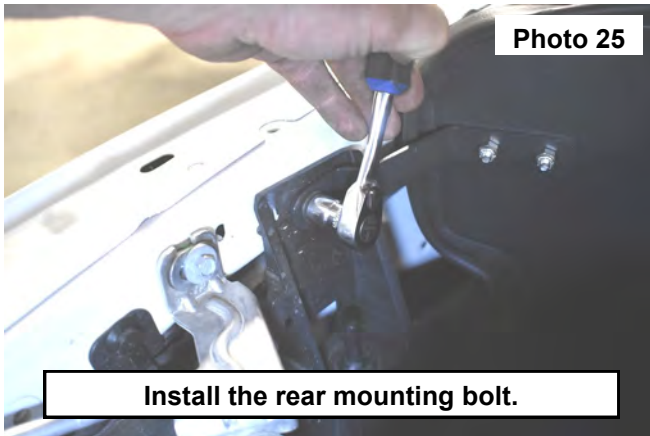

26. Install the intake coupler using the supplied clamp . Tighten using a 5/16 socket. **See Photo 27.**

27. Remove the sensor front the OE intake tube. Retain the sensor in a safe place. **See Photo 28.**

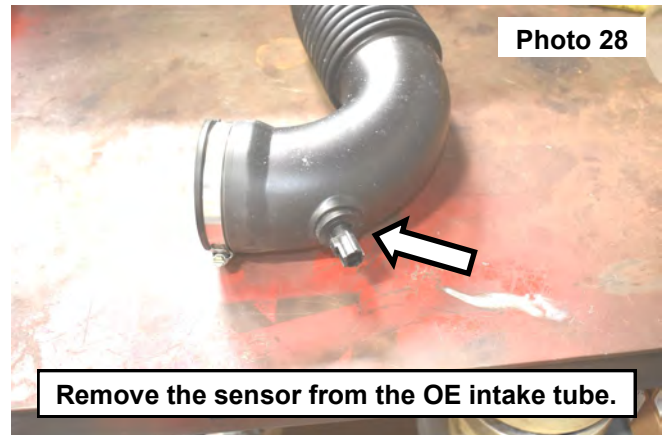

28. Install the rubber gromet into the new intake tube. **See Photo 29.**

29. Install the OE sensor into the intake tube/ gromet. A small amount of alcohol applied to the rubber gromet could make installation of the sensor easier. **See Photo 30.**

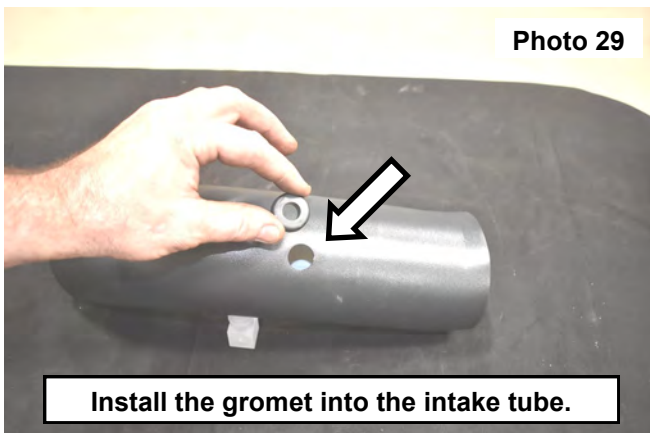

30. Install the supplied 5/8" barbed fitting into the intake tube. Tighten using a 3/4 wrench. **See Photo 31.**
 31. Install flex tube on the air filter adapter using the supplied clamp. Tighten clamp using a 5/16 socket. **See Photo 32.**

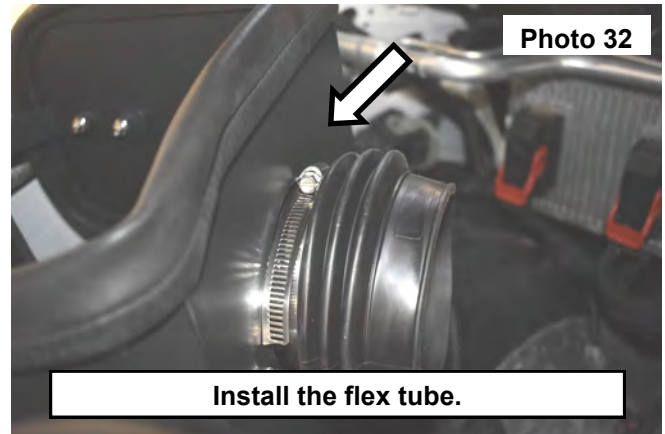
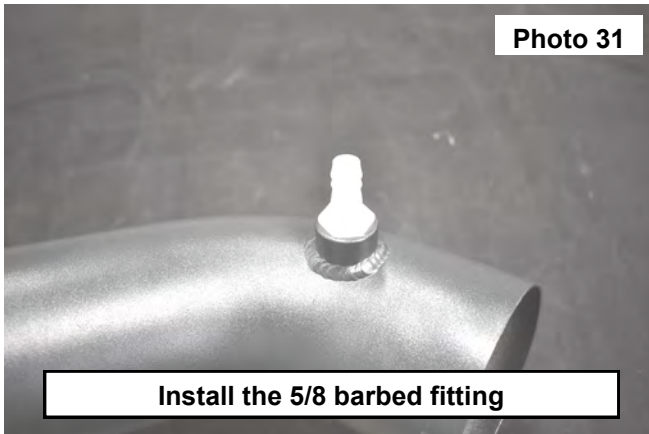

32. Install clamps on each end of the intake tube. Then install the intake tube into the air filter's flex tube and the intake coupler. Slide the clamps over the flanges of the coupler and flex tube and tighten using a 5/16 socket. **See Photo 33.**
 33. Place the large clamp onto the air filter. Then install the air filter onto the filter adapter flange. Securely tighten the clamp using a 5/16 socket. **See Photo 34.**

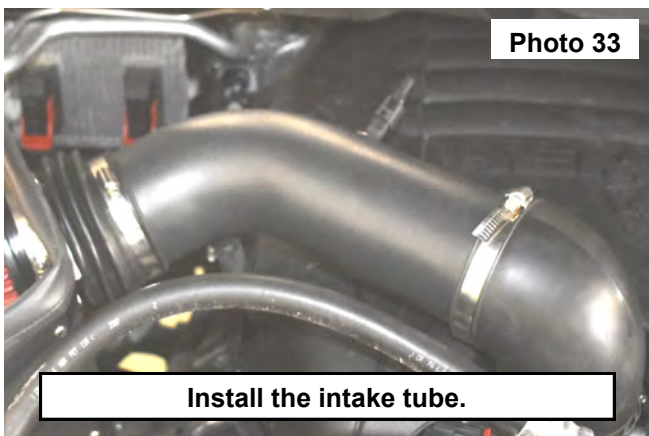

34. The manufacturer has two plugs options for the temp sensor. Extensions are included in this kit to accommodate both plug options. Identify the plug needed for your specific vehicle and install the wire extension onto the sensor, routing the wire under the intake tube to the OE wiring harness on the vehicle. **See Photo 35.**
 35. Connect the vent tube onto the barbed fitting and secure using a supplied hose clamp. Tighten using a 5/16 socket. **See Photo 36. Note: If the hose kinks, use the supplied 90 degree barbed fitting.**

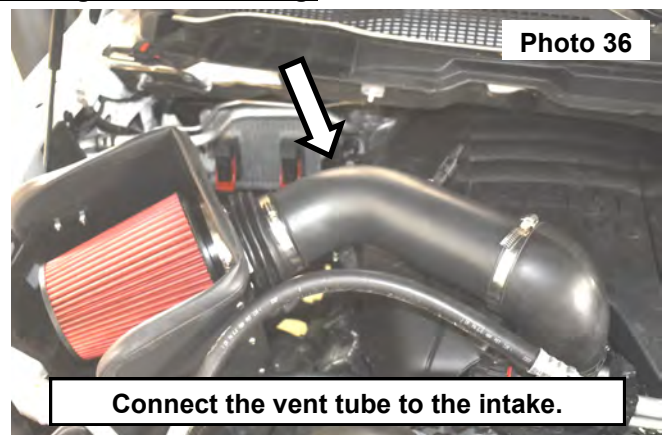
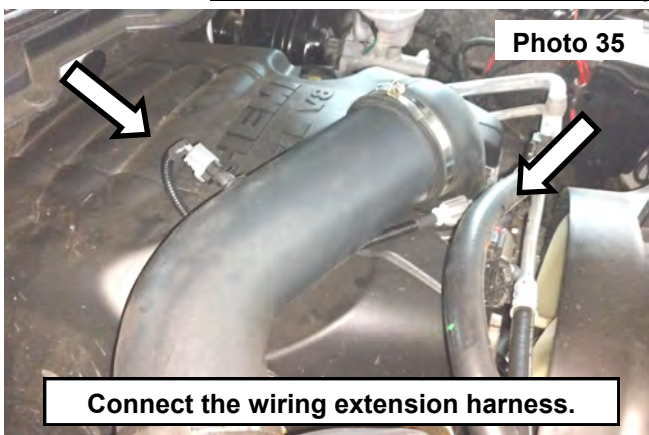

By purchasing any item sold by Rough Country, LLC, the buyer expressly warrants that he/she is in compliance with all applicable, State, and Local laws and regulations regarding the purchase, ownership, and use of the item. It shall be the buyers responsibility to comply with all Federal, State and Local laws governing the sales of any items listed, illustrated or sold. The buyer expressly agrees to indemnify and hold harmless Rough Country, LLC for all claims resulting directly or indirectly from the purchase, ownership, or use of the items.

