



INSTALLATION INSTRUCTIONS WINCH MOUNTING KIT

Part Number: 90125

Application: 2009 - 2012 Ford F150

Your safety, and the safety of others, is very important. To help you make informed decisions about safety, we have provided installation and operating instructions and other information on labels and in this guide. This information alerts you to potential hazards that could hurt you or others. It is not possible to warn you about all potential hazards associated with this product, you must use your own good judgment.

CARELESS INSTALLATION AND OPERATION CAN RESULT IN SERIOUS INJURY OR EQUIPMENT DAMAGE. READ AND UNDERSTAND ALL SAFETY PRECAUTIONS AND OPERATING INSTRUCTIONS BEFORE INSTALLING AND OPERATING THIS PRODUCT.

This guide identifies potential hazards and has important safety messages that help you and others avoid personal injury or death. WARNING and CAUTION are signal words that identify the level of hazard. These signal words mean:

⚠ WARNING signals a hazard that could cause serious injury or death, if you do not follow recommendations.

⚠ CAUTION signals a hazard that may cause minor to moderate injury, if you do not follow recommendations.

This guide uses **NOTICE** to call attention to important mechanical information, and Note: to emphasize general information worthy of special attention.

⚠ WARNING

Failure to observe these instructions could lead to severe injury or death.

- Always** use extreme caution when drilling on any vehicle. Make sure that all fuel lines, brake lines, electrical wires, and other objects are not punctured or damaged when/if drilling on the vehicle. Thoroughly inspect the area to be drilled (on both sides of material) prior to drilling, and relocate any objects that may be damaged. Failure to inspect the area to be drilled may result in vehicle damage, electrical shock, fire or personal injury.
- Always** wear safety glasses when installing this kit. A drilling operation will cause flying metal chips. Flying chips can cause eye injury.
- Always** use extreme caution when cutting and trimming during fitting.
- Always** remove jewelry and wear eye protection.
- Always** use appropriate and adequate care in lifting components into place.
- Always** insure components will remain secure during installation and operation.
- Always** tighten all nuts and bolts securely, per the installation instructions.

NOTICE

AVOID EQUIPMENT DAMAGE

- Never** use the tow hooks as an anchor point when double lining a winch.
- Never** use the mounting kit as an anchor point when double lining a winch.

NOTES

This kit is designed for installation on vehicles equipped with factory tow loops. Vehicles equipped with factory tow loops have front valances that are shaped to allow easy installation of mounting kit brackets. If this kit is to be installed on a vehicle not equipped with factory tow loops, significant trimming of the plastic valance may be required. That specific trimming information is not supplied here.

I. EXPLODED VIEW DIAGRAM

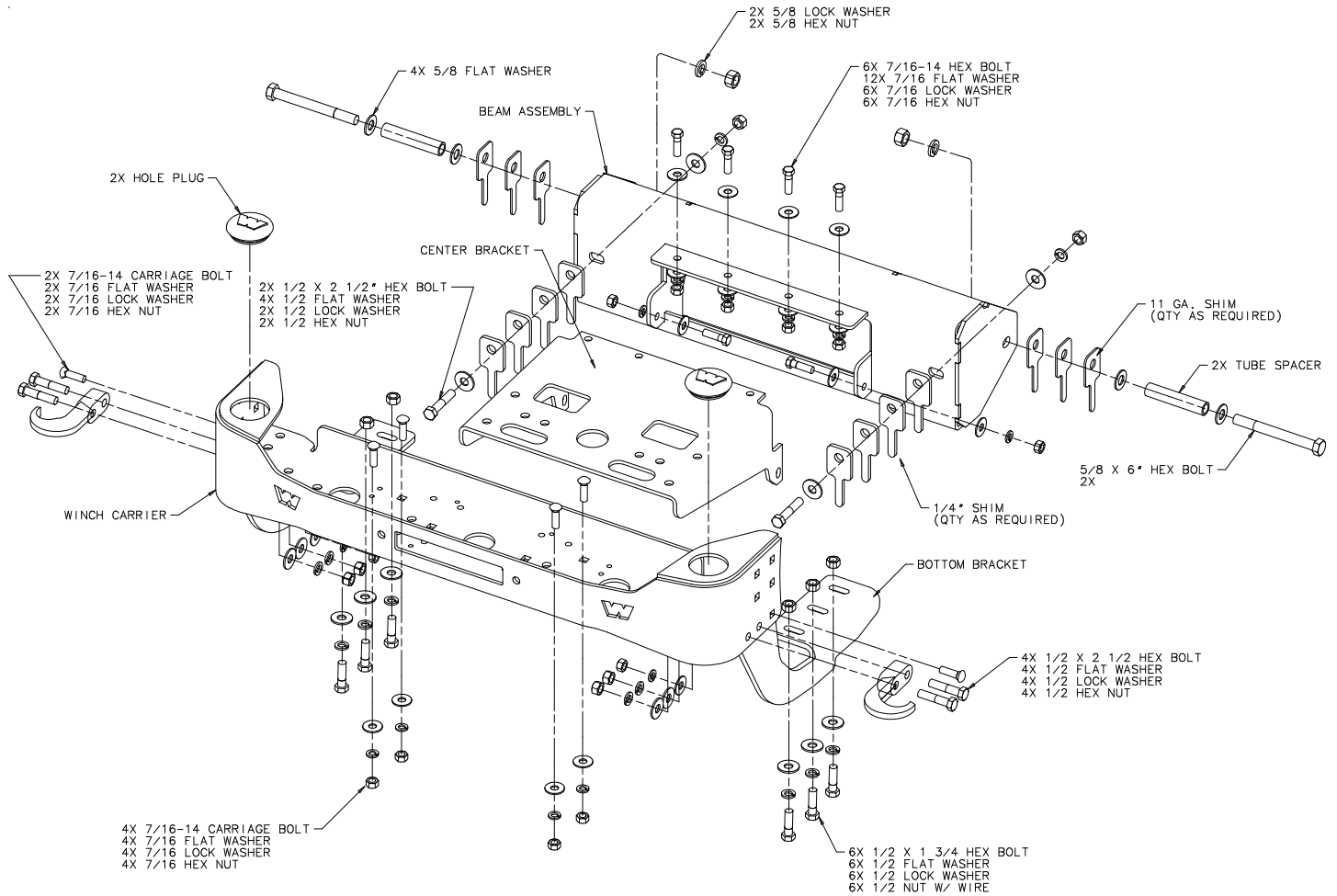

Figure 1



Figure 1a 2010 Ford F150 equipped with Air Dam.

II. PARTS LIST:

| <u>Part Number</u> | <u>Qty</u> | <u>Description</u> |
|--------------------|------------|------------------------|
| 79917 | 1 | Beam-Assembly_F150 |
| 79907 | 1 | Bottom Bracket RH |
| 79908 | 1 | Bottom Bracket LH |
| 80137 | 1 | Center Bracket F150 |
| 80441 | 8 | 11 GA. Shim |
| 80442 | 8 | 1/4" Shim |
| 87088 | 1 | Center Bracket RH F150 |
| 79913 | 2 | Tube Spacer |

III. TOOLS REQUIRED:

| | | | |
|------------------|---------------|---------------|-------------------------|
| 5/8" Socket | 3/4" Socket | 15/16" Socket | 3/8" Ratchet |
| 11/16" wrench | 3/4" Wrench | 15/16" Wrench | 6" Extension 3/8" Drive |
| Diagonal Cutters | Screw drivers | Pliers | |

IV. TORQUE SPECIFICATIONS:

| | |
|----------------------------|---------------------------|
| 3/8 30 lb. ft. (40.7 N-m) | 7/16 50lb. ft. (67.8 N-m) |
| 1/2 75 lb. ft. (101.7 N-m) | 5/8 90 lb. ft (122.0 N-m) |

V. INSTALLATION:

Bumper Removal and Installation.

1. Disconnect fog lamp wiring if applicable.
2. Disconnect rubber air deflector at bumper (5ea Christmas tree fasteners) See figure 2.



Figure 2: Rubber Air Deflector

3. Remove factory tow loops (2 bolts per side) . Discard the tow loops and hardware.
- 3a. Remove factory Air Dam if vehicle is equipped with one. (One bolt per side.) (**See Figure 1a**).
- 3b. Use a flat blade screwdriver to pry or tap the metal inserts out of each hole of the Air Dam.

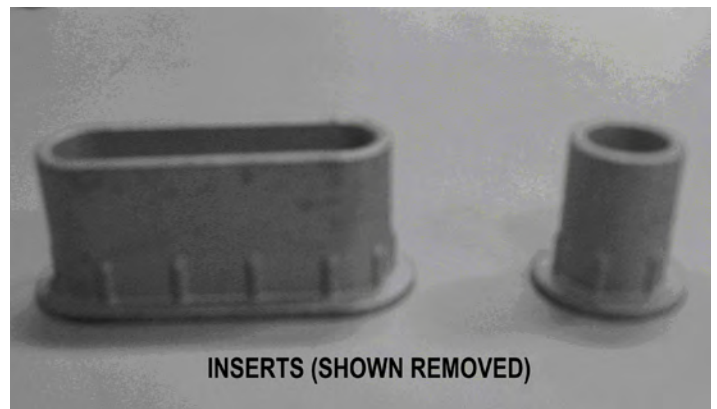
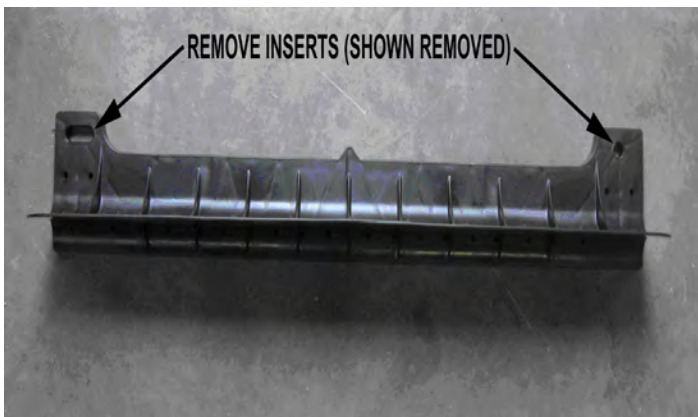

INSTALLATION CONT.

4. Remove bumper. 2 nuts per side from back (1 ea inboard and 1 ea outboard per side).
5. Remove mounting plates from back of bumper (4 bolts per side).



Figure 3. Mounting plate Removal

6. Remove inboard stud from left and right bumper brackets by tapping out with hammer.



Figure 4. Stud Removal

7. Reassemble and install bumper brackets and mounting plates on to bumper
8. Reinstall bumper. Bolts will be installed through the inboard bumper bracket mounting holes later.
9. Install the left and right bottom brackets. Refer to the illustration for identification. Insert a 1/2" nut with 14" wire "handle" into each frame rail. Install one 1/2 x 1 3/4" bolt with flat and lock washers through the rear hole in each bracket, into the appropriate frame hole and into the nut. **If your vehicle is equipped with a factory Air Dam (See Figure 1a) use the 1/2 x 2 1/2" bolts and flat washers (in separate plastic bag) and lock washers instead of the 1/2 x 1 3/4" bolts.** Do not tighten yet. Make sure the brackets are on the correct side.

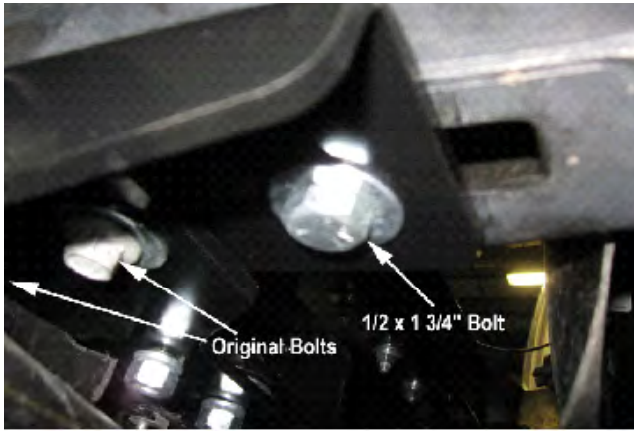

Figure 5. Bottom Bracket Fasteners.

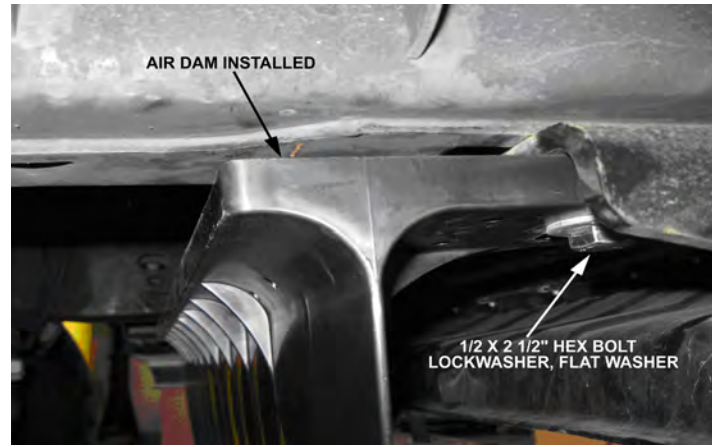

Figure 5a. Air Dam installed.

10. Install the 1/2 x 1 3/4" bolts through the front two bottom bracket and frame holes. Add a lock washer and flat washer under the head of each bolt before installation. Install nut assemblies (short wires) onto bolts. Do not tighten yet. Trim excess wire of nut assemblies.
11. Slide the beam assembly into position between the frame rails from underneath the vehicle. Refer to the illustration for correct orientation.
12. Insert a 5/8 x 6" bolt, flat washer and tube spacer through the 1" frame holes in each side. Install a flat washer over each bolt before inserting into the beam assembly holes. 11ga and 1/4:" shim plates are provided and should be installed over the bolts, between the frame rails and the beam assembly. The beam should be centered between the frame rails. Install a 5/8" flat washer, lock washer and hex nut on each bolt. Do not tighten yet.



Figure 6. Shim Placement.

13. Install a 1/2 x 2 1/2" bolt and flat washer through the bumper bracket mounting holes left when the original studs were removed.

14. Install the necessary shims of either thickness to fill the gap between the beam assembly and bumper bracket. Install ½” flat washers, lock washers and hex nuts on the bolts.
15. Install the center bracket above the beam gusset and outboard of the tabs. Install 7/16 x 1 1/2” bolts and flat washers through each hole (4 across the top, 1 in each side). The side bolts need to be installed from the inside. Install 7/16 flat washers, lock washers and hex nuts on each bolt. Tighten hardware

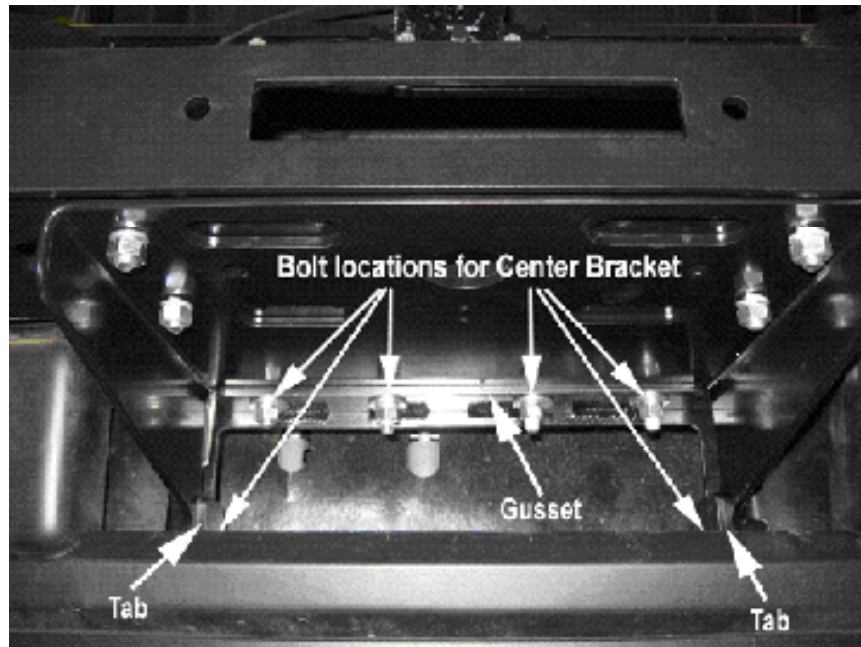

Figure 7. Center Bracket Fasteners.

16. Place the winch carrier on top of the center bracket and over the bottom brackets. Install 4ea 7/16 x 1.5” carriage bolts (button head bolts for stainless kits) through the carrier into the center bracket. Install flat washers, lock washers and hex nuts on each bolt.
17. Install 7/16 x 1.5” carriage bolts (hex head bolts and stainless flat washers for stainless kits) through the lower rear carrier holes into the rear bottom bracket holes. Install a flat washer, lock washer and hex nut on each bolt.
18. Install two ½ x 2 1/2” bolts through each of the tow hooks provided. Insert into the lower forward holes in the carrier and bottom brackets. Install flat washers, lock washers and hex nuts on each.



Figure 8. Tow Hook Installation.

19. Tighten all hardware starting at the carrier and working towards the vehicle frame. **IMPORTANT! Do NOT torque or overtighten the 1/2" x 2 1/2" bolts attaching the Air Dam. The bolts should never deform or flatten the plastic Air Dam.**
20. Remove the christmas tree fasteners from the rubber air deflector and reinstall them from the othe side of the rubber air deflector. Reinstall
20. Reconnect the fog lamp wiring and reattach the rubber air deflector to the back of the bumper. It may not be possible to attach the outer most christmas tree fasteners.
21. If a Grille Guard Tube is not being installed install the rubber plugs in the 2" carrier holes.
22. The kit is now ready for winch or other accessory installation.

VI. MAINTENANCE/CARE

Warn Industries Stainless Steel Truck Accessories

What to expect:

Polished stainless steel combines the beauty of a chrome-like appearance with extreme durability and corrosion resistance. With a minimum amount of care, the appearance will last almost indefinitely. Unlike plating or coatings, there is nothing to peel off or wear away that would allow corrosion underneath.

The actual appearance may not be exactly like new chrome in either the degree of luster or color. There may be fine polishing lines visible up close and small differences between mating parts of an assembly. A grille guard, for instance, may have small differences between the round tubing and the flat plate. The backside of a part may not be as highly polished as the front. However, part of the beauty and appeal of stainless actually lies in the smooth “hand-worked” appearance.

There also is a possibility that small rust spots can appear on stainless products. They are usually due to minor iron contamination on the surface as a result of normal manufacturing and handling processes. This minor rust, if it occurs at all, is easy to remove and will not tend to spread.

Recommended care:

Regular washing with fresh water and mild car wash detergents followed by rinsing and drying with a soft towel is the best minimum care. Beyond that, any cleaner/wax recommended for automotive finishes will work well to remove minor stains and scuffs, enhance the shine and provide protection. Always use clean soft cotton cloths. In most cases, this will be all that is required for many years. For more serious blemishes or a rust spot, use a cream metal polish recommended for stainless, aluminum, etc. Try to rub in the direction of the original polishing lines.

Ultimately, any stainless part can be restored to a brilliant shine with power buffing processes.

Caution:

Do not use steel wool or any type of metal scraper. Do not use “Scotch Brite” pads or abrasive powdered cleaners. Do not try to clean with muriatic acid or any other acid.

Stainless Fasteners

Stainless steel fasteners are included in many of the stainless kits. These fasteners provide similar corrosion resistance and appearance as the rest of the kit. However, stainless fasteners are prone to galling when installed in similar stainless material. It is a good idea to apply a small amount of anti-seize compound to the threads when installing them. Care should also be taken when tightening the fasteners to prevent rounding or deforming the corners of the bolts. Make sure the wrenches are the correct size and fit properly. In the case of socket heads, the wrench should have sharp, un-worn edges. With a few precautions during assembly the products should provide years of service.

© 2009 Copyright Warn Industries, Inc. All rights reserved.

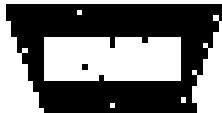

WARN® & TY/ UTILITY/ MOUNTING SYSTEM/ ACCESSORY PRODUCTS

UNITED ONE (1) YEAR WARRANTY STATEMENT

Warn Industries, Inc. (WARN) warrants the original purchaser that the mechanical components and electrical components of the WARN® Utility/ Mounting System will be free of defects in material and workmanship for a period of one (1) year from the original date of purchase. This warranty applies only to the original purchaser of the Products. In addition, warranty coverage for second purchaser WARN® Utility/ Mounting System will be provided for a period of one (1) year from the date of purchase of the original purchaser except that WARN® will, at its option, repair, replace or refund the purchase price of a defective Product or component, provided you return the defective Product or component during the warranty period, to Warn Industries, Inc. or its authorized representative as a Factory Authorized Service Center. All such repairs, replacements, or refunds will be made at the discretion of Warn Industries, Inc. and a copy of your receipt and original bill of sale bearing the WARN® serial number will be returned with the defective Product or defective component.

This warranty does not apply to (a) failure to use products in accordance with the instructions, or (b) if the Product has been damaged by accident, abuse, misuse, collision, overloading, modification, or application, improper installation, or improper use. This warranty is void if any WARN® serial number has been removed or defaced. Commercial or industrial use or application, or any loading application of the Product voids this warranty.

THE WARRANTY SET FORTH ABOVE IS THE ONLY WARRANTY. THERE ARE NO OTHER WARRANTIES, EXPRESS OR IMPLIED, INCLUDING BUT NOT LIMITED TO IMPLIED WARRANTIES OF MERCHANTABILITY OR FITNESS FOR A PARTICULAR PURPOSE.

ANY IMPLIED WARRANTY WHICH MAY BE EXCLUDED IS LIMITED IN EXTENT TO ONE (1) YEAR FROM THE DATE OF ORIGINAL INSTALLATION OF THE PRODUCT.

WARN SHALL NOT BE LIABLE FOR SPECIAL, INCIDENTAL, CONSEQUENTIAL DAMAGES (INCLUDING, BUT NOT LIMITED TO, LOSS OF PROFITS, DOWN TIME OR LOSS OF USE) UNDER ANY LEGAL THEORY, EVEN IF WARN HAS ADVISED OF THE POSSIBILITY OF SUCH DAMAGES.

We warrant and affirm the usefulness of our products as the manufacturer intended at the time of sale. We warrant and affirm that our products will meet the use for which you purchased them, but we do not warrant or affirm any and apply to you. This warranty gives you specific legal rights. You may also have other rights that vary from state to state.

WARN reserves the right to change Product design or specifications. In a limited circumstance, WARN has, during a Product design, WARN shall have a legal obligation to advise you in a timely manner in a written form of the change.

The WARN dealer, a qualified repair person or Warn representative, may, at its discretion, void this warranty.

Warranty components and Products are covered by warranty coverage shown below:

WARN INDUSTRIES, INC.

Customer Service Department

ONE DE Copper Creek

Clinton, MO 64601

(800) 421-7762 / (816) 221-4076

FAX 816-221-4076 / www.warn.com

Components and Products Covered:

- 1" Warn® Utility/ Mounting System
- Utility/ Mounting System
- Warn® Utility/ Mounting System, Components, Electrical Components
- 1" Utility/ Mounting System, Components
- 1" Components
- 1" Components
- 1" Utility/ Mounting System, Components

Components and Products Covered:

- Warn® Utility/ Mounting System 1" Utility/ Mounting System
- Warn® Utility/ Mounting System, Components, Electrical Components
- Warn® Utility/ Mounting System, Components
- Warn® Components
- Warn® Utility/ Mounting System, Components
- Warn® Utility/ Mounting System, Components
- Warn® Utility/ Mounting System, Components